

STATE OF OKLAHOMA  
DEPARTMENT OF HIGHWAYS  
PLANS AND SURVEY DEPARTMENT

FLOOD INFORMATION FORM

To be used in obtaining and transmitting flood water elevations for Plans & Survey office record files. This information to be obtained by all Chiefs of Party in their vicinity in times of unusual high water, or at any time available from a reliable source. The elevations can be recorded by level reading, by measurement from bridge floor, in relation to a house, above roadbed or any other dependable, clear manner that fits the situation, the highest order possible to be used. Separate report to be made on each crossing or place obtained.

County JEFFERSON Date highwater occurred May 18-19, 1951

Highway number U.S. 70 Name of stream Beaver Creek

Direction and distance from nearest town, village or store In Waurika  
at the South Edge of Town on U.S. 70

Section, Township and Range Sec 35 - T44N - R8W

Description of Location At Sta 408+35.08 FAP 444.8

Method obtained Wye Level

Elevation East End of Br. Floor Source of levels FAP 444.8  
*HW Elev = 877.7*  
*H.W. Was 5.3 Lower than Extreme*

Was highwater mark obtained from actual water, drift, local resident, U. S. Engineers, etc? From actual H.W. Mark on Shack  
Res. Just East & North of Bridge. Also drift.

Explanatory Remarks Obtained with a wye level by  
A. B. Stephens and Ray Flowers

Location to be shown on back of this sheet as a check.

Field Note: To be sent to Engr.  
of Plans & Survey (1 copy).  
Office Note: To be filed in Flood  
Information by Counties.

A. B. Stephens  
Chief of Party  
Res Engineer  
May 23, 1951  
Date

NOTE: SEE NO 2  
ATTACHED MAP.  
FOR LOCATION

100,000 FEET

20,000 FEET

TO TEMPLE  
TO RANDOLPH

R9W R8W R7W

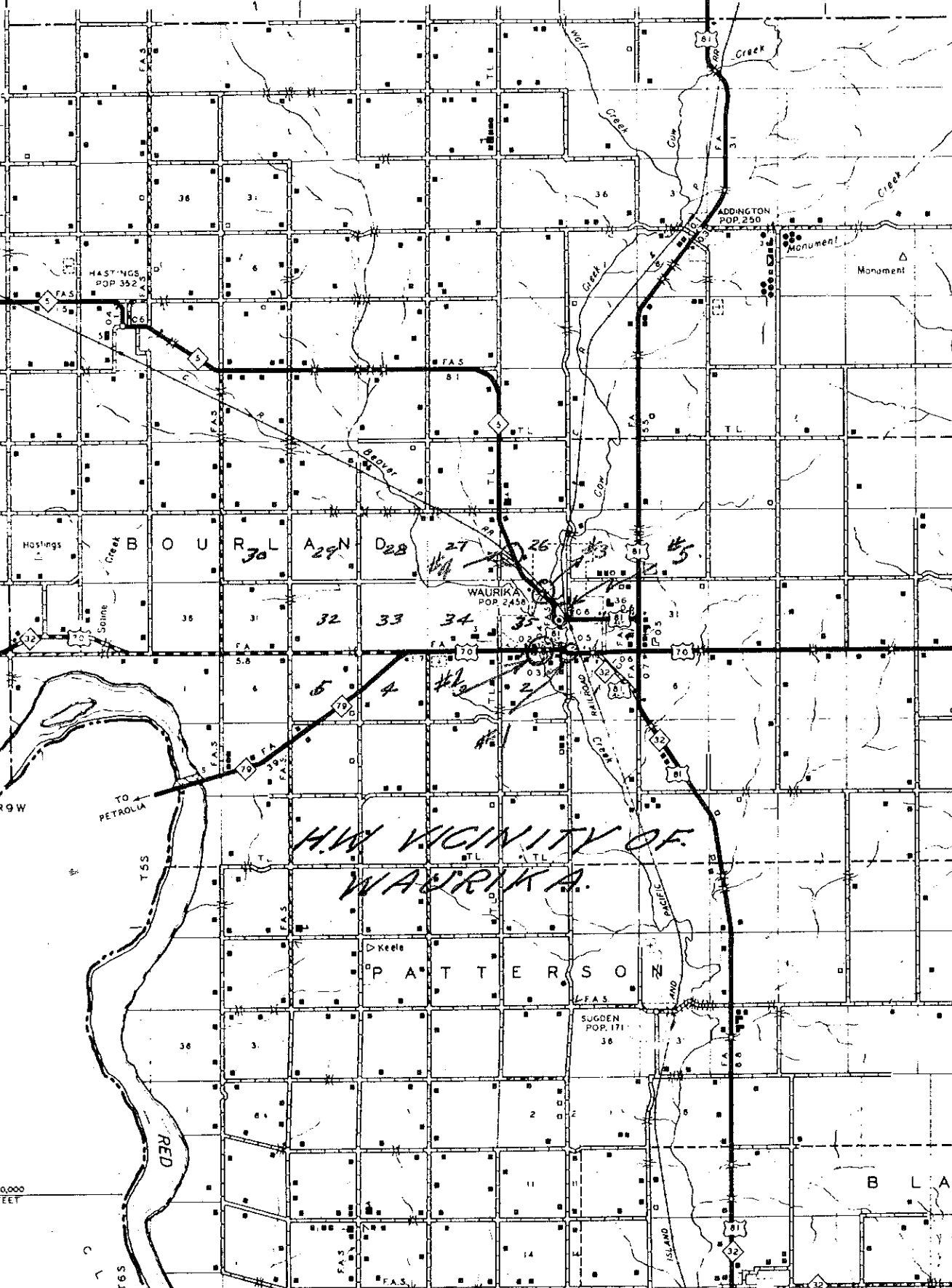

H.W. VICINITY OF WAURIKA

PATTERSON

SUGGEN POP. 171

RED

260,000 FEET

BLAC