

STATE OF OKLAHOMA  
DEPARTMENT OF HIGHWAYS  
SURVEY DIVISION  
FLOOD INFORMATION FORM

Survey Division  
Form No. 16  
Rev. Sept. 10, 1961

To be used in obtaining and transmitting flood water elevations for Survey Division office record files. This information to be obtained by all Chiefs of Party or others in their vicinity in times of unusual high water, or at any time available from a reliable source. The elevations can be recorded by level reading, by measurement from bridge floor, in relation to a house, above roadbed or any other dependable, clear manner that fits the situation, the highest order possible to be used. Separate report to be made on each crossing or place obtained.

County Jefferson Date highwater occurred April 12, 1967

Highway number US 70 Name of stream Beaver Creek

Direction and distance from nearest town, village or store Approx. 1.6 miles west of the intersection of US 70 and US 81 in Waurika, Oklahoma. At the Beaver Creek overflow bridge on US 70.

Section, Township and Range Between section 35, T4S, R8W and section 2, T5S, R8W.

Description of Location Down 16.5 feet from the east end of the bridge floor.

Elevation \_\_\_\_\_ Source of levels \_\_\_\_\_

Method obtained Tape Date obtained April 14, 1967

Did it appear to be  normal  medium  extreme  do not know

Was highwater mark obtained from actual water, drift, local resident, U. S. Engineers, etc.? Drifts and Water Marks.

SURVEY DIVISION	
GHS	
WNV	5-9-67
WNM	5-9-67
GWP	
OCC	
GER	
SDD	
IDW	
DP	
BM	
CB	

Explanatory Remarks \_\_\_\_\_

Location to be shown on back of this sheet as a check.

Field Note: To be sent to  
Survey Engineer

Chief of Party  
Location Engineer  
April 17, 1967  
Date

R8W S45

R7W

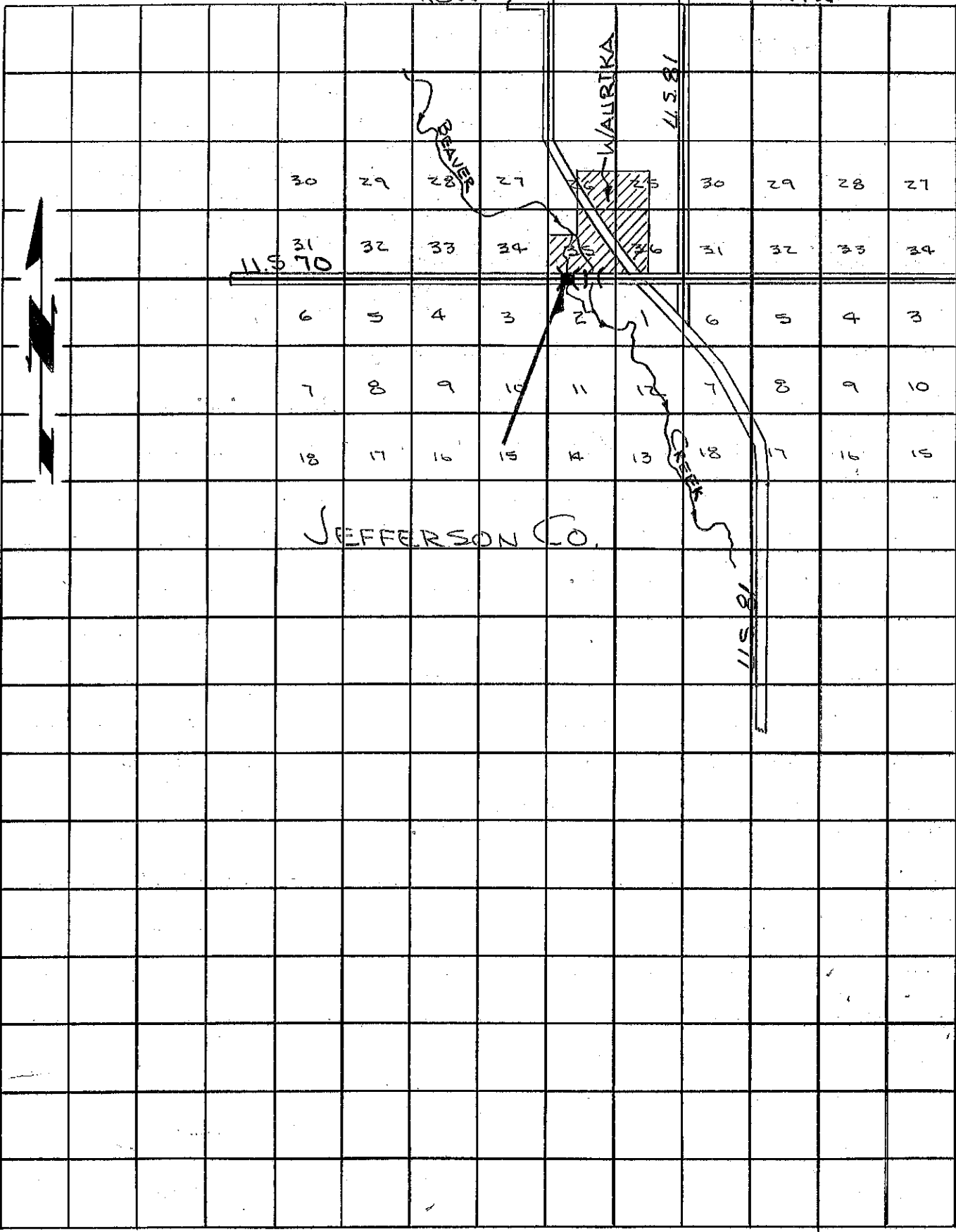

30	29	28	27	26	25	30	29	28	27
----	----	----	----	----	----	----	----	----	----

115.70

6	5	4	3	2	1	6	5	4	3
---	---	---	---	---	---	---	---	---	---

7	8	9	10	11	12	7	8	9	10
---	---	---	----	----	----	---	---	---	----

18	17	16	15	14	13	18	17	16	15
----	----	----	----	----	----	----	----	----	----

JEFFERSON CO.

115.81

T4S

T5S

