

RECEIVED
MAY 9 1967
SURVEY DIVISION

STATE OF OKLAHOMA
DEPARTMENT OF HIGHWAYS
SURVEY DIVISION

Survey Division
Form No. 16
Rev. Sept. 10, 1961

FLOOD INFORMATION FORM

To be used in obtaining and transmitting flood water elevations for Survey Division office record files. This information to be obtained by all Chiefs of Party or others in their vicinity in times of unusual high water, or at any time available from a reliable source. The elevations can be recorded by level reading, by measurement from bridge floor, in relation to a house, above roadbed or any other dependable, clear manner that fits the situation, the highest order possible to be used. Separate report to be made on each crossing or place obtained.

County Jefferson Date highwater occurred April 12, 1967

Highway number US 70 Name of stream West Mud Creek

Direction and distance from nearest town, village or store Approx. 14.7 miles west of the intersection of SH 89 and US 70 in Ringling, Oklahoma. At the West Mud Creek bridge on US 70.

Section, Township and Range Between section 31, T4S, R6W and section 6, T5S, R6W.

Description of Location Down 6.0 feet from the bridge floor.

Elevation _____ Source of levels _____

Method obtained _____ Tape _____ Date obtained April 14, 1967

Did it appear to be normal medium extreme do not know

Was highwater mark obtained from actual water, drift, local resident, U. S. Engineers, etc.? Drifts and Water Marks.

Explanatory Remarks _____

SURVEY DIVISION	
GHS	
WWV	5-9-67
WWM	5-9-67
GWP	
OCC	
GER	
SDD	
JDW	
DP	
BM	
CB	

Location to be shown on back of this sheet as a check.

Field Note: To be sent to
Survey Engineer



Location Engineer
April 17, 1967
Date

Location NO. ~~7~~ 8

R7W

R6W

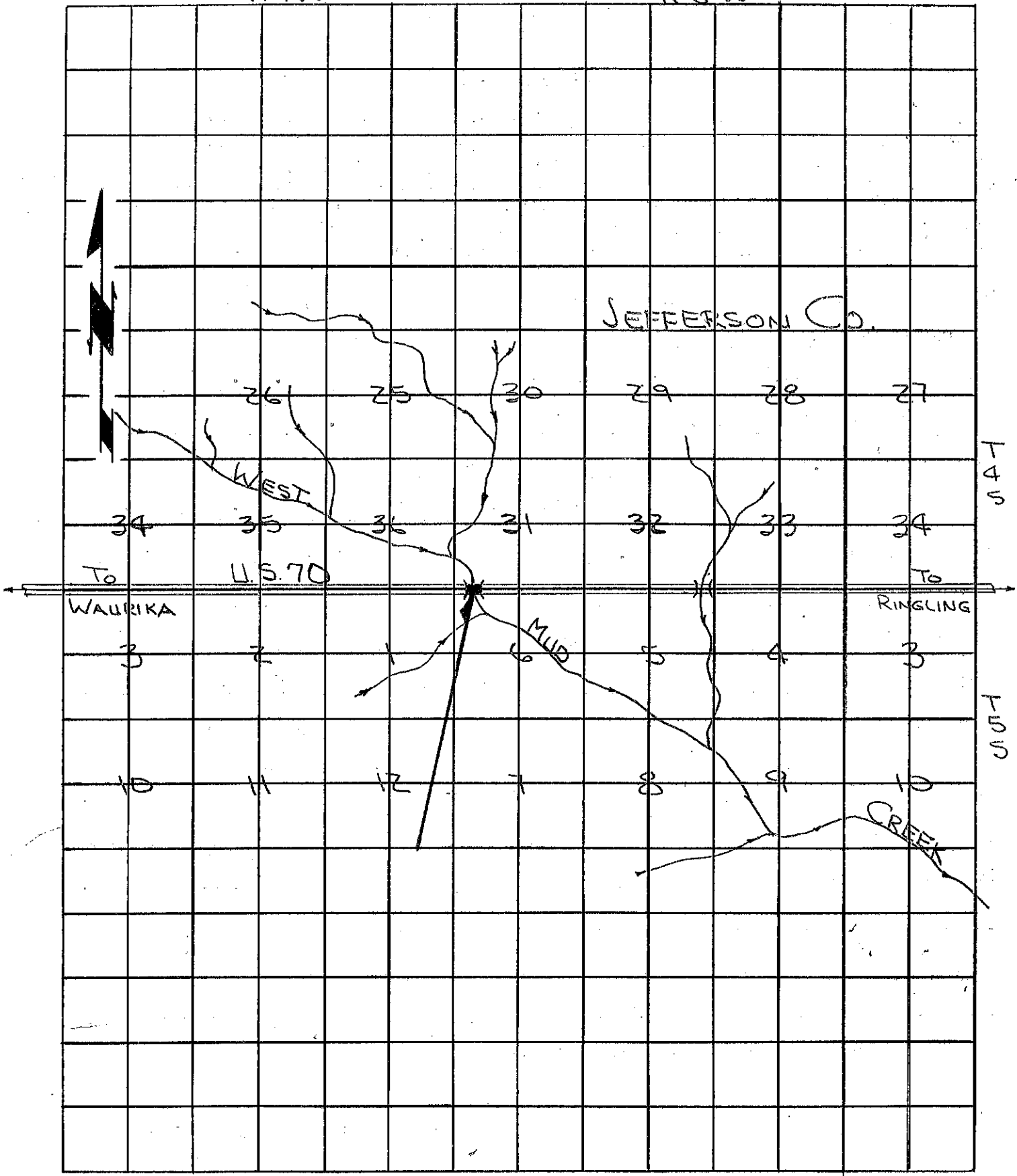
JEFFERSON CO.



T4S

T5S

To WAURIKA

To RINGLING

U.S. 70

WEST

MUD

CREEK

26 25 30 29 28 27

34 35 36 31 32 33 34

3 2 1 6 5 4 3

10 11 12 7 8 9 10