

RECEIVED
MAY 9 1967
SURVEY DIVISION

STATE OF OKLAHOMA
DEPARTMENT OF HIGHWAYS
SURVEY DIVISION
FLOOD INFORMATION FORM

Survey Division
Form No. 16
Rev. Sept. 10, 1961

To be used in obtaining and transmitting flood water elevations for Survey Division office record files. This information to be obtained by all Chiefs of Party or others in their vicinity in times of unusual high water, or at any time available from a reliable source. The elevations can be recorded by level reading, by measurement from bridge floor, in relation to a house, above roadbed or any other dependable, clear manner that fits the situation, the highest order possible to be used. Separate report to be made on each crossing or place obtained.

County Jefferson Date highwater occurred April 12, 1967

Highway number US 70 Name of stream _____

Direction and distance from nearest town, village or store Approx. 12.7 miles west of the intersection of SH 89 and US 70 in Ringling, Oklahoma. At a R.O.B. under US 70.

Section, Township and Range Between section 34, T4S, R6W and section 3, T5S, R6W.

Description of Location Down 3.5 feet from the T.O. of the box.

Elevation _____ Source of levels _____

Method obtained Tape Date obtained April 14, 1967

Did it appear to be normal medium extreme do not know

Was highwater mark obtained from actual water, drift, local resident, U. S. Engineers, etc.? Drifts and Water Marks

Explanatory Remarks _____

SURVEY DIVISION	
GHS	
WWW	5-9-67
WWM	5-9-67
GWP	
OCC	
GER	
SDD	
JDW	
DP	
BM	
CB	

Location to be shown on back of this sheet as a check.

Field Note: To be sent to Survey Engineer

J.P. [Signature]
Location Engineer
April 17, 1967
Date

Location No. 7

R6W

R5W

JEFFERSON CO.

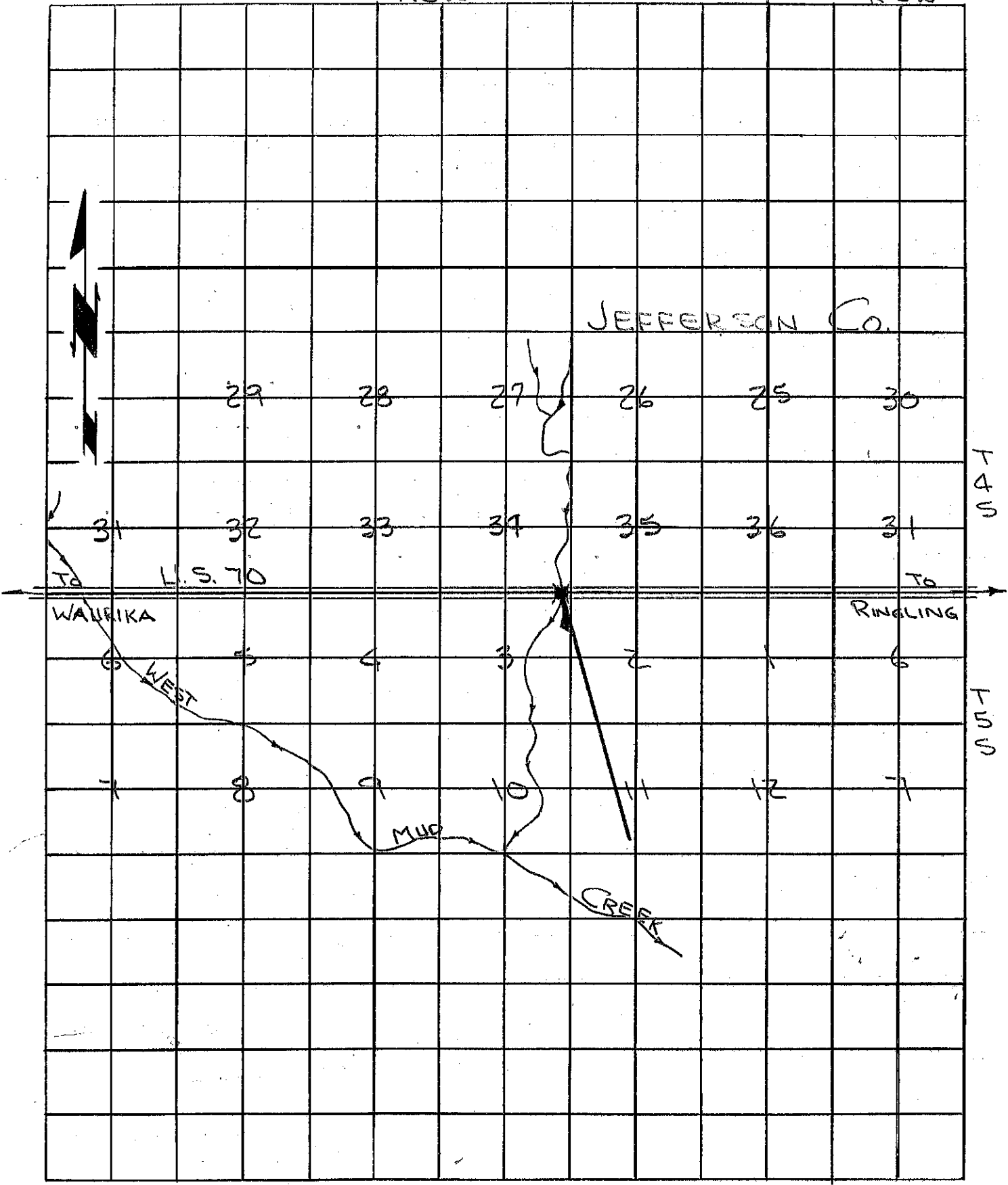

T 4 S

T 5 S

WARRIKA

U.S. 70

RINGLING

WEST

MUD

CREEK