

RECEIVED
 MAY 9 1967
 SURVEY DIVISION

STATE OF OKLAHOMA
 DEPARTMENT OF HIGHWAYS
 SURVEY DIVISION

Survey Division
 Form No. 16
 Rev. Sept. 10, 1961

FLOOD INFORMATION FORM

To be used in obtaining and transmitting flood water elevations for Survey Division office record files. This information to be obtained by all Chiefs of Party or others in their vicinity in times of unusual high water, or at any time available from a reliable source. The elevations can be recorded by level reading, by measurement from bridge floor, in relation to a house, above roadbed or any other dependable, clear manner that fits the situation, the highest order possible to be used. Separate report to be made on each crossing or place obtained.

County Jefferson Date highwater occurred April 12, 1967

Highway number US 70 Name of stream _____

Direction and distance from nearest town, village or store Approx. 4.1 miles west of the intersection of SH 89 and US 70 in Ringling, Oklahoma. At the overflow bridge approx. 1000' east of the Mud Creek bridge on US 70.

Section, Township and Range Between section 31, T4S, R4W and section 6, T5S, R4W.

Description of Location Down 8.0 feet from the bridge floor.

Elevation _____ Source of levels _____

Method obtained _____ Tape _____ Date obtained April 14, 1967

Did it appear to be normal medium extreme do not know

Was highwater mark obtained from actual water, drift, local residents, U. S. Engineers, etc.? Drifts and Water Marks.

Explanatory Remarks _____

SURVEY DIVISION	
GHS	
WVW	54.07
WNM	59.67
GWP	
OCC	
GER	
SDD	
JDW	
DP	
BW	
CB	

Location to be shown on back of this sheet as a check.

Field Note: To be sent to
 Survey Engineer

J.P. [Signature]
 Location Engineer
 April 17, 1967
 Date

LOCATION NO. 2

R5W

R4W

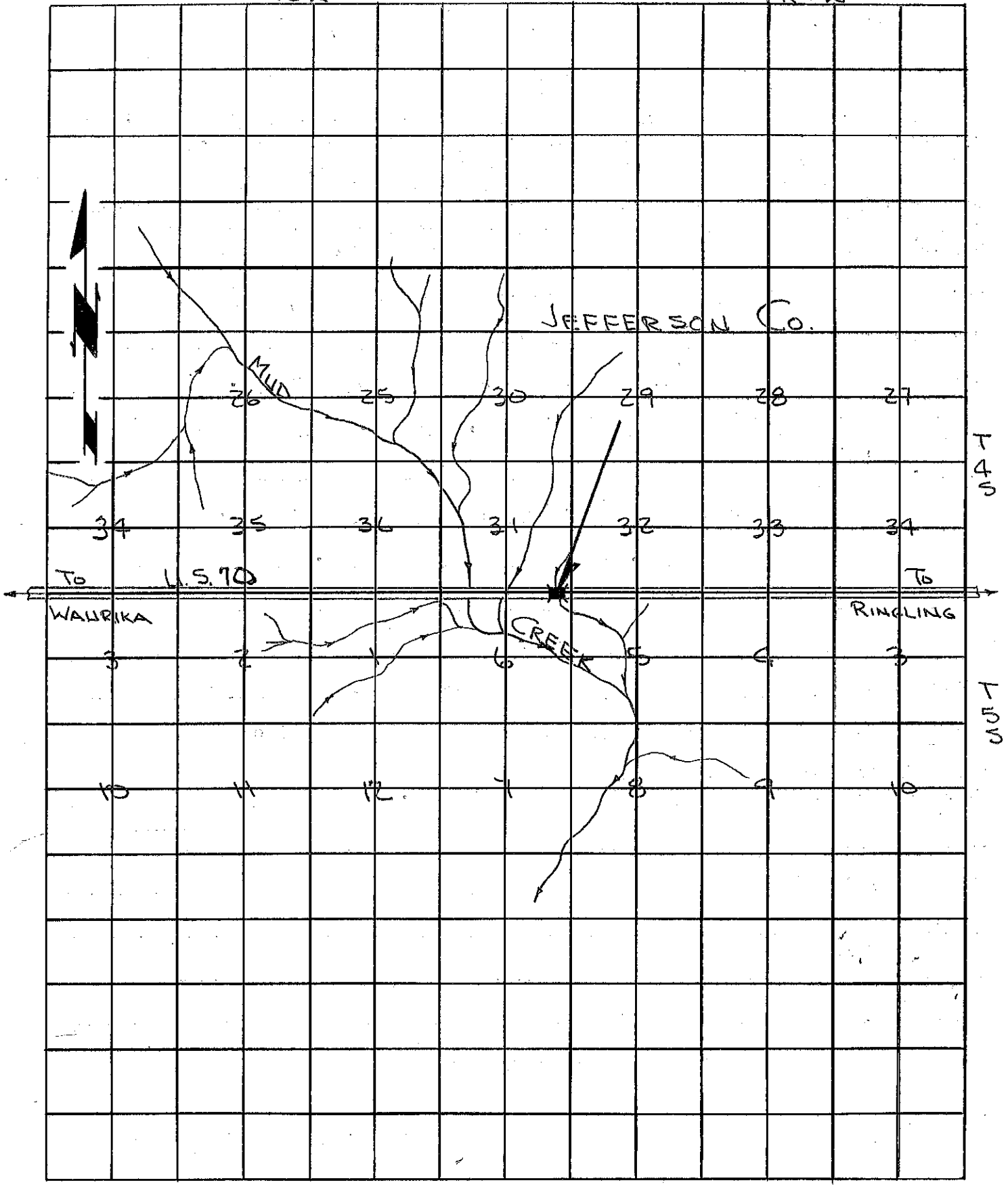

T
S
T
S