

STATE OF OKLAHOMA
DEPARTMENT OF HIGHWAYS
SURVEY DIVISION

Survey Division
Form No. 16
Rev. Sept. 10, 1961

RECEIVED

MAY 16 1969

FLOOD INFORMATION FORM

To be used in obtaining and transmitting flood water elevations for office record files. This information to be obtained by all Chiefs of Party or others in their vicinity in times of unusual high water, or at any time available from a reliable source. The elevations can be recorded by level reading, by measurement from bridge floor, in relation to a house, above roadbed or any other dependable, clear manner that fits the situation, the highest order possible to be used. Separate report to be made on each crossing or place obtained.

County Jefferson Date highwater occurred May 7, 1969

Highway number SH 5 Name of stream Overflow water from Beaver Creek

Direction and distance from nearest town, village or store Approx. 0.75 Mi NW of

Waurika, Oklahoma on SH 5.

Section, Township and Range Sec. 26 T4S R8W

Description of Location Approx. 800' south of the intersection of the CRI&P RR and SH 5, along SH 5.

Elevation Down 7.4 From top Rail Source of levels Top of Rail at Station

At CRI&P RR & SH 5 Crossing
Method obtained Engineers Level Date obtained May 9, 1969

Did it appear to be normal medium extreme do not know

Was highwater mark obtained from actual water, drift, local resident, U. S. Engineers, etc.? Water Marker

Explanatory Remarks USCGS Level Datum obtained from USCGS BM No. N 43 at Waurika

at CRI&P Railroad Station, in Concrete foundation, at east side of building, 21 feet

South of the Northeast Corner. Elevation = 880.57

Location to be shown on back of this sheet as a check.

Field Note: To be sent to
Survey Engineer

J. P. Andrews
J. P. Andrews - Location Engineer
Chief of Party

May 9, 1969

Date

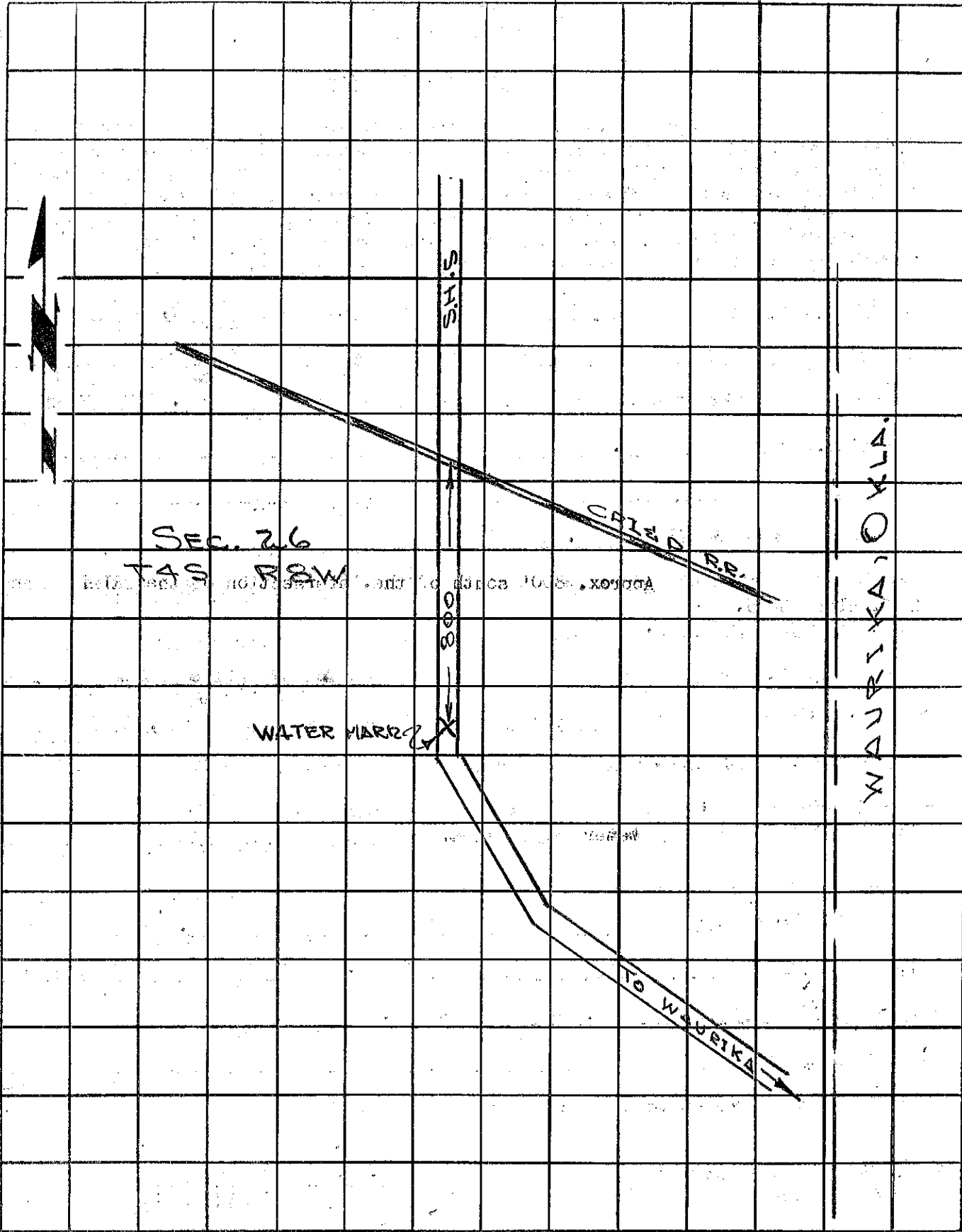

SEC. 26
TAS RSW

S.H.S.

800

WATER MARK

C.R. 12 D

WAUBIKA, OKLA.

TO WAUBIKA