



OKLAHOMA DEPARTMENT OF TRANSPORTATION  
SURVEY DIVISION

**FLOOD INFORMATION FORM**

<b>Division #:</b>	1 <input type="checkbox"/> 2 <input type="checkbox"/> 3 <input type="checkbox"/> 4 <input type="checkbox"/> 5 <input checked="" type="checkbox"/> 6 <input type="checkbox"/> 7 <input type="checkbox"/> 8 <input type="checkbox"/>
<b>County:</b>	Jackson
<b>Date Highwater occurred:</b>	10/8/2018
<b>Highway Number:</b>	US 62
<b>Name of Stream:</b>	N/A
<b>Direction and distance from nearest town, or highway junction</b>	7 Miles East of Jct. US 62 & U.S. 283
<b>Section, Township, Range:</b>	Section 16 T 2 N , R 19 W
<b>Description of Location:</b>	Intersection of S.H. 6 & CR S211 with Cultivation and grass lined bar ditches.
<b>Latitude</b>	34^38'16.78" N
<b>Longitude</b>	99^12'44.50" W
<b>Highwater Elevation:</b>	1324 Ft. or Approximately 1 ft. above road.
<b>Level Datum &amp; Source:</b>	NAVD88 (Computer using GEOID12B)
<b>Method used:</b>	OPUS-RS Solution Utilizing RTK
<b>Date Elevation Obtained:</b>	10/22/2018
<b>Apparent Magnitude:</b>	Normal <input type="checkbox"/> Medium <input checked="" type="checkbox"/> Extreme <input type="checkbox"/> Unknown <input type="checkbox"/>
<b>Was Highwater Mark obtained from actual water, drift, local resident, or other source?</b>	Highwater was obtained from actual drift line.
<b>Explanatory Remarks:</b>	None.

Name (Signature) \_\_\_\_\_

Name (Printed) Lawton Crew

Date 10/22/2018

Note: Show Vicinity Map on back of form

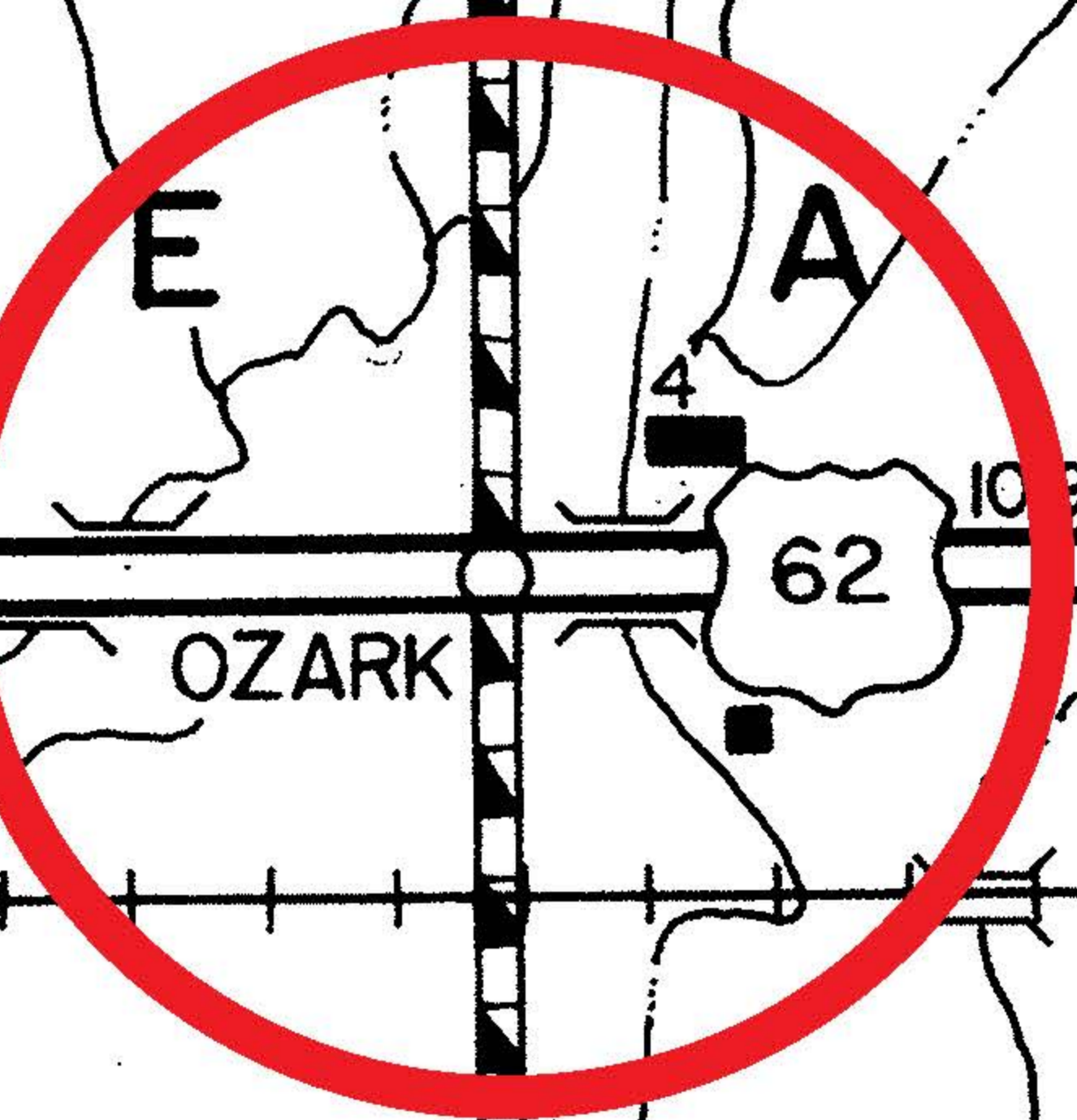
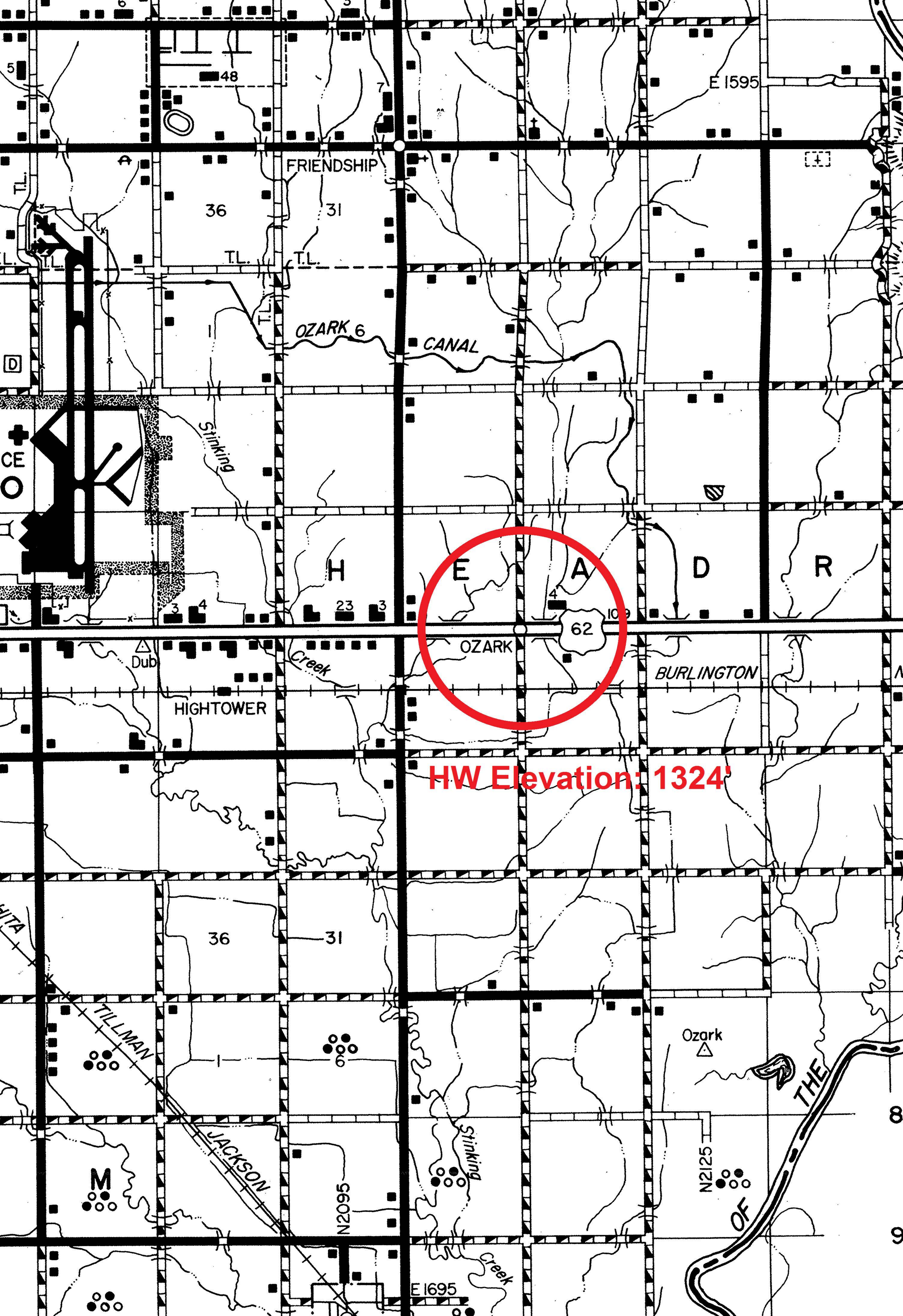

HW Elevation: 1324'