

**OKLAHOMA DEPARTMENT OF TRANSPORTATION
SURVEY DIVISION**

FLOOD INFORMATION FORM

Division #:	1 <input type="checkbox"/> 2 <input type="checkbox"/> 3 <input type="checkbox"/> 4 <input type="checkbox"/> 5 <input checked="" type="checkbox"/> 6 <input type="checkbox"/> 7 <input type="checkbox"/> 8 <input type="checkbox"/>
County:	Jackson
Date Highwater occurred:	5/23/2015
Highway Number:	S.H. 5
Name of Stream:	
Direction and distance from nearest town, or highway junction	2.6 Miles East of Jct. US283 & SH5 NIB#12974 (12'-14'-12')X7'X32' R.C.BOX, SK. 30 DEG. R.F.
Section, Township, Range:	Between Section 34 T-1-N, R-20-W , Section 3 T-1-S, R-20-W
Description of Location:	East end of bridge floor Sta. 136+41.87
Highwater Elevation:	1297.9 or 0.7' below bridge floor
Level Datum & Source:	F.A.S.P. No. 5-434-(3)(S.H.)
Method used:	Conventional Level
Date Elevation Obtained:	5/26/2015
Apparent Magnitude:	Normal <input type="checkbox"/> Medium <input type="checkbox"/> Extreme <input checked="" type="checkbox"/> Don't Know <input type="checkbox"/>
Was Highwater Mark obtained from actual water, drift, local resident, or other source?	Supervisor of Jackson County ODOT.
Explanatory Remarks:	Jeff Harrington stated water was over SH5 50Yds. East of Structure

Note: Show Vicinity Map on back of form

Name (signature) _____
 Name (Printed) Daryl Williams
 Date:

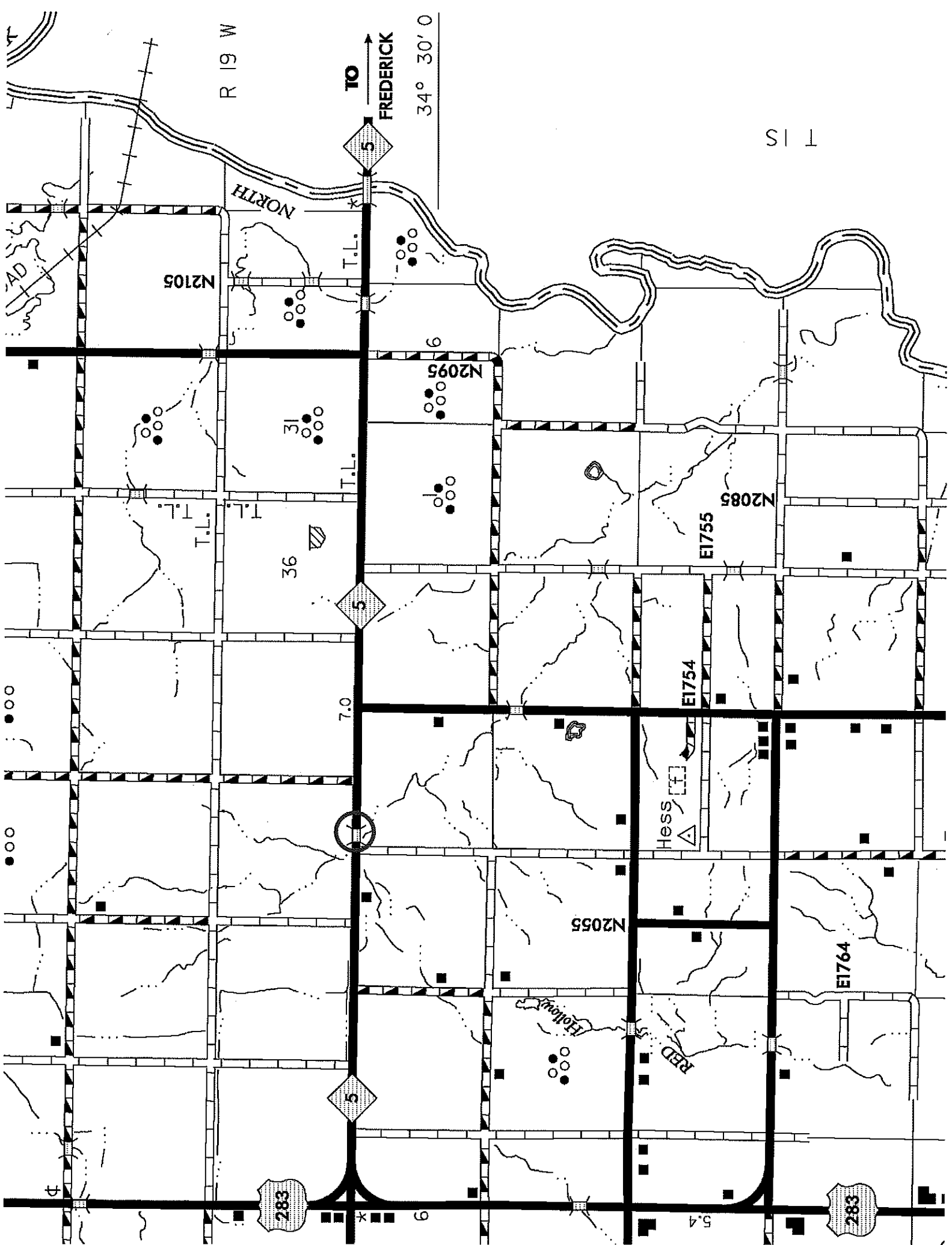

R 19 W

TO
FREDERICK

34° 30' 0

T 1 S

N2105

NORTH

5

T.L.

6

N2095

31

T.L.

N2085

E1755

36

5

E1754

7.0

Hess

N2055

E1764

5

RED

283

9

5.4

283