

STATE OF OKLAHOMA  
DEPARTMENT OF HIGHWAYS  
SURVEY DIVISION

FLOOD INFORMATION FORM

To be used in obtaining and transmitting flood water elevations for Survey Division office record files. This information to be obtained by all Chiefs of Party or others in their vicinity in times of unusual high water, or at any time available from a reliable source. The elevations can be recorded by level reading, by measurement from bridge floor, in relation to a house, above roadbed or any other dependable, clear manner that fits the situation, the highest order possible to be used. Separate report to be made on each crossing or place obtained.

County Jackson Date highwater occurred Oct. 18, 1966

Highway number US 283 Name of stream Red River

Direction and distance from nearest town, village or store Approx. 15 miles South of Altus Okla. Or 1.0 mile East and 2.5 miles South of Elmer Okla.

Section, Township and Range T-1-S- R-20-W

Description of Location Near C.C.Pitts Sand Plant as observed by Mr. Ralph Hyde at scale house located approx. 600 feet West of US 283 sta. 35/00 of FAP 292 plan sta.

Elevation 1255.35 Source of levels USC & GS

Method obtained Y-Level Date obtained Feb. 1967

Did it appear to be  normal  medium  extreme  do not know

Was highwater mark obtained from actual water, drift, local resident, U. S. Engineers, etc.? Actual HW as observed by Mr. Ralph Hyde employee at C.C.Pitts

Sand Plant ( Scale house )

Explanatory Remarks Highwater as observed around C.C.Pitts scale house on Oct. 19, 1966 by Mr. Ralph Hyde

Location to be shown on back of this sheet as a check.

Field Note: To be sent to  
Survey Engineer

Chas. I. Dickey  
Chief of Party

February 1967.  
Date

File: JACKSON Co. RECORDS.

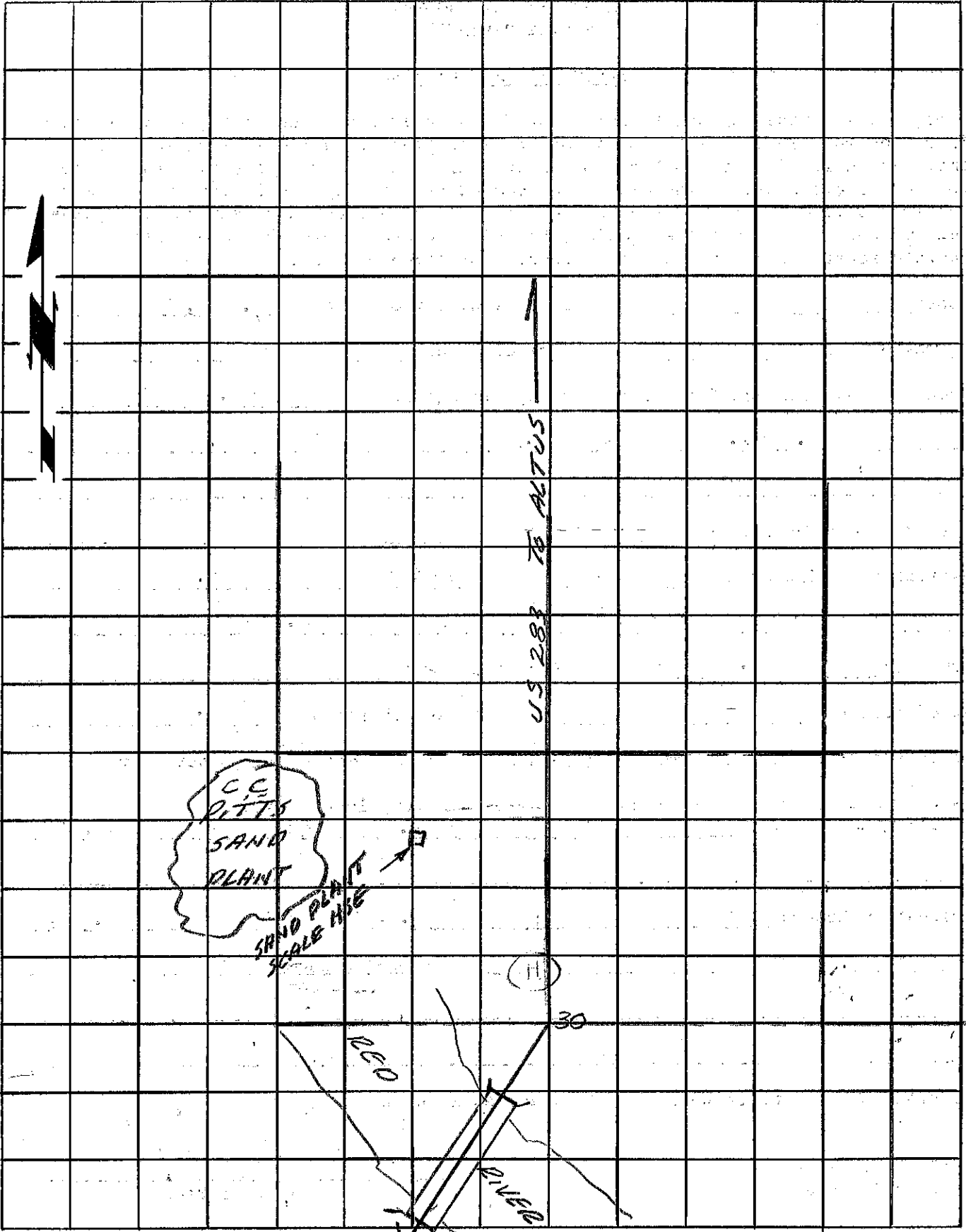

CC  
PITTS  
SAND  
PLANT

SAND PLANT  
SCALE HSE

U.S. 288 TO ACTUS

30

RED

RIVER

TEXAS

TO VERMONT

R-20-W

715