

STATE OF OKLAHOMA  
DEPARTMENT OF HIGHWAYS  
SURVEY DIVISION

Survey Division  
Form No. 16  
Rev. Dec. 2, 1974

FLOOD INFORMATION FORM

To be used in obtaining and transmitting flood water elevations for Survey Division office record files. This information to be obtained by all Chiefs of Party or others in their vicinity in times of unusual high water, or at any time available from a reliable source. The elevations can be recorded by level reading, by measurement from bridge floor, in relation to a house, above roadbed or any other dependable, clear manner that fits the situation, the highest order possible to be used. Separate report to be made on each crossing or place obtained.

County JACKSON Date highwater occurred 5-22-77

Highway number US 62 Name of stream NORTH FORK OF RED RIVER

Direction and distance from nearest town, village or store 9.0 MILES WEST OF  
SNYDER, OKLAHOMA.

Section, Township and Range SECTION 16 & 21, T2N, R18W

Description of Location 5.4 FT. BELOW BRIDGE SEAT, EAST END OF BRIDGE

Elevation 1316.61 Source of levels F-216(15)

Method obtained LEVEL Date obtained 5-23-77

Did it appear to be  normal  medium  extreme  do not know

Was highwater mark obtained from actual water, drift, local resident, U. S. Engineers, etc.? ACTUAL WATER MARK & DRIFT

Explanatory Remarks APPROX 3" TO 5" RAINS UPSTREAM ON MAY 16, 1977.

THIS EXTREME HIGHWATER RESULTED FROM GENERAL 4" RAINS AND RELEASE OF LUGERT LAKE WATER. SEE HIGHWATER REPORT DATED JUNE 9, 1977.

Location to be shown on back of this sheet as a check.

Field Note: To be sent to  
Survey Engineer

*Richard Walden*  
Location Engineer

6-9-77  
Date

Location No. 2

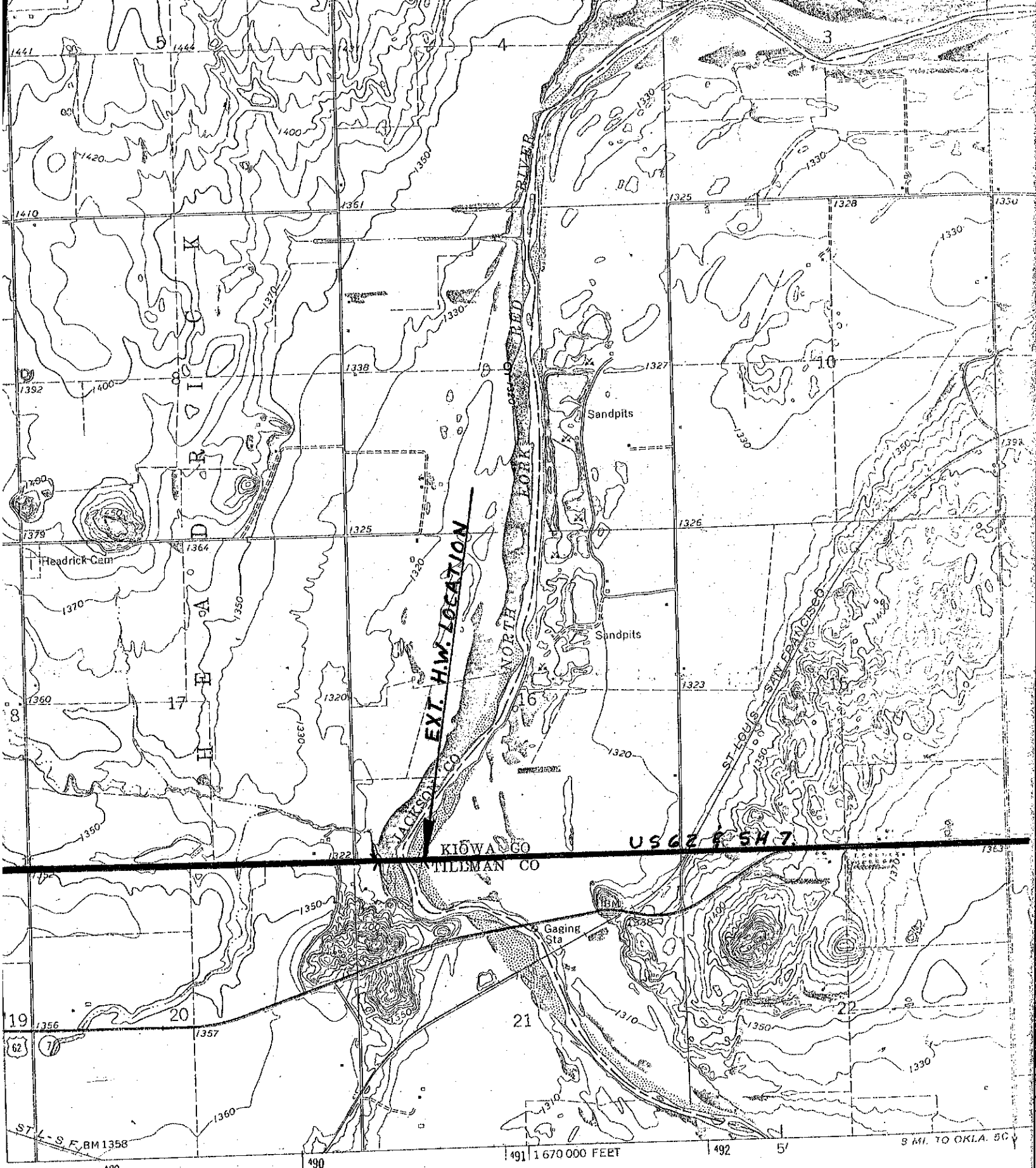

Mapped, edited, and published by the Geological Survey  
 Control by USGS, USC&GS, and Oklahoma Geological Survey

Topography by photogrammetric methods from aerial  
 photographs taken 1960. Field checked 1964

Polyconic projection. 1927 North American datum  
 10,000-foot grid based on Oklahoma coordinate system, south zone  
 1000-meter Universal Transverse Mercator grid ticks,  
 11 shown in blue.

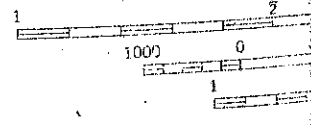
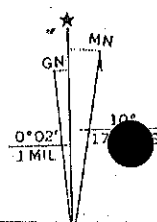

17°30"

489

490

1:670,000 FEET

492

5'

8 MI. TO OKLA. BC