

STATE OF OKLAHOMA
DEPARTMENT OF HIGHWAYS
SURVEY DIVISION

Survey Division
Form No. 16
Rev. Dec. 2, 1974

FLOOD INFORMATION FORM

To be used in obtaining and transmitting flood water elevations for Survey Division office record files. This information to be obtained by all Chiefs of Party or others in their vicinity in times of unusual high water, or at any time available from a reliable source. The elevations can be recorded by level reading, by measurement from bridge floor, in relation to a house, above roadbed or any other dependable, clear manner that fits the situation, the highest order possible to be used. Separate report to be made on each crossing or place obtained.

County JACKSON Date highwater occurred 5-22-77
Highway number SH 5 Name of stream NORTH FORK OF RED RIVER
Direction and distance from nearest town, village or store 5.0 MILES WEST OF TIPTON

Section, Township and Range SECTION 5, T1S, R19W, & SECTION 32, T1N, R19W.
Description of Location 4.5 FT. BELOW BRIDGE SEAT ON EAST END OF BRIDGE.

Elevation 1251.6 Source of levels FAS S-434(5)(SH) PLANS
Method obtained LEVEL Date obtained 5-23-77

Did it appear to be normal medium extreme do not know

Was highwater mark obtained from actual water, drift, local resident, U. S. Engineers, etc. ACTUAL WATER MARK & DRIFT.

Explanatory Remarks APPROX 3" TO 5" RAINS UPSTREAM ON MAY 16, 1977. THIS EXTREME HIGHWATER RESULTED FROM GENERAL 4" RAINS IN AREA AND RELEASE OF LUGERT LAKE WATER. SEE HIGHWATER REPORT DATED JUNE 9, 1977.

Location to be shown on back of this sheet as a check.

Field Note: To be sent to
Survey Engineer

Rewayne Walden
Location Engineer

6-9-77

Date

Location No. 3

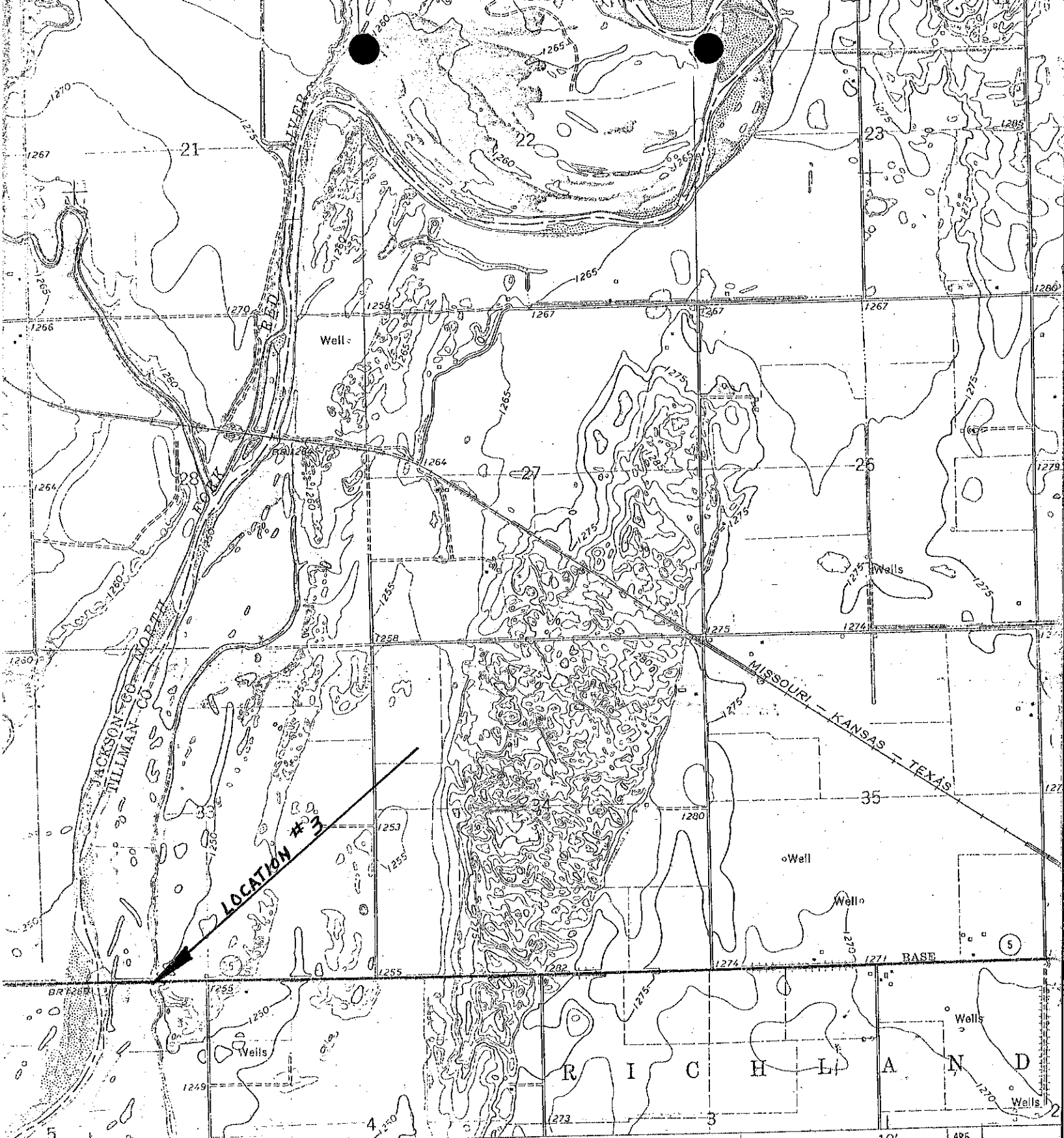

(FREDERICK 1:62 500)
6152 1

SCALE 1:24 000

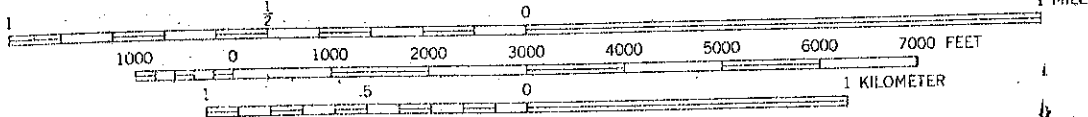

CONTOUR INTERVAL 5 FEET
DATUM IS MEAN SEA LEVEL