

STATE OF OKLAHOMA
DEPARTMENT OF HIGHWAYS
SURVEY DIVISION

Survey Division
Form No. 16
Rev. Sept. 10, 1961

FLOOD INFORMATION FORM

To be used in obtaining and transmitting flood water elevations for Survey Division office record files. This information to be obtained by all Chiefs of Party or others in their vicinity in times of unusual high water, or at any time available from a reliable source. The elevations can be recorded by level reading, by measurement from bridge floor, in relation to a house, above roadbed or any other dependable, clear manner that fits the situation, the highest order possible to be used. Separate report to be made on each crossing or place obtained.

County KIOWA-JACKSON Date highwater occurred MAY 9, 1993

Highway number S.H. 19 Name of stream NORTH FORK OF THE RED RIVER

Direction and distance from nearest town, village or store APPROX. 2.5 MILES

EAST OF WARREN, OKLA. ON THE KIOWA-JACKSON COUNTY LINE.

Section, Township and Range BETWEEN SECTIONS 26 & 35, T-3-N, R-18-W

Description of Location _____

Elevation 1397.3 Source of levels HIGHWAY PLANS

Method obtained WILD NA-2 ENGR.LEVEL Date obtained MAY 10, 1993

Did it appear to be normal medium extreme do not know

Was highwater mark obtained from actual water, drift, local resident, U. S. Engineers, etc.? DRIFT

Explanatory Remarks _____

Location to be shown on back of this sheet as a check.

Field Note: To be sent to
Survey Engineer

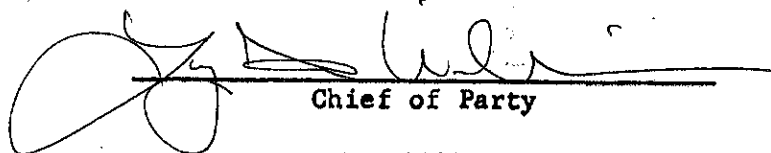
Chief of Party

MAY 13, 1993
Date

LOCATION No. 4

MAY 14 1993

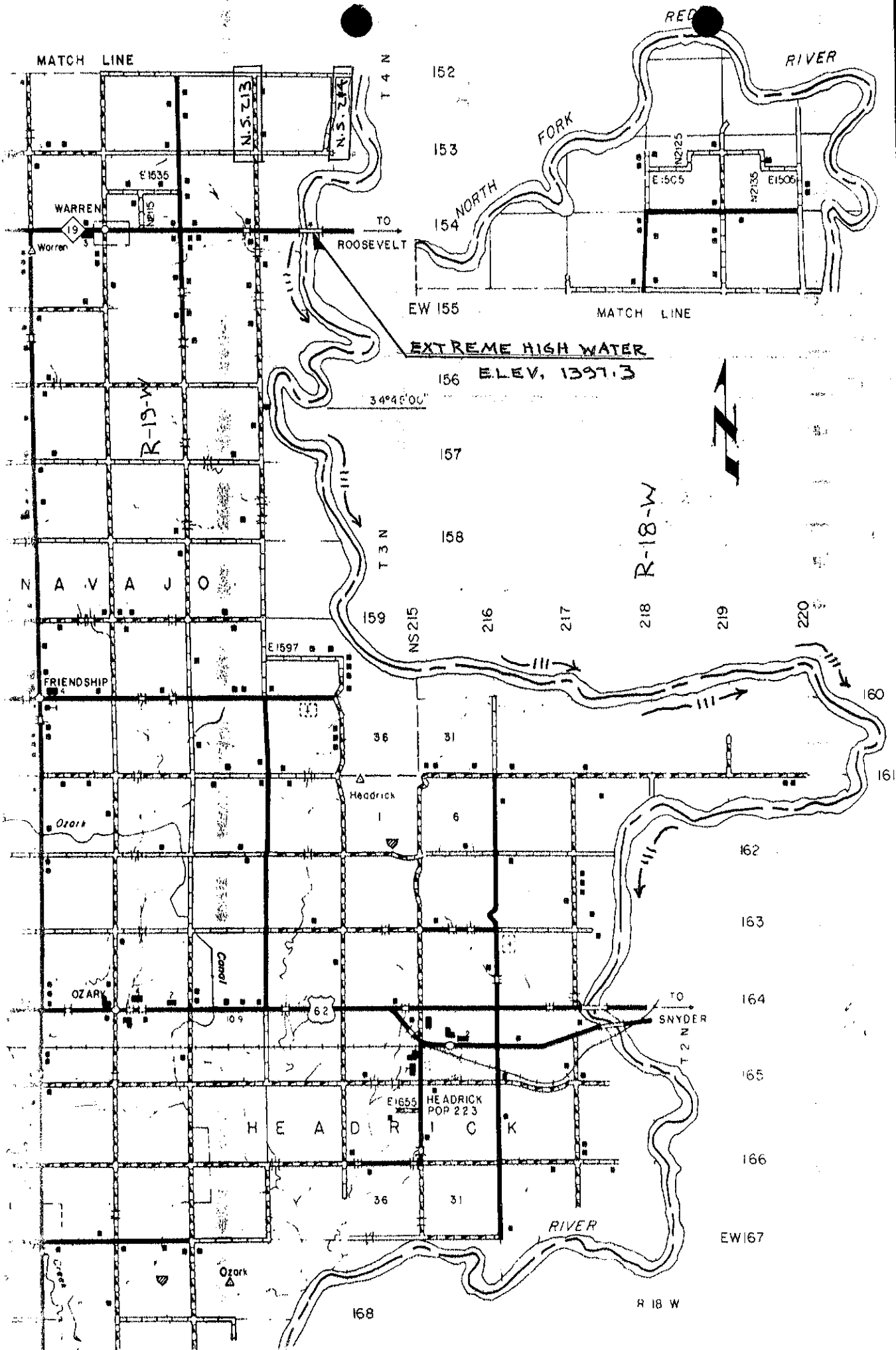

MATCH LINE

RED

RIVER

152

153

154

EW 155

MATCH LINE

EXTREME HIGH WATER
ELEV, 1397.3

156

157

158

34°45'00"

159

216

217

218

219

220

N A V A J O

R-18-W

R-19-W

FRIENDSHIP

36

31

Headrick

6

162

163

164

165

166

OZARK

H E A D R I C K

36

31

RIVER

EW 167

R 18 W

168

WARREN

TO
ROOSEVELT

TO
SNYDER

E 1535

N 215

N.S. 213

N.S. 214

N 215

N 215

E 1506

E 1597

62

E 1655

HEADRICK
POP 223

Ozark

Canal

Creek

