

STATE OF OKLAHOMA
DEPARTMENT OF HIGHWAYS
SURVEY DIVISION

Survey Division
Form No. 16
Rev. Dec. 2, 1974

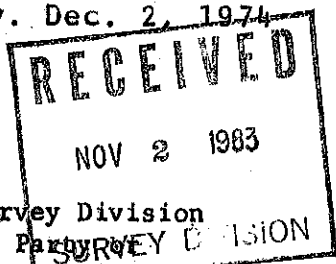

FLOOD INFORMATION FORM

To be used in obtaining and transmitting flood water elevations for Survey Division office record files. This information to be obtained by all Chiefs of Party or others in their vicinity in times of unusual high water, or at any time available from a reliable source. The elevations can be recorded by level reading, by measurement from bridge floor, in relation to a house, above roadbed or any other dependable, clear manner that fits the situation, the highest order possible to be used. Separate report to be made on each crossing or place obtained.

County JACKSON Date highwater occurred OCTOBER 20, 1983
Highway number S.H. 34 Name of stream SANDY CREEK
Direction and distance from nearest town, village or store 0.4 MILES S.W. OF ELDORADO,
OKLAHOMA ON S.H. 34

Section, Township and Range SECTION 24, T-1-S, R-24-W

Description of Location SANDY CREEK BRIDGE AT STA. 287+39.47 ON F.A.P. NO. F 104(4)(5) -
S.H. 34 PLANS.

Elevation 1418.3 Source of levels F.A.P. NO. F 104(4)(5) -
S.H. 34 PLANS

Method obtained HAND LEVEL Date obtained OCTOBER 31, 1983

Did it appear to be normal medium extreme do not know

Was highwater mark obtained from actual water, drift, local resident,
U. S. Engineers, etc.? DRIFT UNDER BRIDGE

Explanatory Remarks EXTREME HIGHWATER ROSE TO 1.5' BELOW BRIDGE SEAT AT NORTH END BRIDGE.
EXTREME HIGHWATER OCCURRED FROM 10" RAINS OVER A 3 DAY PERIOD.

Location to be shown on back of this sheet as a check.

Field Note: To be sent to
Survey Engineer

Waynes Walden
Location Engineer

OCTOBER 31, 1983
Date

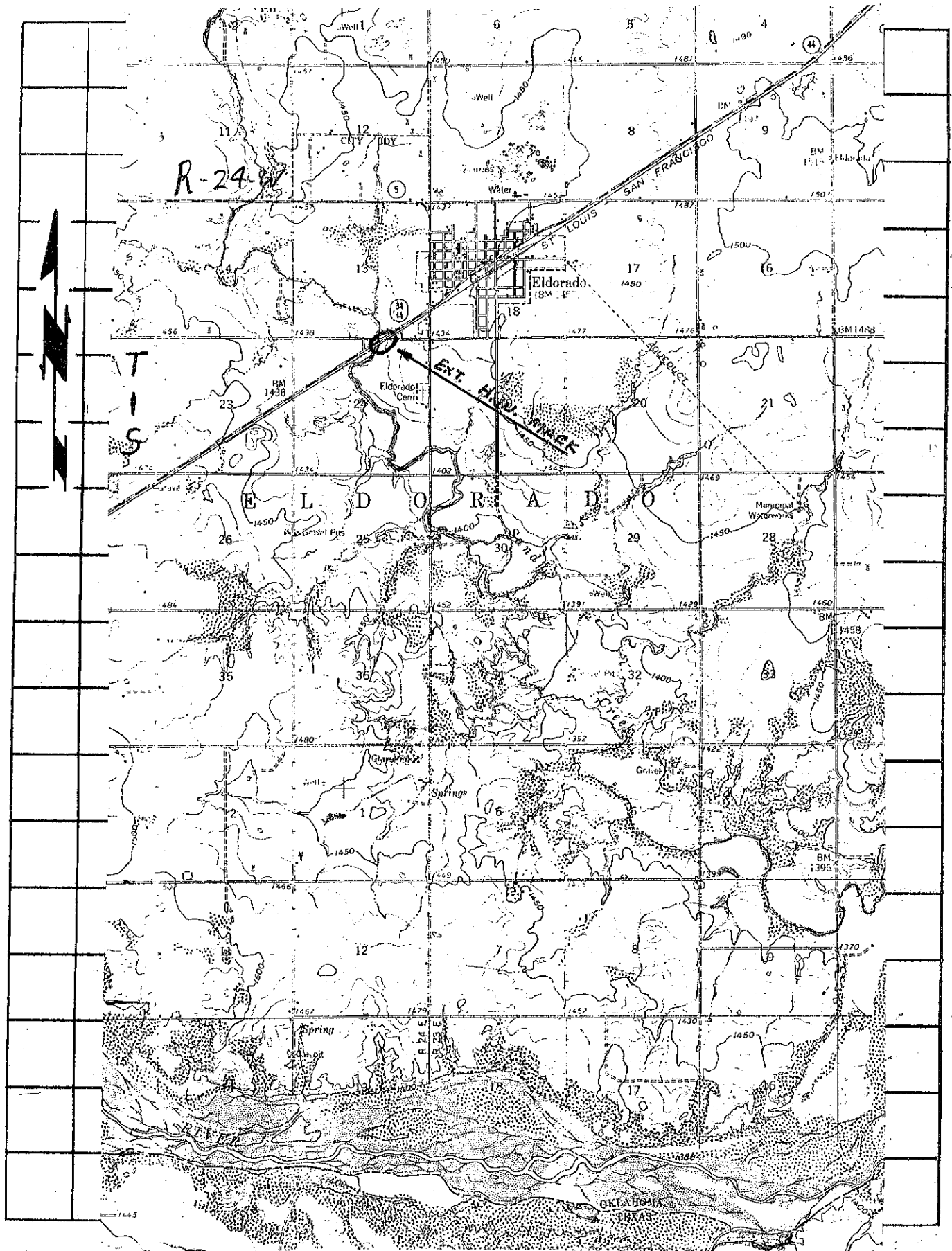

R-24



T
I
S

EXT. H. 143

E L D O R A D O

OKLAHOMA
TEXAS