

LOC. NO 2

LOC. NO 1
Bemoine Cr.

*LOC. NO. 3
MINTOSH CR.*

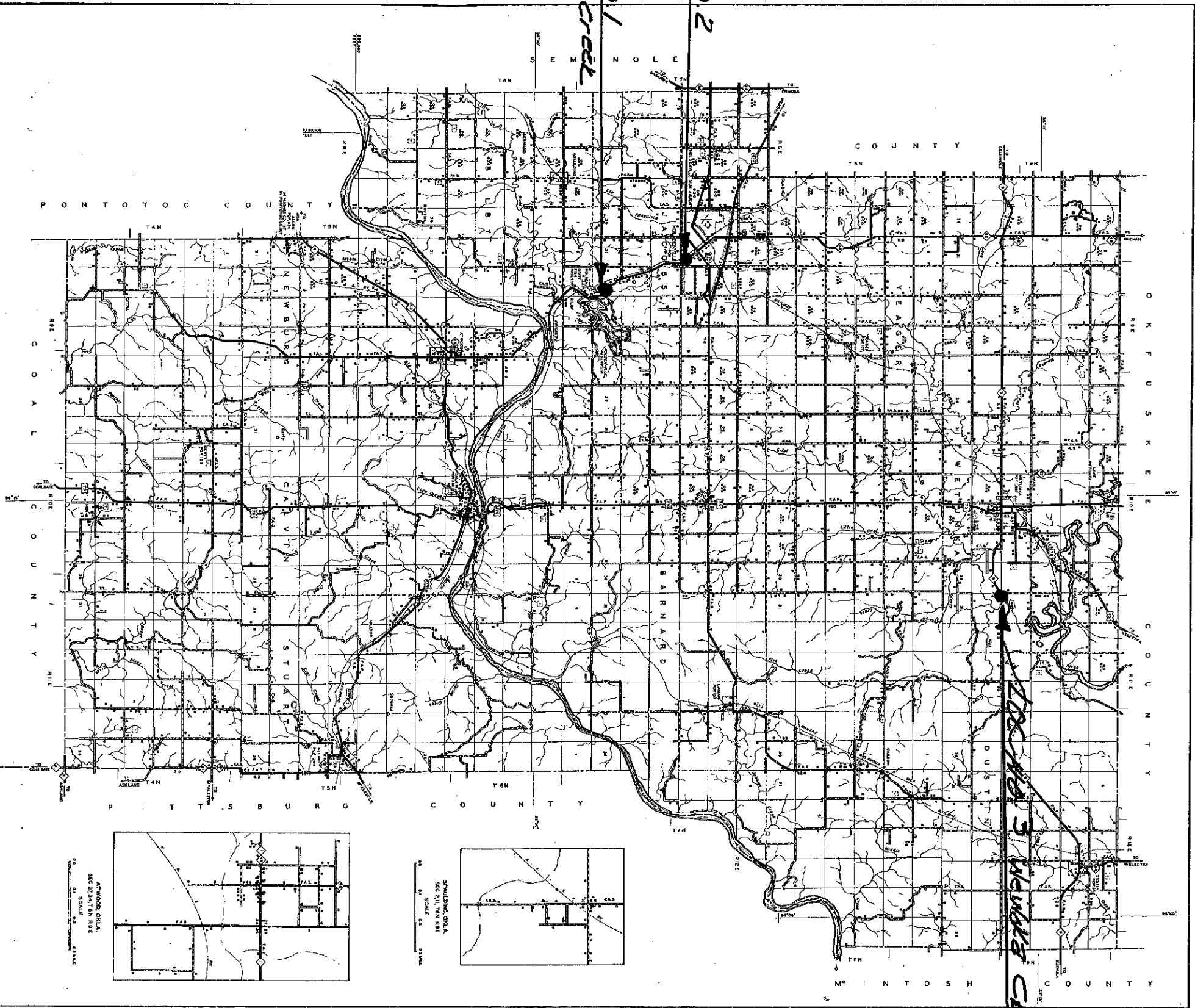

LEGEND

- GENERAL ROADWAY FEATURES**
- Interstate Highway
 - State Highway
 - County Highway
 - Local Road
 - Stream
 - Railroad
 - City or Town
 - Unimproved Road
 - Proposed Road
 - Proposed Interchange
 - Proposed Overpass
 - Proposed Underpass
 - Proposed Roundabout
 - Proposed T-intersection
 - Proposed Y-intersection
 - Proposed X-intersection
 - Proposed T-intersection with roundabout
 - Proposed Y-intersection with roundabout
 - Proposed X-intersection with roundabout

- ROADWAY AND STRUCTURE**
- Interchange
 - Overpass
 - Underpass
 - Roundabout
 - T-intersection
 - Y-intersection
 - X-intersection
 - T-intersection with roundabout
 - Y-intersection with roundabout
 - X-intersection with roundabout

- OBSTACLES OUTLINE**
- Water
 - Highway
 - Railroad
 - City or Town
 - Unimproved Road
 - Proposed Road
 - Proposed Interchange
 - Proposed Overpass
 - Proposed Underpass
 - Proposed Roundabout
 - Proposed T-intersection
 - Proposed Y-intersection
 - Proposed X-intersection
 - Proposed T-intersection with roundabout
 - Proposed Y-intersection with roundabout
 - Proposed X-intersection with roundabout

GENERAL HIGHWAY MAP
HUGHES COUNTY
OKLAHOMA

PREPARED BY THE
OKLAHOMA DEPARTMENT OF HIGHWAYS
PLANNING DIVISION
IN COOPERATION WITH THE
U.S. DEPARTMENT OF TRANSPORTATION
FEDERAL HIGHWAY ADMINISTRATION

SCALE
1 INCH = 5 MILES

