

SURVEY DIVISION	
✓ GBS	MAY 28 1968
✓ WWV	6-17-68
✓ WNM	6-17-68
✓ GWP	
✓ OCC	6-24-68
GER	
SDD	
RDA	
HFJ	
GSS	

STATE OF OKLAHOMA
DEPARTMENT OF HIGHWAYS
SURVEY DIVISION

Survey Division
Form No. 16
Rev. Sept. 10, 1961
RECEIVED
MAY 27 1968
SURVEY DIVISION

FLOOD INFORMATION FORM

To be used in obtaining and transmitting flood water elevations for Survey Division office record files. This information to be obtained by all Chiefs of Party or others in their vicinity in times of unusual high water, or at any time available from a reliable source. The elevations can be recorded by level reading, by measurement from bridge floor, in relation to a house, above roadbed or any other dependable, clear manner that fits the situation, the highest order possible to be used. Separate report to be made on each crossing or place obtained.

County Hughes Date highwater occurred May 13, 1968
Highway number SH 48 Name of stream Spillway Bridge or Bemore Creek
Direction and distance from nearest town, village or store Approx. 1/2 mile North
from the North End of Holdenville Lake on SH 48.

Section, Township and Range Section 32 T 7 N R 9 E

Description of Location Highwater Obtained At The Existing Bridge Across Bemore Creek
On SH 48 Approx. 1/2 Mile North From The North End Of Holdenville Lake On SH 48.

Elevation N. A. Source of levels _____

Method obtained Engr - Level Date obtained May 15, 1968

Did it appear to be normal medium extreme do not know

Was highwater mark obtained from actual water, drift, local resident,
U. S. Engineers, etc.? Drift

Explanatory Remarks Extreme Highwater 4.7 Below Center Line of existing Bridge
Floor at the West End. Section 32 T 7 N R 9 E

Location to be shown on back of this sheet as a check.

Field Note: To be sent to
Survey Engineer

Harold Fin
Chief of Party

May 15, 1968
Date

SWO - 464 - Level Books Discarded
Protect -

LOCATION NO. 1

R 9 E

APR 8 5 1963
10-11-63

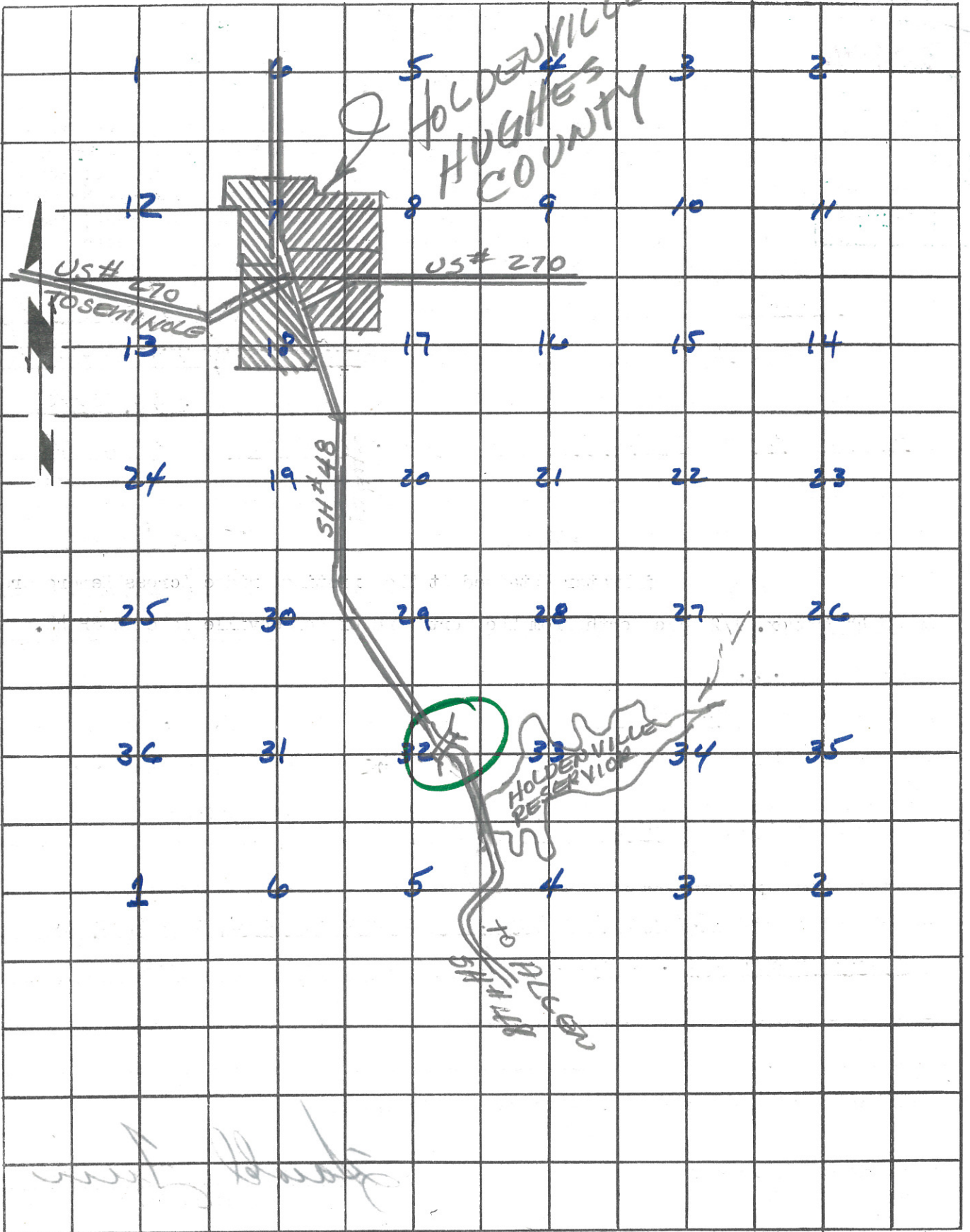

T
7
N

R 9 E