

SURVEY DIVISION	
GHS	MAY 28 1968
WWV	6-17-68
WNM	6-17-68
GWP	
OCC	6-24-68
GER	
SDD	
RDA	
HFT	
GSS	

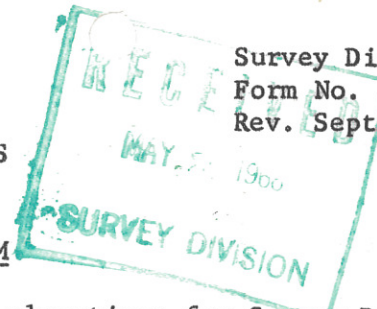

Survey Division  
Form No. 16  
Rev. Sept. 10, 1961

STATE OF OKLAHOMA  
DEPARTMENT OF HIGHWAYS  
SURVEY DIVISION

FLOOD INFORMATION FORM

To be used in obtaining and transmitting flood water elevations for Survey Division office record files. This information to be obtained by all Chiefs of Party or others in their vicinity in times of unusual high water, or at any time available from a reliable source. The elevations can be recorded by level reading, by measurement from bridge floor, in relation to a house, above roadbed or any other dependable, clear manner that fits the situation, the highest order possible to be used. Separate report to be made on each crossing or place obtained.

County HUGHES Date highwater occurred May 13, 1968

Highway number SH 48 Name of stream Unknown

Direction and distance from nearest town, village or store Approx 300' North of the South City Limits of Holdenville

Section, Township and Range West Side Section 18 T 7 N R 9 E

Description of Location \_\_\_\_\_

Elevation N. A. Source of levels \_\_\_\_\_

Method obtained Eng. Level Date obtained May 14, 1968

Did it appear to be  normal  medium  extreme  do not know

Was highwater mark obtained from actual water, drift, local resident, U. S. Engineers, etc.? Drift

Explanatory Remarks Extreme Highwater 1.7' Above Bridge Floor on Existing Wood Structure

Approx. 300 Feet North of South City Limits of Holdenville on SH 48

Section 7 T 12 N R 9 E.

Location to be shown on back of this sheet as a check.

Field Note: To be sent to  
Survey Engineer

Charles Fur  
Chief of Party

May 14, 1968  
Date

SWO - 464 - Level Books Discarded - Project -

LOCATION NO. 2

R 8 E

R 9 E

1	2	3	4	5	6	7	8	9	10	11	12	13	14	15	16	17	18	19	20
1	2	3	4	5	6	7	8	9	10	11	12	13	14	15	16	17	18	19	20

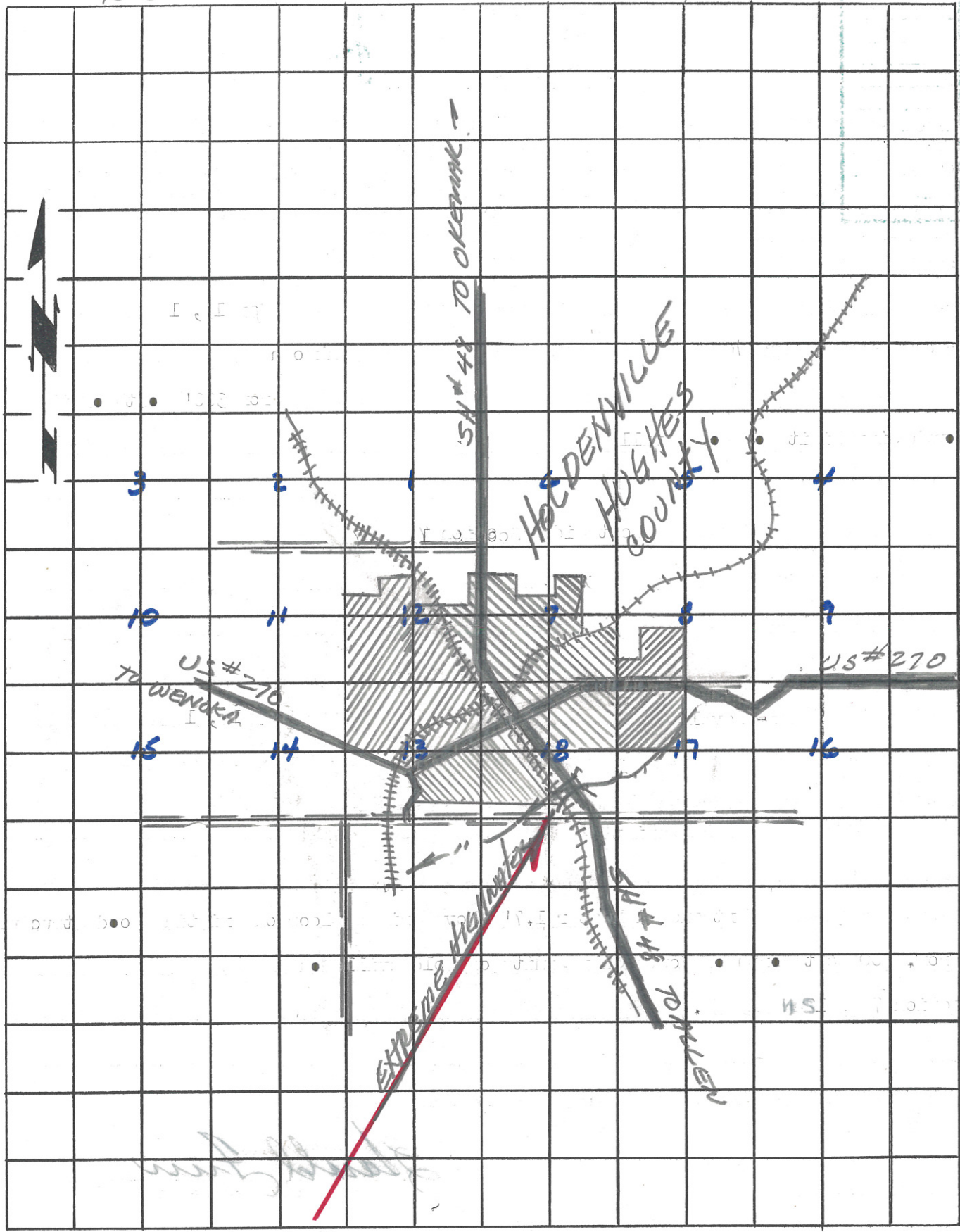

T  
7  
N

T  
7  
N

*[Handwritten signature]*