



**OKLAHOMA DEPARTMENT OF TRANSPORTATION
SURVEY DIVISION**

FLOOD INFORMATION FORM

Division #:	1 <input type="checkbox"/> 2 <input type="checkbox"/> 3 X 4 <input type="checkbox"/> 5 <input type="checkbox"/> 6 <input type="checkbox"/> 7 <input type="checkbox"/> 8 <input type="checkbox"/>
County:	Hughes
Date Highwater occurred:	5/11/2015
Highway Number:	SH 48
Name of Stream:	Little Wewoka Creek
Direction and distance from nearest town, or highway junction	Approximately 3.2 Mi. north of Jct. SH 9 & SH 48.
Section, Township, Range:	Section 1, T-9-N, R-8-E, I.M. & Section 6, T-9-N, R-9-E, I.M.
Description of Location:	Visible drift in W. fence line north of bridge.
Highwater Elevation:	789.6
Level Datum & Source:	NAVD 88 Datum
Method used:	Static GPS
Date Elevation Obtained:	5/14/2015
Apparent Magnitude:	Normal <input type="checkbox"/> Medium <input type="checkbox"/> Extreme X Don't Know <input type="checkbox"/>
Was Highwater Mark obtained from actual water, drift, local resident, or other source?	High Water information was obtained from Maintenance Supt. 1 Joey Bradley, ODOT (Okemah Yard) and was confirmed by visible drift in trees and fences north of bridge.
Explanatory Remarks:	

Note: Show Vicinity Map on back of form

Name (signature) _____

Name (Printed) Derrick E. Anderson

Date: June 15, 2015

High Water Location

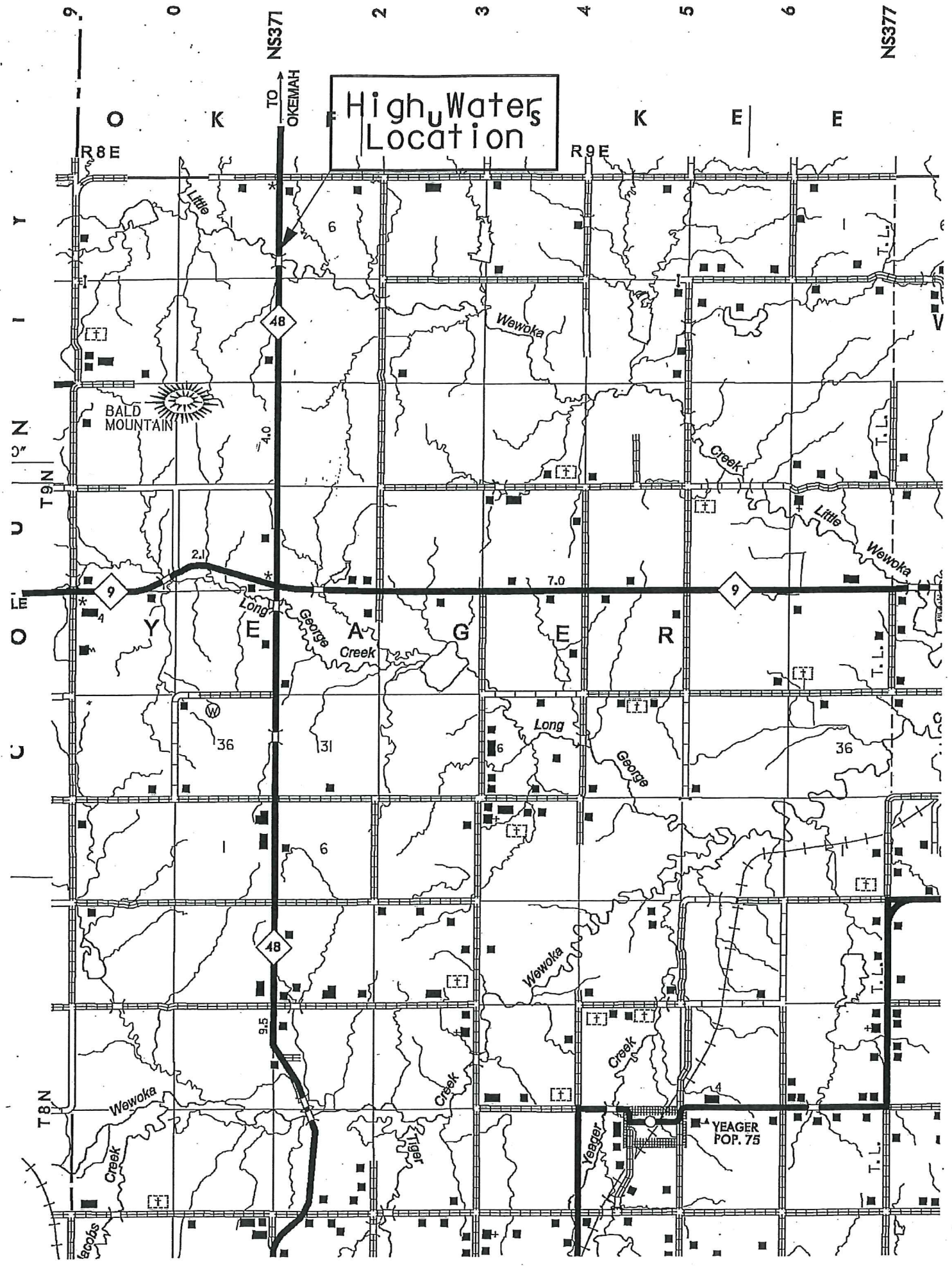

High Water Location

BALD MOUNTAIN

YEAGER POP. 75

NS377
TO OKEMAH

NS377

Y
I
N
U
O
C

Y

I

N

U

O

C

9

0

2

3

4

5

6

R8E

R9E

Little

Wewoka

Creek

Little

Wewoka

Long

George

Creek

Long

George

Wewoka

Creek

Creek

Yeager

Wewoka

Creek

Yeager

T.L.L.

T.L.L.

T.L.L.

T.L.L.

T.L.L.

48

48

9

2.1

36

31

7.0

6

36

9.5

6

6

4

4

4

4

4

4

4.0

4

4

4

4

4

4

4

4

4

6

6

6

6

6

6

6

6

6

6

6

6

6

6

6

6

6

6

6

6

6

6

6

6

6

6

6

6

6

6

6

6

6

6

6

6

6

6

6

6

6

6

6

6

6

6

6

6

6

6

6

6

6

6

6

6

6

6

6

6

6

6

6

6

6

6

6

6

6

6

6

6

6

6

6

6

6

6

6

6

6

6

6

6

6

6

6

6

6

6