

STATE OF OKLAHOMA
DEPARTMENT OF HIGHWAYS
PLANS & SURVEYS DEPARTMENT

FLOOD INFORMATION FORM

FILE

To be used in obtaining and transmitting flood water elevations for Plans & Survey office record files. This information to be obtained by all Chiefs of Party in their vicinity in times of unusual high water, oratory time available from a reliable source. The elevations can be recorded by level reading, by measurement from bridge floor, in relation to a house, above roadbed or any other dependable, clear manner that fits the situation, the highest order possible to be used. Separate report to be made on each crossing or place obtained.

County Harper Date highwater occurred spring 1951

Highway number SH 46 Name of stream Beaver River

Direction and distance from nearest town, village or store 1/2 mile north of May

Section, Township and Range ~~### Section ###~~ Sec 26- T22 N- R24W

Description of Location At the Beaver River Bridge on Sh 46 North of May

Method obtained _____

Elevation 2057.6 Source of levels USC & GS Level Datum

Was highwater mark obtained from actual water, drift, local resident, U. S.

Engineers, etc From Drift.

Explanatory Remarks Extrem highwater mark in town of May elev. 2039.1, by

Mr. Joh Cloyd

Location to be shown on back of this sheet as a check.

Field Note: To be sent to Engr.
of Plans & Surveys (1 copy).
Office note: To be filed in Flood
information by Counties.

William W. Vaughan
Chief of Party
Aug. 6, 1951
Date



State of Michigan
Form No. 15
Rev. July 15, 1949

R24W

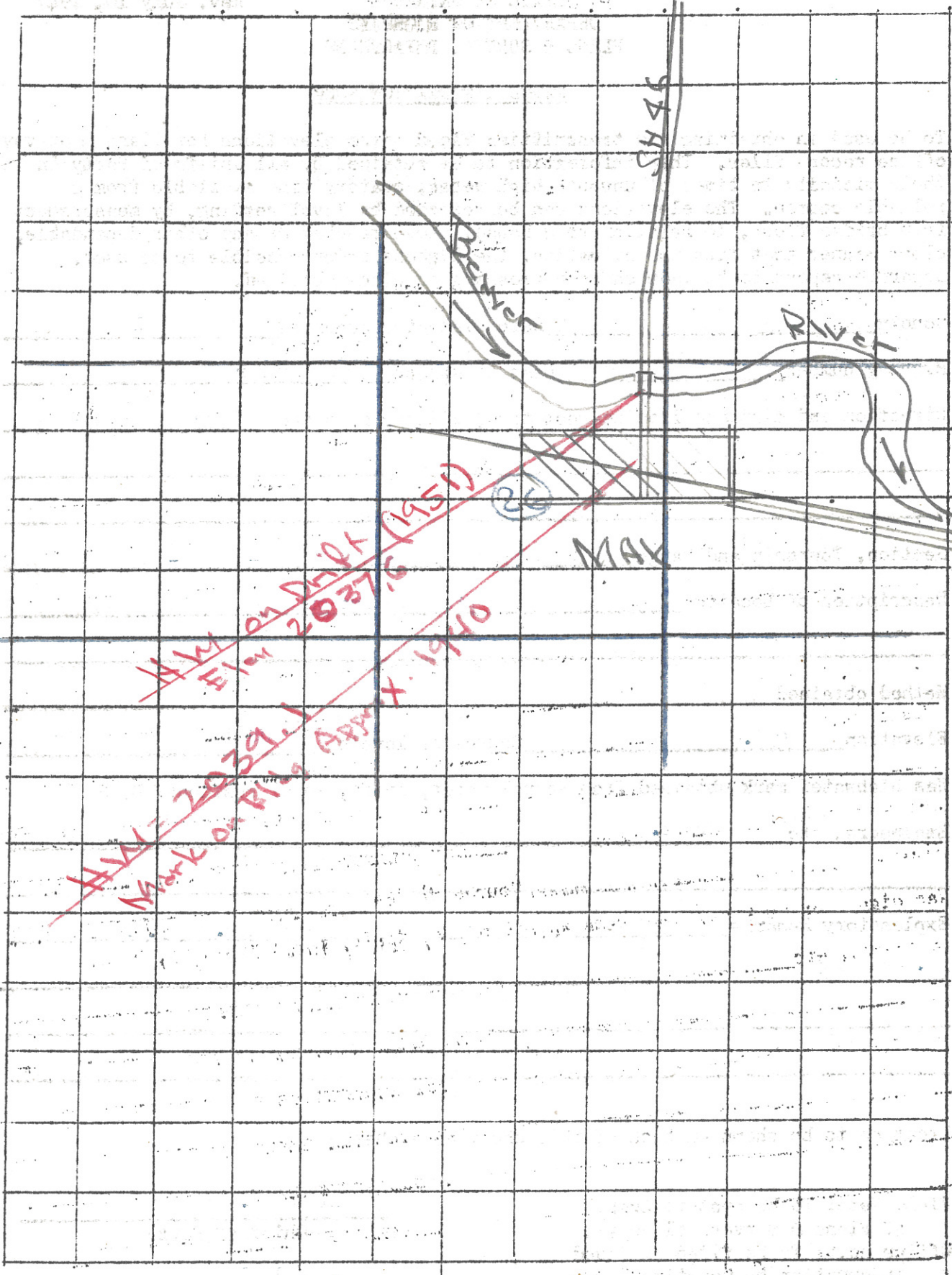

~~HWY 2039.1
Mark on R19 APRX. 1940~~

~~HWY on DICK (1951)
Flon 20716~~

State of Michigan

Information on this map is for general reference only and should not be used for legal purposes. The State of Michigan is not responsible for any errors or omissions on this map.