



OKLAHOMA DEPARTMENT OF TRANSPORTATION
SURVEY DIVISION

FLOOD INFORMATION FORM

Division #:	1 <input type="checkbox"/> 2 <input type="checkbox"/> 3 <input type="checkbox"/> 4 <input type="checkbox"/> 5 <input checked="" type="checkbox"/> 6 <input type="checkbox"/> 7 <input type="checkbox"/> 8 <input type="checkbox"/>
County:	Greer
Date Highwater occurred:	8/25/2017
Highway Number:	SH-9
Name of Stream:	N/A
Direction and distance from nearest town, or highway junction	500 Ft. E Of Jct. SH9 E &SH34
Section, Township, Range:	Section 26 T 6 N , R 22 W
Description of Location:	Intersection With Cultivation With Grass lined bar ditches
Latitude	34^57'29.57" N
Longitude	99^30'6.54" W
Highwater Elevation:	1620 Ft. or Approximately 1 ft. above road.
Level Datum & Source:	NAVD88 (Computer using GEOID12B)
Method used:	OPUS-RS Solution Utilizing RTK
Date Elevation Obtained:	8/29/2017
Apparent Magnitude:	Normal <input type="checkbox"/> Medium <input checked="" type="checkbox"/> Extreme <input type="checkbox"/> Unknown <input type="checkbox"/>
Was Highwater Mark obtained from actual water, drift, local resident, or other source?	Highwater was obtained from actual drift line.
Explanatory Remarks:	4" to 5" of rain occurred in the area of this location.

Name (Signature) Steve Perring

Name (Printed) Steve Perring

Date 9/7/2017

Note: Show Vicinity Map on back of form

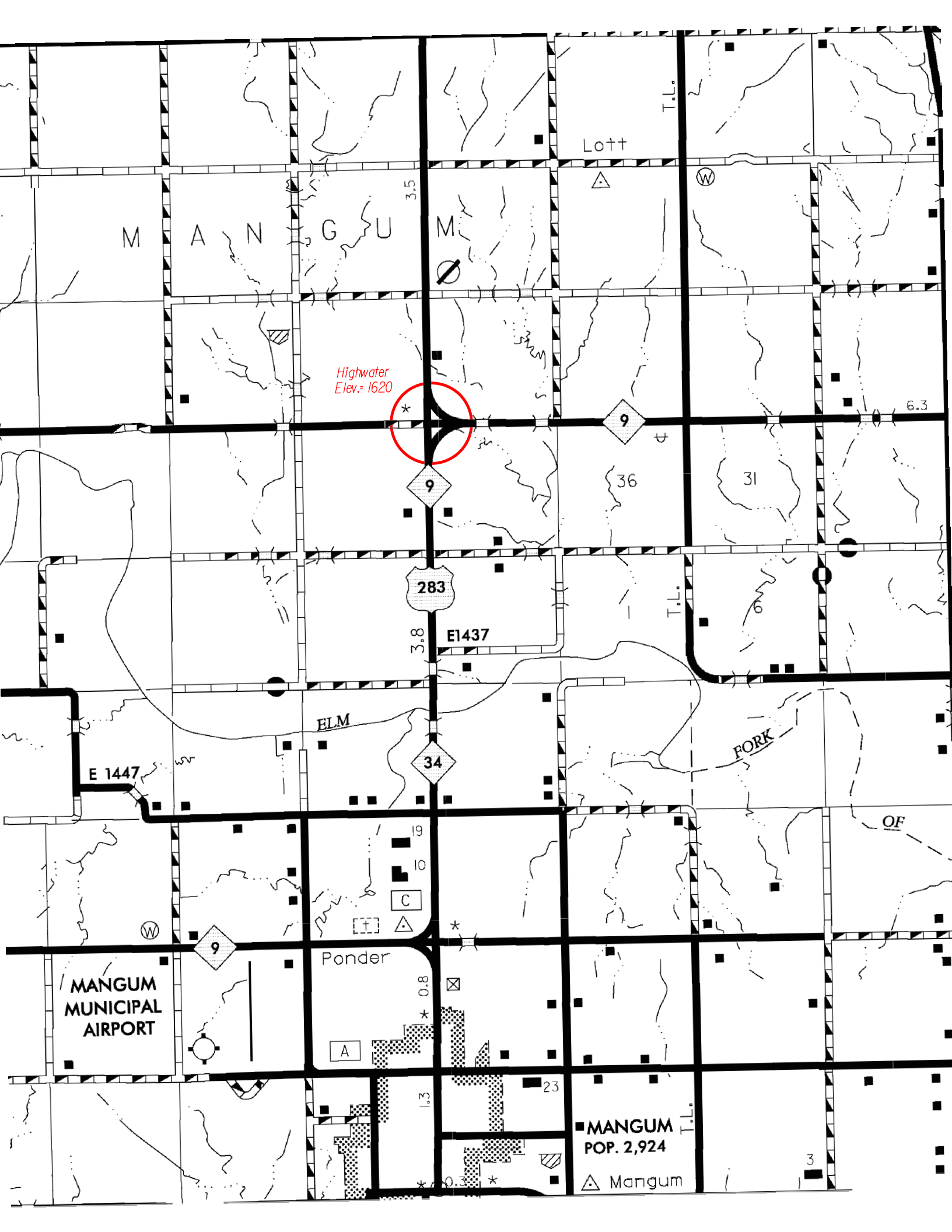

Highwater
Elev. = 1620

Lott

M A N G U M

3.5

6.3

283

E1437

3.8

ELM

34

FORK

OF

E 1447

19

10

C

Ponder

0.8

MANGUM
MUNICIPAL
AIRPORT

A

1.3

0.3

23

MANGUM
POP. 2,924

Mangum

3