

STATE OF OKLAHOMA
DEPARTMENT OF HIGHWAYS
SURVEY DIVISION

Survey Division
Form No. 16
Rev. Sept. 10, 1961

FLOOD INFORMATION FORM

To be used in obtaining and transmitting flood water elevations for Survey Division office record files. This information to be obtained by all Chiefs of Party or others in their vicinity in times of unusual high water, or at any time available from a reliable source. The elevations can be recorded by level reading, by measurement from bridge floor, in relation to a house, above roadbed or any other dependable, clear manner that fits the situation, the highest order possible to be used. Separate report to be made on each crossing or place obtained.

County Grant Date highwater occurred 4-19-70

Highway number US 81 Name of stream Osage Creek

Direction and distance from nearest town, village or store 0.5 miles north of
Jefferson, Oklahoma

Section, Township and Range Section 13, T-26-N, R-6-W.

Description of Location 25' west and 30' South of the SW cor. of Osage Creek
bridge on New US 81

Elevation 1047.52 Source of levels O.S.O.C.

Method obtained Y-Level Date obtained 4-20-70

Did it appear to be normal medium extreme do not know

Was highwater mark obtained from actual water, drift, local resident,
U. S. Engineers, etc.? Highwater obtained from visible drift observed by this
survey party.

Explanatory Remarks _____

Location to be shown on back of this sheet as a check.

Charles I. Hillis
Location Engineer

Field Note: To be sent to
Survey Engineer

By Luther E. Zach
Chief of Party
Associate Engineer
4-27-70
Date

LOCATION NO. 9

R-6-W

R-5-W

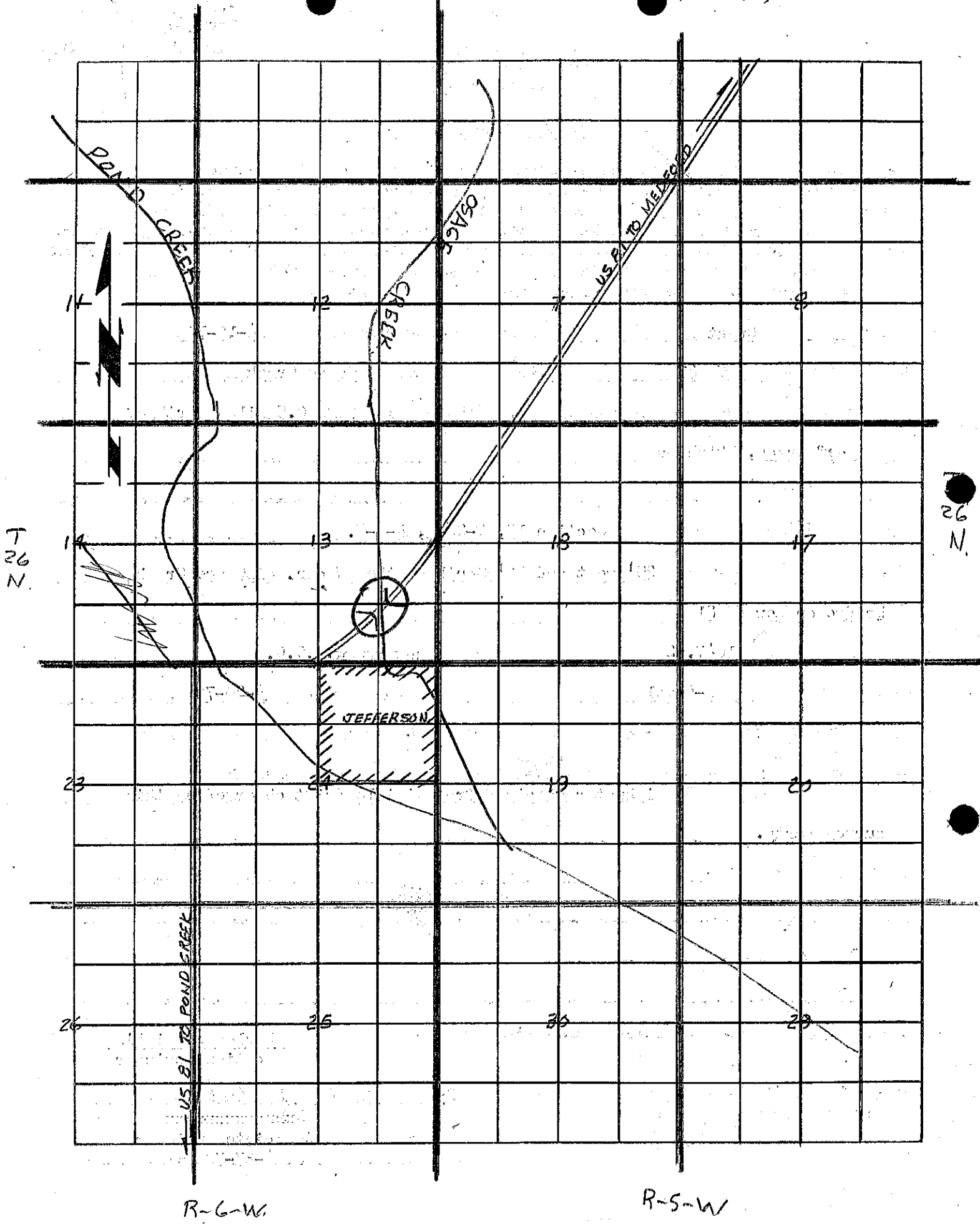

T 26 N

26 N

R-6-W

R-5-W