

STATE OF OKLAHOMA
DEPARTMENT OF HIGHWAYS
SURVEY DIVISION

FLOOD INFORMATION FORM

To be used in obtaining and transmitting flood water elevations for Survey Division office record files. This information to be obtained by all Chiefs of Party or others in their vicinity in times of unusual high water, or at any time available from a reliable source. The elevations can be recorded by level reading, by measurement from bridge floor, in relation to a house, above roadbed or any other dependable, clear manner that fits the situation, the highest order possible to be used. Separate report to be made on each crossing or place obtained.

County GRANT Date highwater occurred OCT 10, 1973

Highway number US 81 Name of stream _____

Direction and distance from nearest town, village or store 2 BLKS. N. OF
US 60 EAST IN POND CREEK

Section, Township and Range SEC 1 T25N-R6W

Description of Location CENTER OF BRANCH CULVT.
6.5' OVER & HWY. 5.3' OVER N.E. WINGWALL

Elevation _____ Source of levels _____

Method obtained STEEL TAPE Date obtained OCT 17, 1973

Did it appear to be normal medium extreme do not know

Was highwater mark obtained from actual water, drift, local resident, U. S. Engineers, etc.? WATER MARK ON TREES, DRIFT & TAVERN

OPERATOR 200' N.E. OF CULVT.

Explanatory Remarks _____

Location to be shown on back of this sheet as a check.

Field Note: To be sent to
Survey Engineer

Jerry E. Higginbotham
Chief of Party

OCT 25, 1973
Date

Loc. No. 27

R 6 W

H.W. CHECK POINT

US 81

US 81 & 60

STATE ROAD 2102

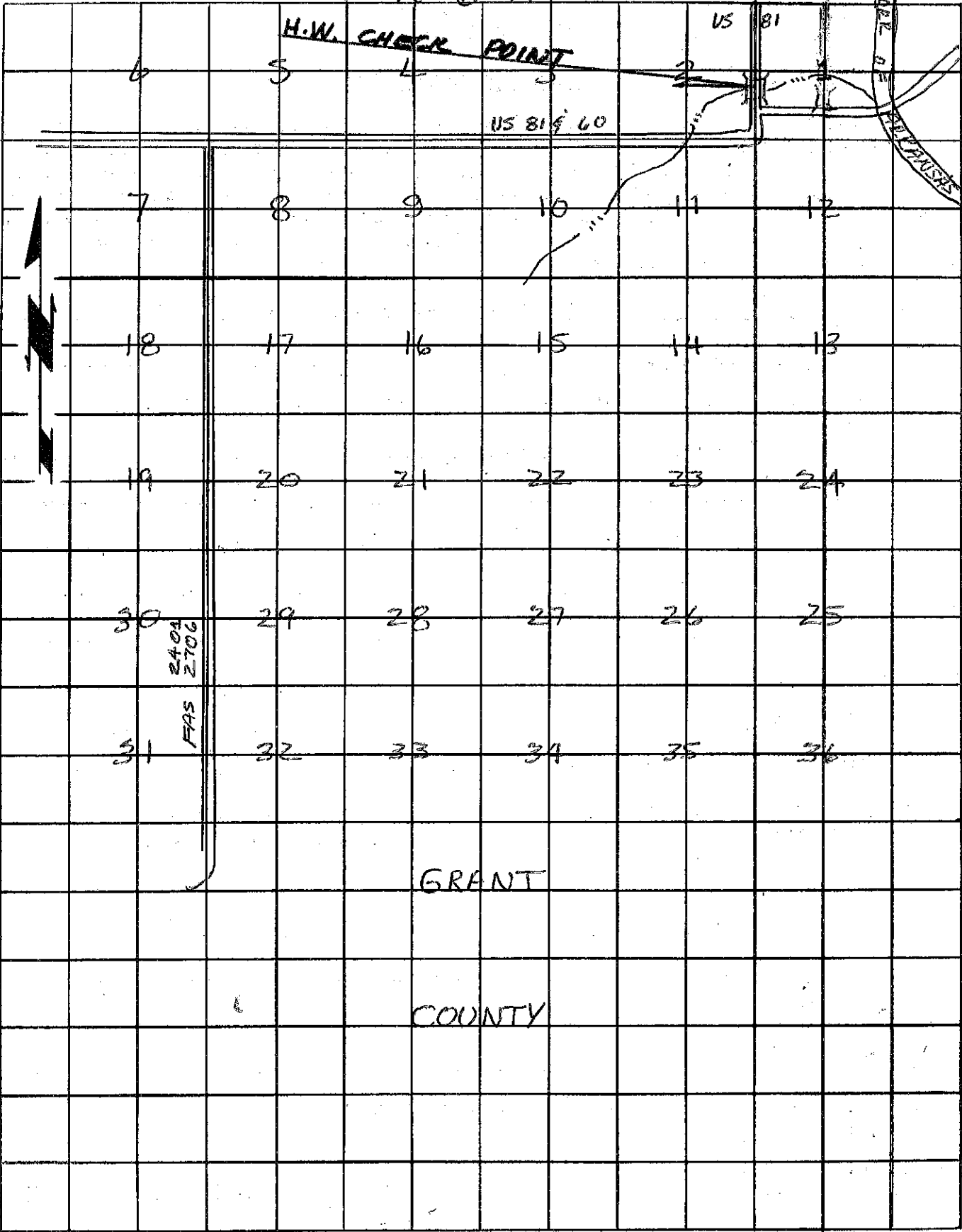

T 25

1

GRANT

COUNTY