

RECEIVED
NOV 13 1973
SURVEY DIVISION

STATE OF OKLAHOMA
DEPARTMENT OF HIGHWAYS
SURVEY DIVISION

Survey Division
Form No. 16
Rev. Sept. 10, 1961

FLOOD INFORMATION FORM

To be used in obtaining and transmitting flood water elevations for Survey Division office record files. This information to be obtained by all Chiefs of Party or others in their vicinity in times of unusual high water, or at any time available from a reliable source. The elevations can be recorded by level reading, by measurement from bridge floor, in relation to a house, above roadbed or any other dependable, clear manner that fits the situation, the highest order possible to be used. Separate report to be made on each crossing or place obtained.

County GRANT Date highwater occurred OCT 10, 1973

Highway number _____ Name of stream OSAGE & POND CREEK CREEKS

Direction and distance from nearest town, village or store IN JEFFERSON

Section, Township and Range SEC 24, T 26N - R 6W

Description of Location HARRY SMITH RESIDENCE 3 BLKS W. & 2 BLKS S. OF POST OFFICE. 0.8' OVER CONC. PORCH FLOOR AT FRONT DOOR

Elevation _____ Source of levels _____

Method obtained STEEL TAPE Date obtained OCT 17, 1973

Did it appear to be normal medium extreme do not know

Was highwater mark obtained from actual water, drift, local resident, U. S. Engineers, etc.? WATER MARK ON HOUSE & RESIDENT

Explanatory Remarks _____

Location to be shown on back of this sheet as a check.

Field Note: To be sent to
Survey Engineer

Levey E. Higginbotham
Chief of Party

OCT 25, 1973
Date

Loc No 29 - cont.

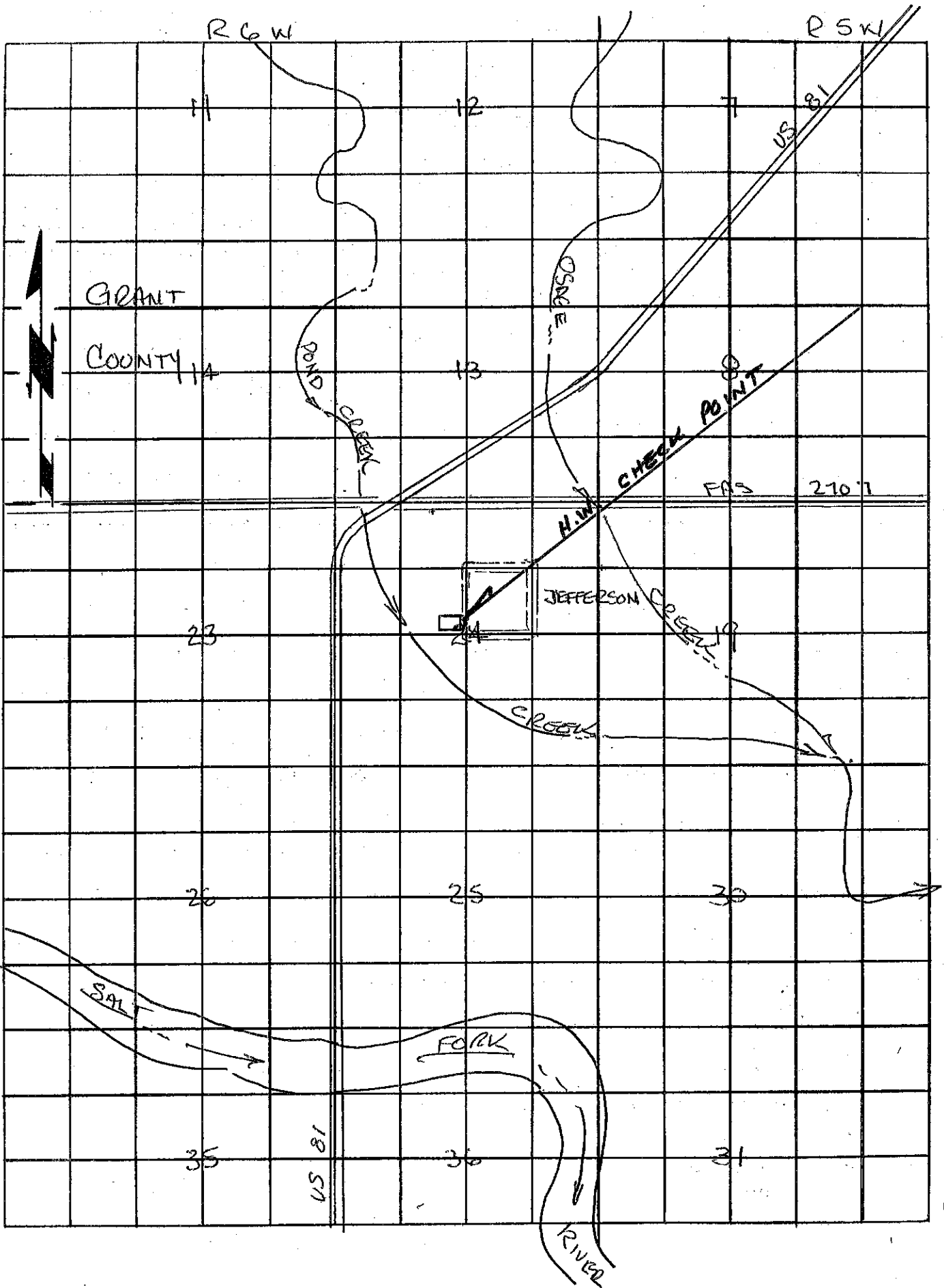

7
26
N