

STATE OF OKLAHOMA
DEPARTMENT OF HIGHWAYS
SURVEY DIVISION

Survey Division
Form No. 16
Rev. Sept. 10, 1961

FLOOD INFORMATION FORM ← *File*

To be used in obtaining and transmitting flood water elevations for Survey Division office record files. This information to be obtained by all Chiefs of Party or others in their vicinity in times of unusual high water, or at any time available from a reliable source. The elevations can be recorded by level reading, by measurement from bridge floor, in relation to a house, above roadbed or any other dependable, clear manner that fits the situation, the highest order possible to be used. Separate report to be made on each crossing or place obtained.

County Grady Date highwater occurred _____

Highway number U S 62 Name of stream West Bitter Creek

Direction and distance from nearest town, village or store 4.5 miles east of Chickasha.

Section, Township and Range Between Sections, 29 & 32, T 7 N, R 6 W.

Description of Location At Bridge

Elevation Down 2.0 from bridge floor. Source of levels _____

Method obtained Level and level rod Date obtained December 3, 1962

Did it appear to be normal medium extreme do not know

Was highwater mark obtained from actual water, drift, local resident, U. S. Engineers, etc.? Drift and water mark on bridge.

Explanatory Remarks For additional information on high water this survey party talked to six different local resident's who live near west bitter creek. None of these people could show us a high water mark but all said that water had never been over present paving.

Location to be shown on back of this sheet as a check.

Field Note: To be sent to
Survey Engineer

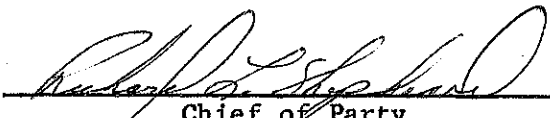
Chief of Party

December 3, 1962
Date

LOC. NO. 7

R 7 W

R 6 W



T
7
N

T
7
N

T
6
N

T
6
N

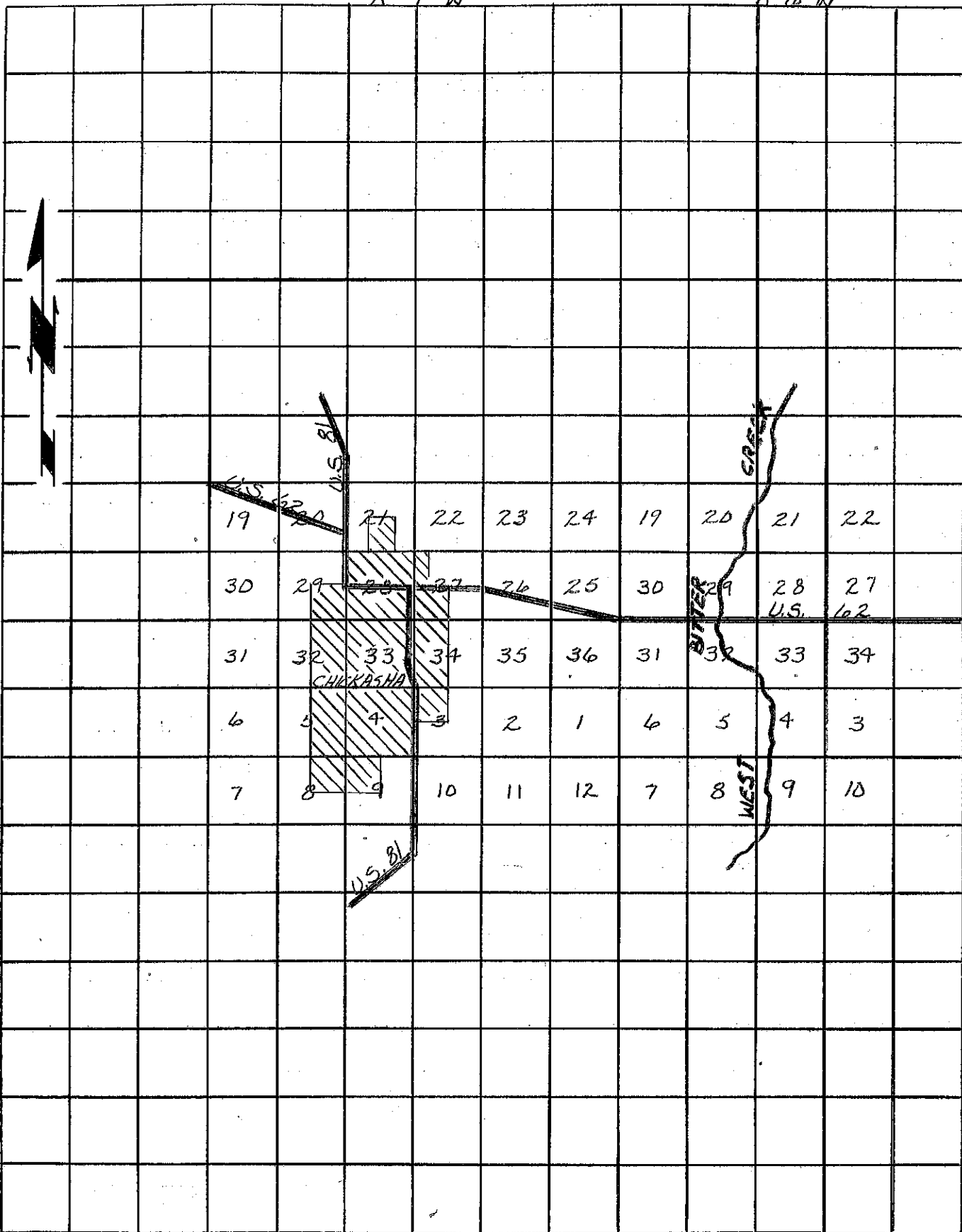

R 7 W

R 6 W