

MR. H.W. VAUGHAN

STATE OF OKLAHOMA
DEPARTMENT OF HIGHWAYS
SURVEY DIVISION

File

FLOOD INFORMATION FORM

Survey Division
Form No. 10
Rev. Sept. 10, 1961
RECEIVED
DEC. 6 1962
SURVEY DIVISION

To be used in obtaining and transmitting flood water elevations for Survey Division office record files. This information to be obtained by all Chiefs of Party or others in their vicinity in times of unusual high water, or at any time available from a reliable source. The elevations can be recorded by level reading, by measurement from bridge floor, in relation to a house, above roadbed or any other dependable, clear manner that fits the situation, the highest order possible to be used. Separate report to be made on each crossing or place obtained.

County Grady Date highwater occurred 1948

Highway number 62 Name of stream East Bitter Creek

Direction and distance from nearest town, village or store 6.0 miles east of Chickasha on U S 62.

Section, Township and Range Between Sections 27 & 34, T 7 N, R 6 W.

Description of Location at bridge

Elevation up 0.5 from bridge floor Source of levels _____

Method obtained _____ Date obtained Dec 3, 1962

Did it appear to be normal medium extreme do not know

Was highwater mark obtained from actual water, drift, local resident, U. S. Engineers, etc.? Local Resident

Explanatory Remarks Information was obtained from Mr. George Waldron Route 3, Chickasha, Okla. and Mr. Sam Dorchester 623 Kansas St. Chickasha, Okla. who both agreed that water was approx. 6" above bridge floor.

Location to be shown on back of this sheet as a check.

Field Note: To be sent to Survey Engineer

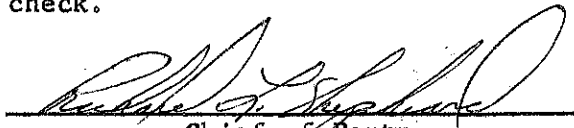
Chief of Party

December 3, 1962
Date

Loc. No. 8

R 7 W

R 6 W



T 7 N

T 7 N

T 6 N

T 6 N

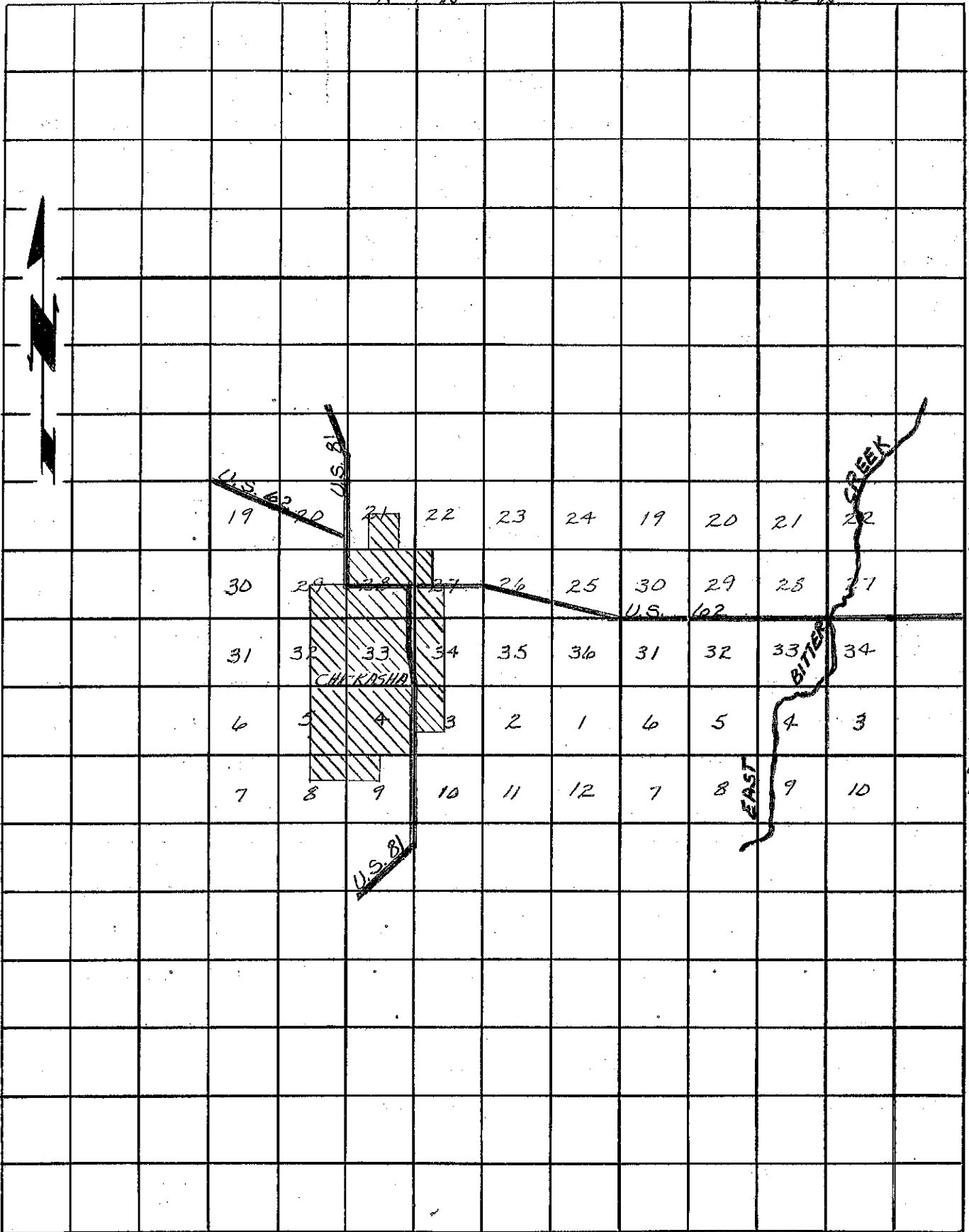

R 7 W

R 6 W