



OKLAHOMA DEPARTMENT OF TRANSPORTATION
SURVEY DIVISION

FLOOD INFORMATION FORM

Division #:	1 <input type="checkbox"/> 2 <input type="checkbox"/> 3 <input type="checkbox"/> 4 <input type="checkbox"/> 5 <input type="checkbox"/> 6 <input type="checkbox"/> 7 <input checked="" type="checkbox"/> 8 <input type="checkbox"/>
County:	GRADY
Date Highwater occurred:	04/02/07
Highway Number:	S.H. 37
Name of Stream:	N/A
Direction and distance from nearest town, or highway junction	LOCATION IS 2.0 MILES WEST OF TUTTLE ALONG S.H. 37.
Section, Township, Range:	BETWEEN SECTIONS 32 & 33, T-10-N, R-6-W, I.M.
Description of Location:	LOCATION AT CROSS-DRAIN
Highwater Elevation:	1314.14
Level Datum & Source:	SAP 851(1) 1946 PLANS
Method used:	DIFFERENTIAL LEVELING
Date Elevation Obtained:	04/05/07
Apparent Magnitude:	Normal <input type="checkbox"/> Medium <input type="checkbox"/> Extreme <input checked="" type="checkbox"/> Don't Know <input type="checkbox"/>
Was Highwater Mark obtained from actual water, drift, local resident, or other source?	HIGHWATER MARK WAS OBTAINED BY REMNANTS OF DRIFT.
Explanatory Remarks:	

Note: Show Vicinity Map on back of form

Name (signature) _____
Name (Printed) _____
Date: 05/30/07

DANNY R. DEES, PLS

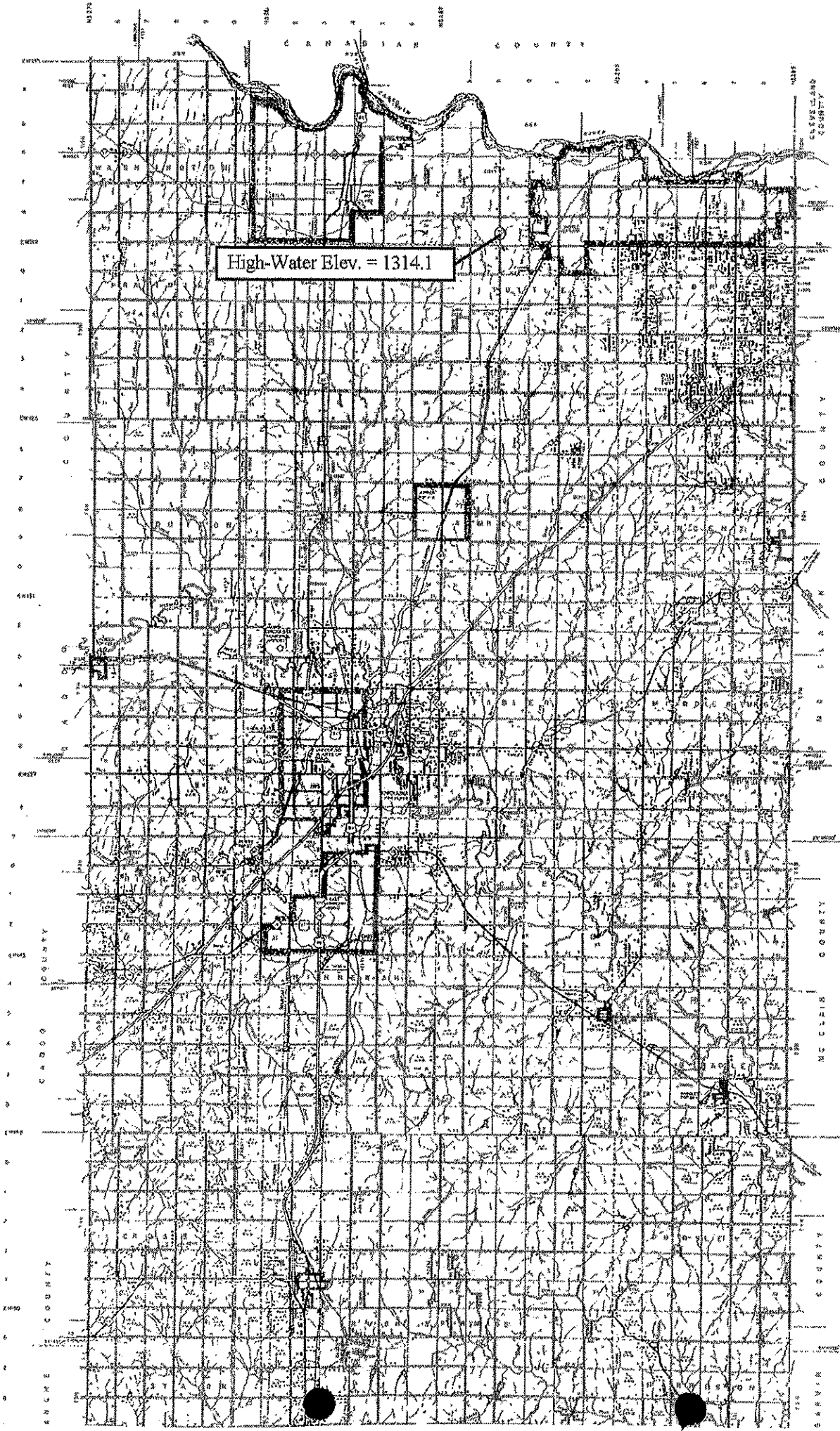

High-Water Elev. = 1314.1