

OKLAHOMA DEPARTMENT OF TRANSPORTATION
SURVEY DIVISION

FLOOD INFORMATION FORM

Division #:	1 <input type="checkbox"/> 2 <input type="checkbox"/> 3 <input type="checkbox"/> 4 <input type="checkbox"/> 5 <input type="checkbox"/> 6 <input type="checkbox"/> 7 <input checked="" type="checkbox"/> 8 <input type="checkbox"/>
County:	GRADY
Date Highwater occurred:	04/02/07
Highway Number:	S.H. 39
Name of Stream:	
Direction and distance from nearest town, or highway junction	Location is 3.6 miles east of the Jct. of S.H. 39 & U.S. 62 and 5.0 miles west of the Grady/McClain county line.
Section, Township, Range:	Corner common to Sec's. 29, 30, 31 & 32, T-7-N, R-5-W, I.M.
Description of Location:	Overflow of Crossdrain into lanes.
Highwater Elevation:	1158.8
Level Datum & Source:	SAP 842(3) 1946 PLANS
Method used:	Differential Leveling
Date Elevation Obtained:	04/05/07
Apparent Magnitude:	Normal <input type="checkbox"/> Medium <input type="checkbox"/> Extreme <input checked="" type="checkbox"/> Don't Know <input type="checkbox"/>
Was Highwater Mark obtained from actual water, drift, local resident, or other source?	Highwater Mark obtained from locating remnants of drift.
Explanatory Remarks:	

Note: Show Vicinity Map on back of form

Name (signature)

Name (Printed)

DANNY R. DEES, PLS

Date: 05/30/07

Survey Division

Form No. 16

Revised: 5/09/2007

Loc No 25

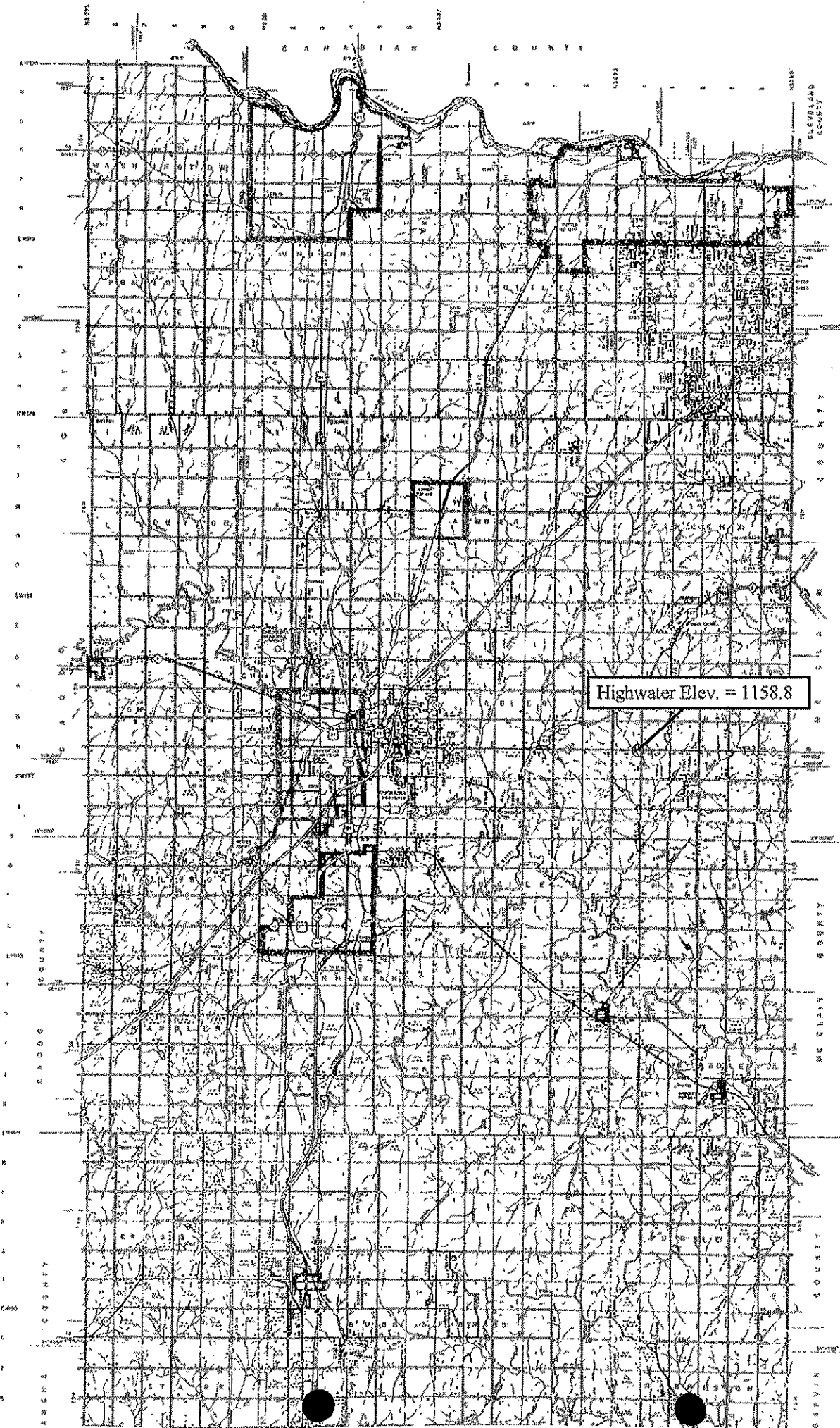

Highwater Elev. = 1158.8