

SURVEY DIVISION	
GHHS	6-11-68
BAWV	6-11-68
WNNM	6-11-68
GWP	
OCC	6-24-68
GER	
SDD	
RDA	
ROC	
DP	

STATE OF OKLAHOMA
DEPARTMENT OF HIGHWAYS
SURVEY DIVISION

Survey Division
Form No. 16
Rev. Sept. 10, 1961

FLOOD INFORMATION FORM

To be used in obtaining and transmitting flood water elevations for Survey Division office record files. This information to be obtained by all Chiefs of Party or others in their vicinity in times of unusual high water, or at any time available from a reliable source. The elevations can be recorded by level reading, by measurement from bridge floor, in relation to a house, above roadbed or any other dependable, clear manner that fits the situation, the highest order possible to be used. Separate report to be made on each crossing or place obtained.

County Gravim Date highwater occurred May 31, 1968

Highway number SH # 19 Name of stream N.A.

Direction and distance from nearest town, village or store 7.8 Miles East of SH # 19
From the JCT SH # 19 & SH # 59

Section, Township and Range Section 18 T 4 N R 2 W

Description of Location _____

Elevation N.A. Source of levels _____

Method obtained ^{Eng.} Y-Level Date obtained ? June 6, 1968

Did it appear to be normal medium extreme do not know

Was highwater mark obtained from actual water, drift, local resident, U. S. Engineers, etc.? Drift

Explanatory Remarks Extreme High Water is 2.0 Feet Above the "X" on S.W. Corner of South Headwall of Culvert. 7.8 Miles East on SH# 19 From the JCT SH # 19 & SH # 59

Location to be shown on back of this sheet as a check.

Field Note: To be sent to Survey Engineer

Paul J. Jurek
Chief of Party

June 7, 1968
Date

SWD - 8160J Level Books Discarded
Project - SAP 835 B

Location No. 9

R 3 W

R 2 W

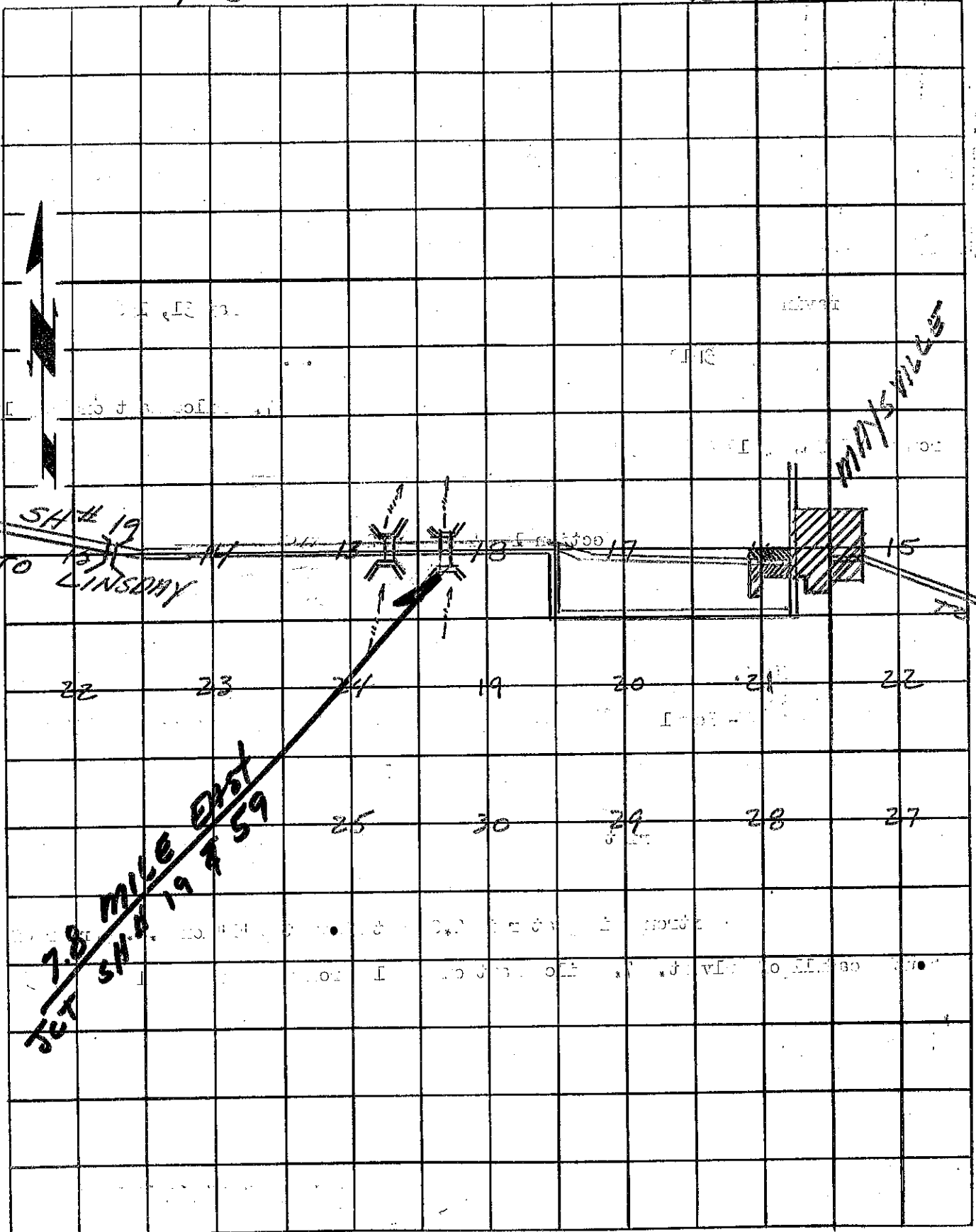

SH# 19
TO LINDSAY

MAYSVILLE

7.8 MILE EAST
JET SH# 19 & 59

T
4
N
P.V.

T
4
N