

STATE OF OKLAHOMA
DEPARTMENT OF HIGHWAYS
PLANS AND SURVEY DEPARTMENT

FLOOD INFORMATION FORM

To be used in obtaining and transmitting flood water elevations for Plans & Survey office record files. This information to be obtained by all Chiefs of Party in their vicinity in times of unusual high water, or at any time available from a reliable source. The elevations can be recorded by level reading, by measurement from bridge floor, in relation to a house, above roadbed or any other dependable, clear manner that fits the situation, the highest order possible to be used. Separate report to be made on each crossing or place obtained.

County Garvin Date highwater occurred May 10, 1950
Highway number S.H. 19 Name of stream Backwater from Beef Creek
Direction and distance from nearest town, village or store At the Jet
of S.H. 19 & Main St in Maysville

Section, Township and Range _____

Description of Location At Main Intersection in Maysville

Method obtained obtained from Policeman

Elevation 1.5 Above Main Intersect Source of levels _____

Was highwater mark obtained from actual water, drift, local resident, U. S. Engineers, etc? From Marks on Buildings and Was shown
us by Policeman in Maysville

Explanatory Remarks _____

Location to be shown on back of this sheet as a check.

Field Note: To be sent to Engr. of Plans & Survey (2 copy).
Office Note: To be filed in Flood Information by Counties.

C. S. Wortham
C. S. WORTHAM Chief of Party
Ass't. Engr. of Plans & Surveys
May 12, 1950
Date

Location No. 14

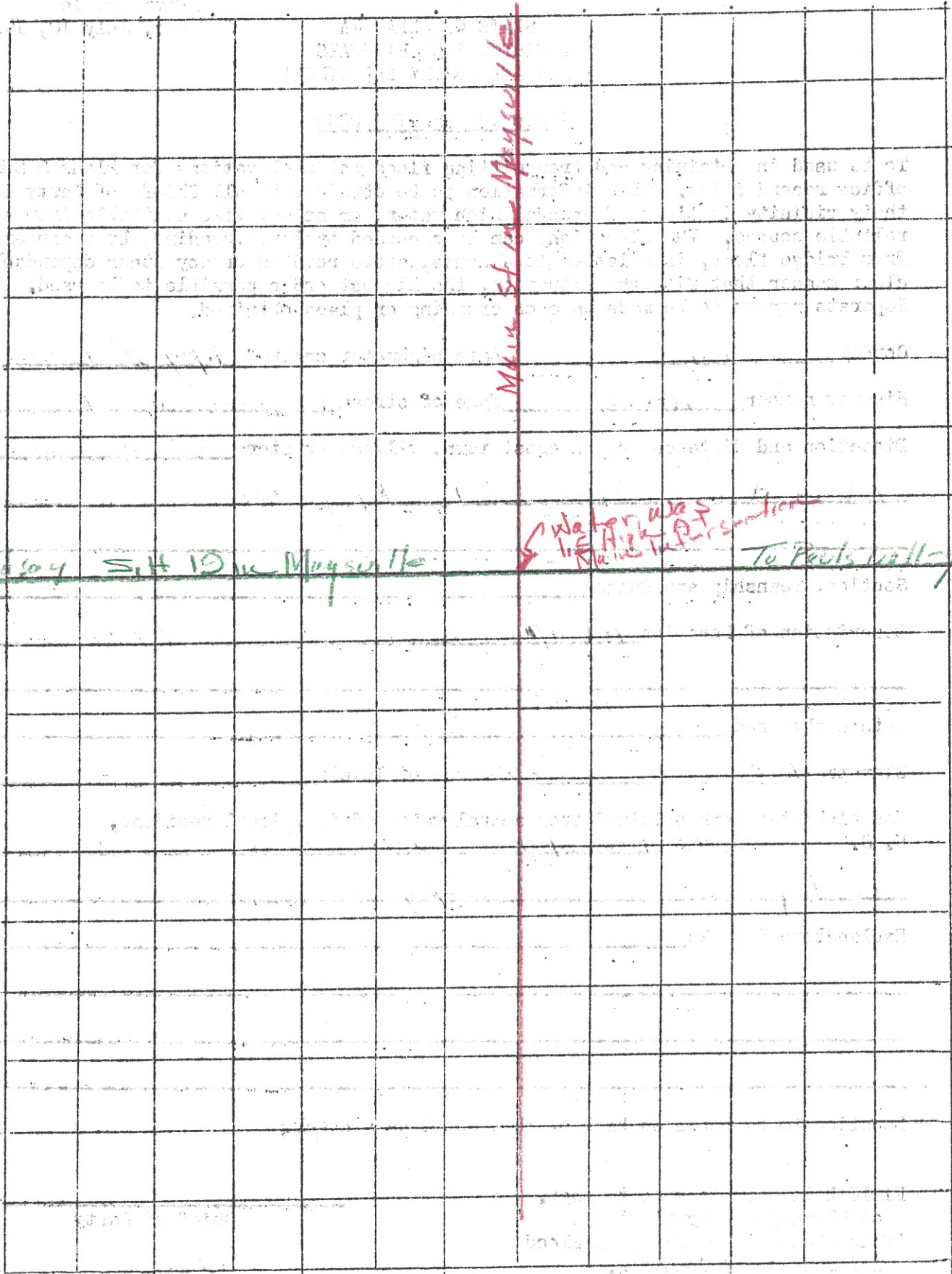

Main St in Maysville

Water was high at this time

To Kingsley S. H. 10 W. Maysville

To Pauls Valley

N