

SURVEY DIVISION	
GHS	
✓ WWV	6-14-68
✓ WNM	6-11-68
GWP	
✓ OCC	6-22-68
GER	
SDD	
RDA	
ROC	
DP	
IF	

STATE OF OKLAHOMA  
DEPARTMENT OF HIGHWAYS  
SURVEY DIVISION

Survey Division  
Form No. 16  
Rev. Sept. 10, 1961

FLOOD INFORMATION FORM

SURVEY DIVISION

To be used in obtaining and transmitting flood water elevations for Survey Division office record files. This information to be obtained by all Chiefs of Party or others in their vicinity in times of unusual high water, or at any time available from a reliable source. The elevations can be recorded by level reading, by measurement from bridge floor, in relation to a house, above roadbed or any other dependable, clear manner that fits the situation, the highest order possible to be used. Separate report to be made on each crossing or place obtained.

County Garvin Date highwater occurred May 31, 1968

Highway number SH # 19 Name of stream Beef Creek

Direction and distance from nearest town, village or store 0.60 Miles East on SH # 19

From the JCT SH # 19 & SH # 74 in Maysville

Section, Township and Range Section 15 T 4 N R 2 W

Description of Location \_\_\_\_\_

Elevation N. A. Source of levels \_\_\_\_\_

Method obtained Eng. Y-Level Date obtained June 7, 1968

Did it appear to be  normal  medium  extreme  do not know

Was highwater mark obtained from actual water, drift, local resident, U. S. Engineers, etc.? Drift

Explanatory Remarks Extreme High Water is 3.40 Below the "X" on the N.W. Wingwall of Bridge. 0.60 Miles east on SH # 19 From the JCT SH # 19 & SH # 74

Location to be shown on back of this sheet as a check.

Field Note: To be sent to  
Survey Engineer

James L. Linn  
Chief of Party

June 7, 1968

Date

*Note - Odd found bridge floor.*

*NOTE - ANOTHER REPORT OF SAME DATE*

*SWO - 7451) Level Books Discard/Project - FAP 217 c (2)  
Location No. 14*

R 2 W

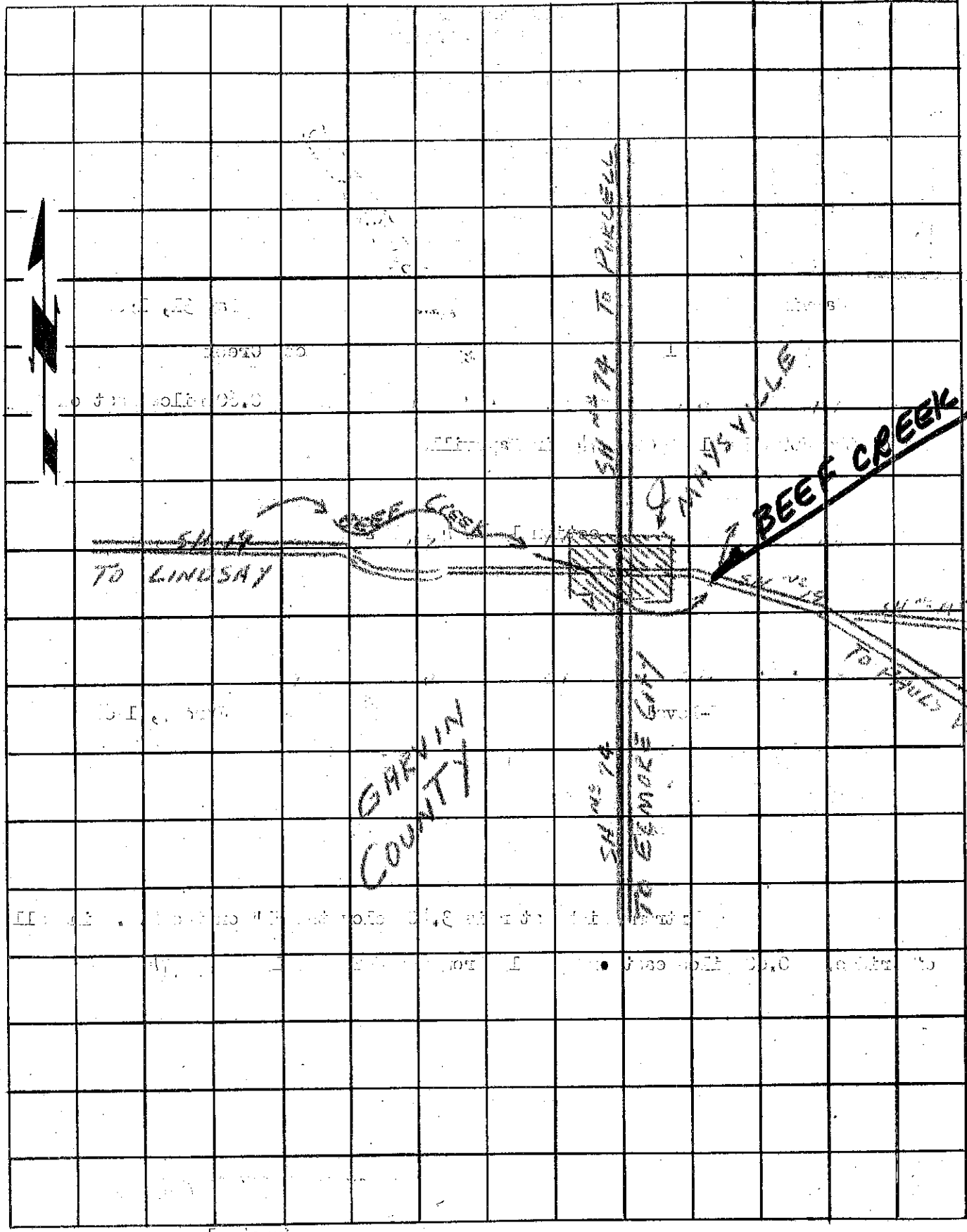

SH 474  
TO LINDSAY

SH 474 TO PIRELLA

SH 474 TO GEMORE CITY

BEEF CREEK

GARWIN  
COUNTY

T  
4  
N



TO HILLS VILLE