

STATE OF OKLAHOMA
DEPARTMENT OF HIGHWAYS
SURVEY DIVISION

Survey Division
Form No. 16
Rev. Sept. 10, 1961
JUN 10 1968
SURVEY DIVISION

FLOOD INFORMATION FORM

6-11-68
6-14-68
6-11-68
6-24-68
OCC
GER
SDD
RDA
ROC
DP
IF

To be used in obtaining and transmitting flood water elevations for Survey Division office record files. This information to be obtained by all Chiefs of Party or others in their vicinity in times of unusual high water, or at any time available from a reliable source. The elevations can be recorded by level reading, by measurement from bridge floor, in relation to a house, above roadbed or any other dependable, clear manner that fits the situation, the highest order possible to be used. Separate report to be made on each crossing or place obtained.

County Garvin Date highwater occurred May 31, 1968

Highway number SH # 74 Name of stream Beef Creek

Direction and distance from nearest town, village or store 0.30 Miles South on SH # 74. From the JCT of SH # 19 & SH # 74 in Maysville

Section, Township and Range East Side of Section 16 T 4 N R 2 W

Description of Location _____

Elevation _____ Source of levels _____

Method obtained Engr. Y-Level Date obtained June 6, 1968

Did it appear to be normal medium extreme do not know

Was highwater mark obtained from actual water, drift, local resident, U. S. Engineers, etc.? Drift

Explanatory Remarks Extreme High Water is 2.5 Feet Below the Center Line of the North End of Bridge Floor, 0.30 Miles South on SH # 74

Location to be shown on back of this sheet as a check.

Field Note: To be sent to Survey Engineer

Harold Turner
Chief of Party

June 7, 1968
Date

SND - 1743 (1)
Project - 5 706 (2)

Location No. 14

R 2 W

T 4 N

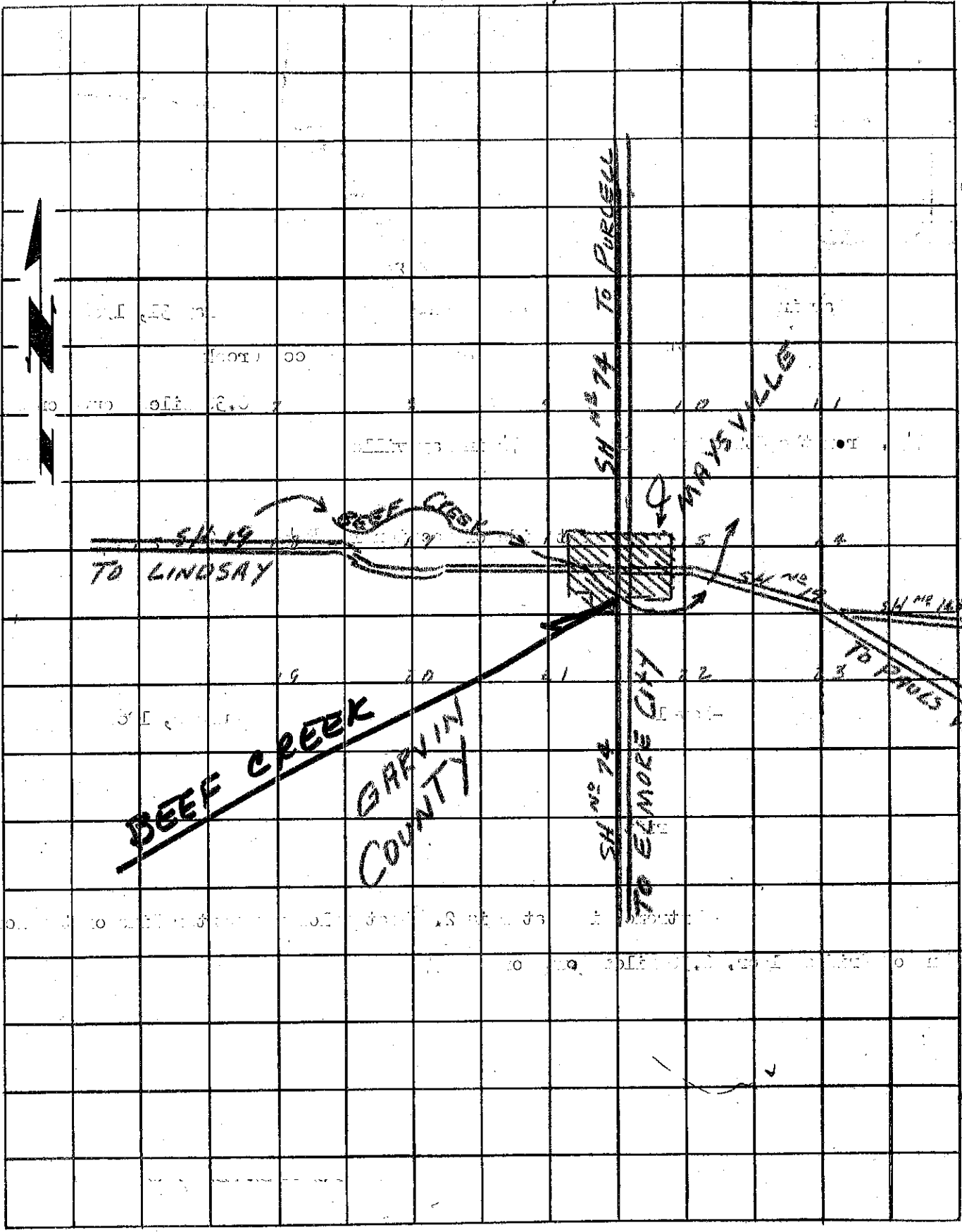

51, 52, 53