

OKLAHOMA STATE HIGHWAY COMMISSION
PLANS & SURVEYS DEPARTMENT

FLOOD INFORMATION FORM

To be used in obtaining and transmitting flood water elevations for Plans & Survey office record files. This information to be obtained by all Chiefs of Party in their vicinity in times of unusual high water. The elevations can be recorded by level reading, by measurement from bridge floor, in relation to a house, above roadbed or any other dependable, clear manner that fits the situation, the highest order possible to be used. Separate report to be made on each crossing or place obtained.

County Garvin Date June 4, 1947

Highway number S. H. 19 Name of ^{River} ~~Stream~~ Washita

Direction and distance from nearest town, village or store Approx.

1.5 miles east of Lindsay, on S. H. 19

Section, Township and Range Sec. 12 T-4-N R-4-W

Description of Location Bridge across Washita River on S. H. 19

1.5 miles East of Lindsay. A. T. & S. F. Railroad Bridge parallels Highway bridge approx. 200 feet North.

Method obtained Hugh S. Tennant party at bridge.

Was highwater mark obtained from actual water, drift, or local resident, explain Water mark obtained from clear water line left

on East end of bridge backwall. High Water Elev. 10.8 Lower than N. E. Bridge Seat.

Explanatory Remarks On June 3 the East approach to this bridge was washed out due to water getting behind the East Abutment.

Location to be shown on back of this sheet as a check.

Hugh S. Tennant
Chief of Party

June 4, 1947

Date

Field note: To be sent to Engr. of Plans & Surveys (one copy).
Office note: To be filed in Flood information by Counties.

Location No. 14A

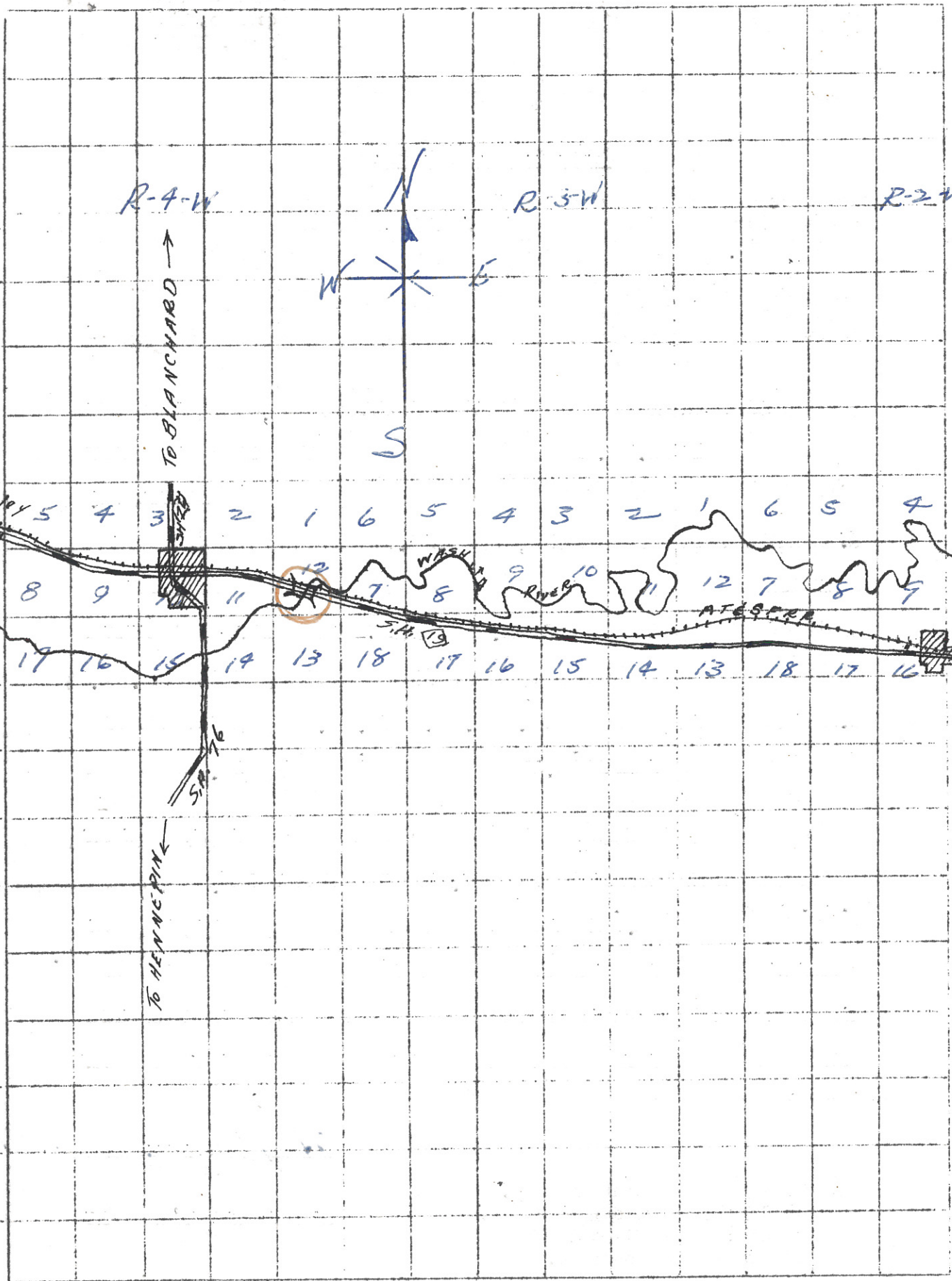

R-4-W

R-5-W

R-2-W

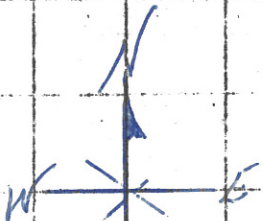

TO BLANCHARD →

S

TO BRADLEY ←

5 4 3 2 1 6 5 4 3 2 1 6 5 4

8 9 11 7 8 9 10 12 7 8 7

17 16 15 14 13 18 17 16 15 14 13 18 17 16

TO PAULS VALLEY →

TO HENNING PINK ↓

S.M. 13

WASHKA RIVER

ATE SPRING