

STATE OF OKLAHOMA
DEPARTMENT OF HIGHWAYS
PLANS AND SURVEY DEPARTMENT

FLOOD INFORMATION FORM

To be used in obtaining and transmitting flood water elevations for Plans & Survey office record files. This information to be obtained by all Chiefs of Party in their vicinity in times of unusual high water, or at any time available from a reliable source. The elevations can be recorded by level reading, by measurement from bridge floor, in relation to a house, above roadbed or any other dependable, clear manner that fits the situation, the highest order possible to be used. Separate report to be made on each crossing or place obtained.

County GARFIELD Date highwater occurred July 10, & 11, 1963

Highway number US 64 Name of stream Boggy Creek

Direction and distance from nearest town, village or store At South East Corner of Enid Oklahoma

Section, Township and Range Section Corner Common to Sections. 9-10-15 & 16
T-22-N - R-6-W

Description of Location At North end of Bridge across Boggy Creek 132.4 feet
South of above mentioned Section Corner.

Method obtained Level Rod. And Y- Level

Elevation 1176.57 Source of levels Mean Sea Level (USC & GS Datum)

Was highwater mark obtained from actual water, drift, local resident, U. S. Engineers, etc? Well defined water mark on North East wingwall of bridge. BM-(X) on NW corner of hub guard NE corner of bridge, BM Elev= 1179.77, Highwater mark 3.4 Feet below BM. Elev. = 1176.37. Observed by Myself on the Morning of July 11, 1963.

Explanatory Remarks Started Raining about 9:30 PM on the night of July 10, 1963

According to report Published in the Enid Daily Eagle July 11, 1963, Vance Air Force Base Reported 4.93 Inches at 3.55 AM. And The US Weather Bureau Observation Station At KCRC Radio Station, on the 6:00 AM Weather Report July 11, 1963 that time Reported 6.52 Inches of Rain.

Location to be shown on back of this sheet as a check.

Field Note: To be sent to Engr.
of Plans & Survey (1 copy).
Office Note: To be filed in Flood
Information by Counties.

Charles I. Hillis
Chief of Party
Location Engineer
July 29, 1963
Date

12-6-W

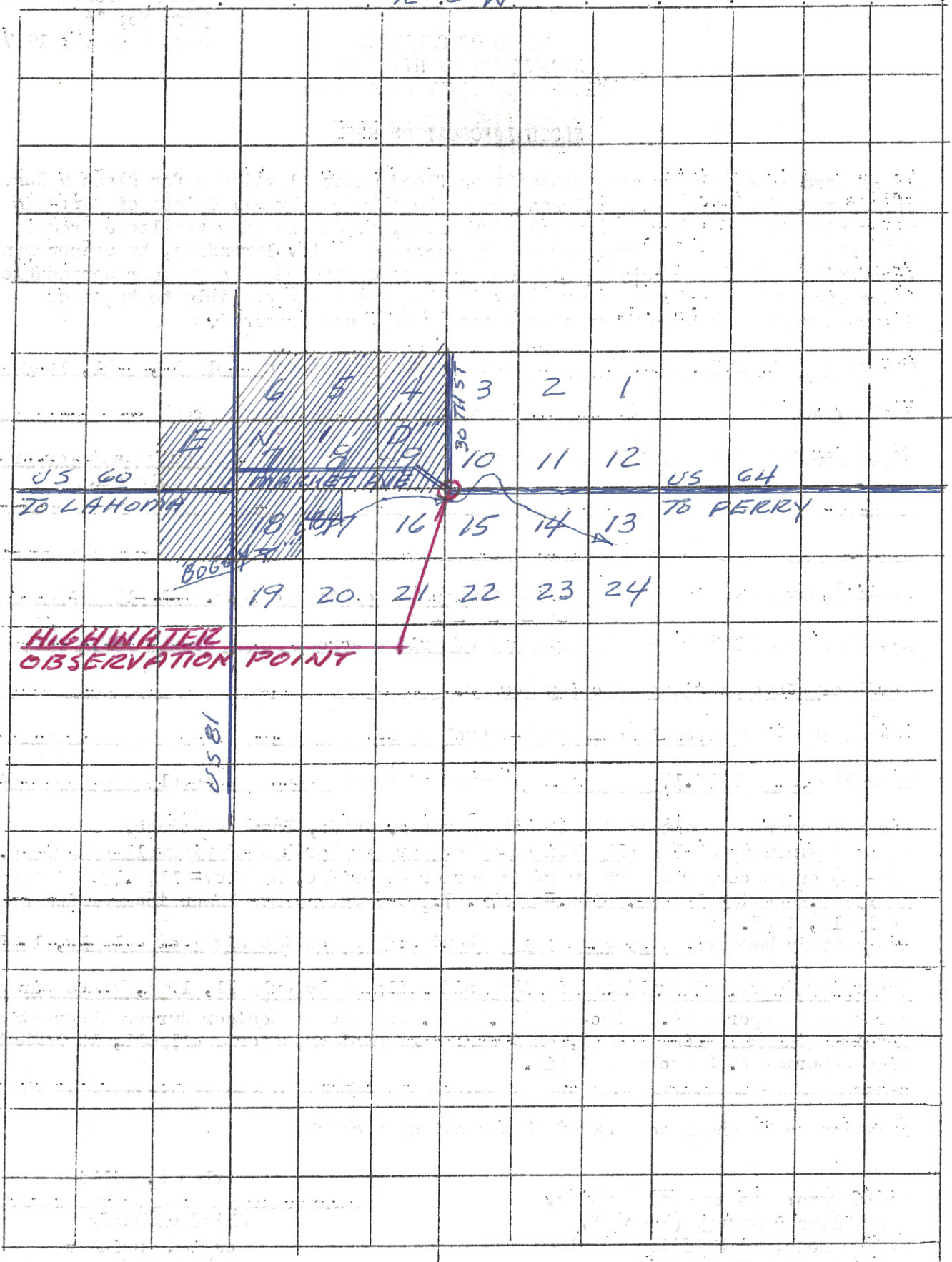

US 60
TO LAHONA

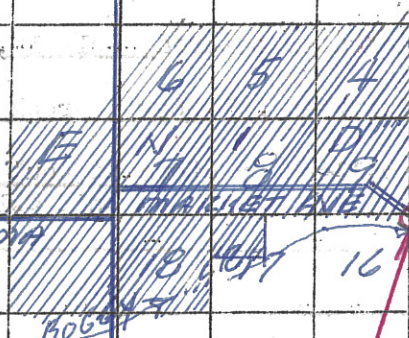

US 60

MARKET AVE

BOGGAN

HIGHWATER
OBSERVATION POINT

US 61

T
22
N

