

STATE OF OKLAHOMA
DEPARTMENT OF HIGHWAYS
SURVEY DIVISION

FLOOD INFORMATION FORM

To be used in obtaining and transmitting flood water elevations for Survey Division office record files. This information to be obtained by all Chiefs of Party or others in their vicinity in times of unusual high water, or at any time available from a reliable source. The elevations can be recorded by level reading, by measurement from bridge floor, in relation to a house, above roadbed or any other dependable, clear manner that fits the situation, the highest order possible to be used. Separate report to be made on each crossing or place obtained.

County Garfield Date highwater occurred October 11, 1973

Highway number S.H. 74 Name of stream Red Rock Creek

Direction and distance from nearest town, village or store _____

Approx. 5.7 Miles North on S.H. 74 North Jct S.H. 74 & FAS 2422 on S. Side Garber.

Section, Township and Range Between Sec. 35 & 36 T-24-N, R-4-W.

Description of Location 2-10X3 RGB.

Elevation Up 1.7 from West Hdwl. Source of levels _____

Method obtained Fennel Level Date obtained October 17, 1973

Did it appear to be normal medium extreme do not know

Was highwater mark obtained from actual water, drift, local resident, U. S. Engineers, etc.? _____

Water Line where Water Crossed S.H. 74 .

Explanatory Remarks _____

Location to be shown on back of this sheet as a check.

Field Note: To be sent to
Survey Engineer

Gene Provolt - Location Engineer
Chief of Party

October 17, 1973

Date

Location No 9

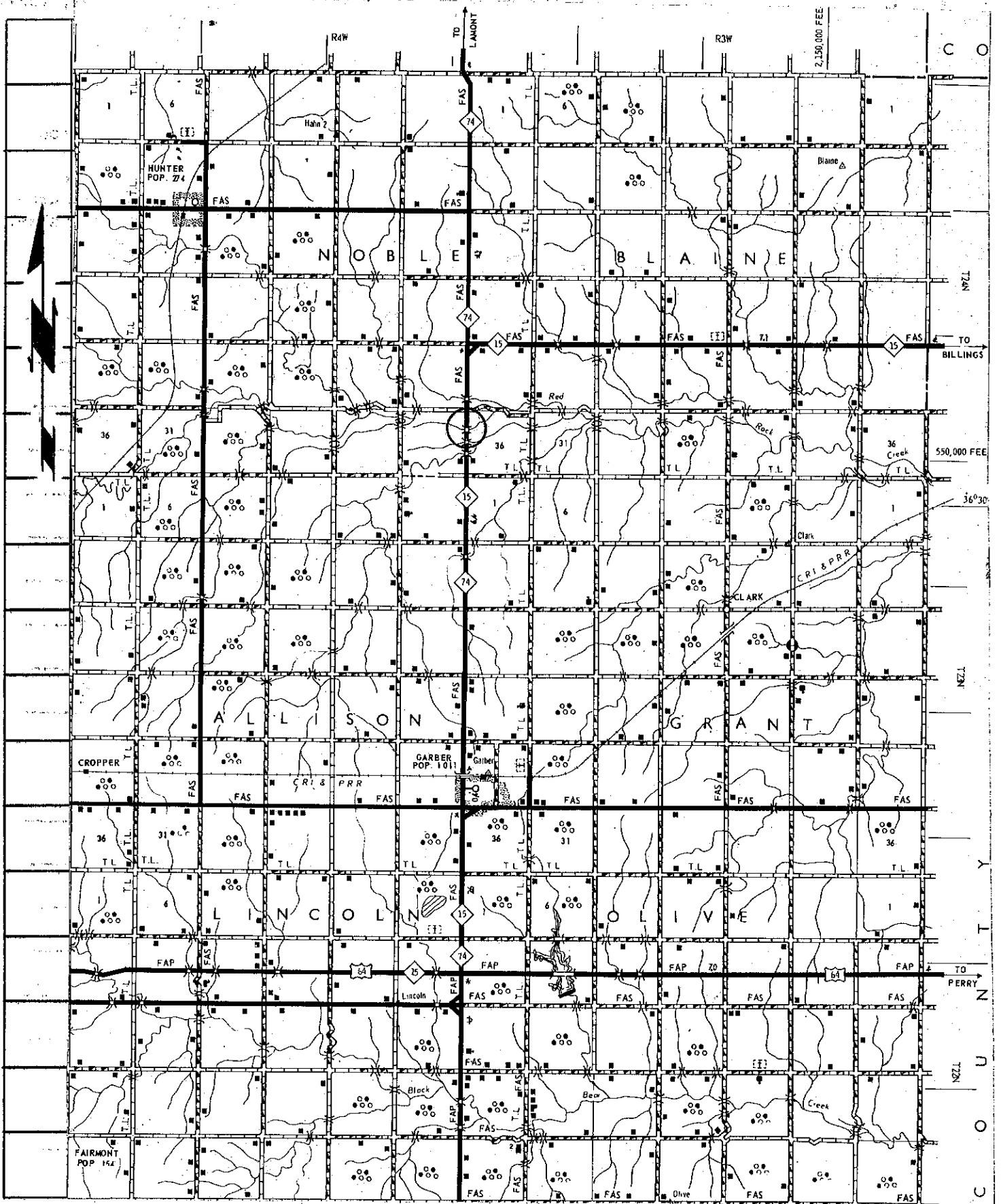

Boone County, Missouri

2,500,000 FEE

C O

TZN

TO BILLINGS

550,000 FEE

36°30'

TZN

Y

TO PERRY

TZN

C O



HUNTER POP. 274
Hahn
Noble
Blaine
Red
Rock
36 Creek
Clark
CROPPER
GARBER POP. 101
Garber
LINCOLN
OLIVE
Lincoln
Block
Bear
FAIRMONT POP. 142
Olive
Creek

TO LAMONT

RdW

R3W

74

74

15

74

74

74

74

74

74

6

6

6

6

6

6

6

6

6

6

6

6

6

6

31

31

31

31

31

31

31

31

31

31

31

31

31

31

36

36

36

36

36

36

36

36

36

36

36

36

36

36

1

1

1

1

1

1

1

1

1

1

1

1

1

1

15

15

15

15

15

15

15

15

15

15

15

15

15

15

74

74

74

74

74

74

74

74

74

74

74

74

74

74

15

15

15

15

15

15

15

15

15

15

15

15

15

15

74

74

74

74

74

74

74

74

74

74

74

74

74

74

15

15

15

15

15

15

15

15

15

15

15

15

15

15

74

74

74

74

74

74

74

74

74

74

74

74

74

74

15

15

15

15

15

15

15

15

15

15

15

15

15

15

74

74

74

74

74

74

74

74

74

74

74

74

74

74

15

15

15

15

15

15

15

15

15

15

15

15

15

15

74

74

74

74

74

74

74

74

74

74

74

74

74

74

C O

TZN

TO BILLINGS

550,000 FEE

36°30'

TZN

Y

TO PERRY

TZN

C O