

**OKLAHOMA DEPARTMENT OF TRANSPORTATION  
SURVEY DIVISION**

**FLOOD INFORMATION FORM**

<b>Division #:</b>	1 <input type="checkbox"/> 2 <input type="checkbox"/> 3 <input type="checkbox"/> 4 X 5 <input type="checkbox"/> 6 <input type="checkbox"/> 7 <input type="checkbox"/> 8 <input type="checkbox"/>
<b>County:</b>	Garfield
<b>Date Highwater occurred:</b>	07/01/2007
<b>Highway Number:</b>	U.S.-81
<b>Name of Stream:</b>	Unnamed
<b>Direction and distance from nearest town, or highway junction</b>	Waukomis go south 2 mile
<b>Section, Township, Range:</b>	SEC 25 & 36, T-21-N R-7-W/ SEC 31 &30, T-21-N R-7-W
<b>Description of Location:</b>	Waukomis go south 2 mile U.S.-81
<b>Highwater Elevation:</b>	1248.22
<b>Level Datum &amp; Source:</b>	NAVD29 FAP M.A.F.-124(115)
<b>Method used:</b>	Digital Level
<b>Date Elevation Obtained:</b>	07/03/2007
<b>Apparent Magnitude:</b>	Normal <input type="checkbox"/> Medium X Extreme <input type="checkbox"/> Don't Know <input type="checkbox"/>
<b>Was Highwater Mark obtained from actual water, drift, local resident, or other source?</b>	Obtained from O.D.O.T. employee
<b>Explanatory Remarks:</b>	After many days of rain

Note: Show Vicinity Map on back of form

Name (signature) *Ron D. Seim*  
 Name (Printed) Ron D. Seim  
 Date: 7-24-07

Survey Division  
 Form No. 16  
 Revised: 5/09/2007

LOCATION No. 64

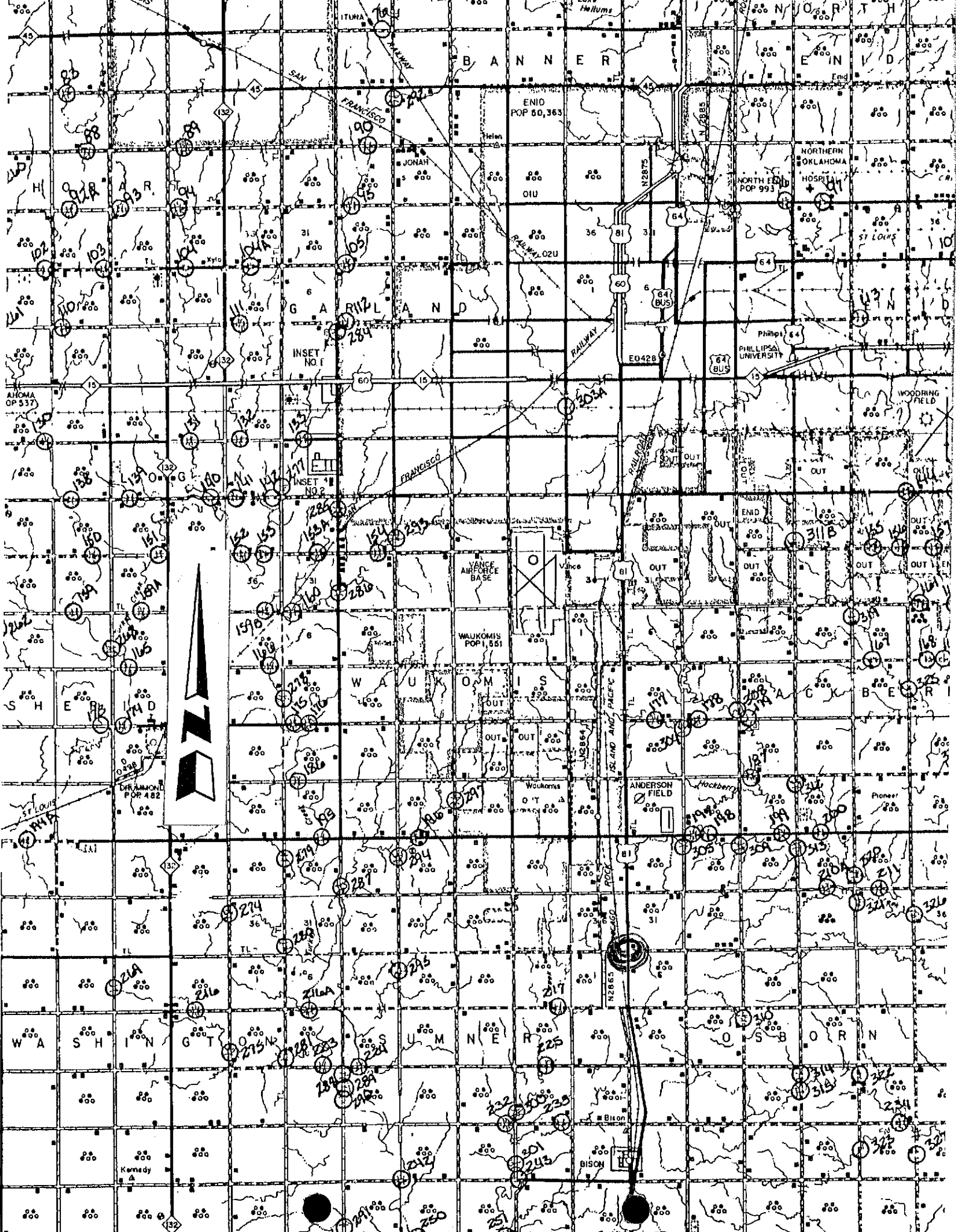

BANNER

ENID  
POP 60,363

G A I R L A N D

INSET NO 1

INSET NO 2

FRANCISCO

VICE AIR FORCE BASE

W A U K O M I S  
POP 1,551

W A U K O M I S

ANDERSON FIELD

OKLAHOMA  
OP 537

ST LOUIS  
MO

DRAMMOND  
POP 482



S H E R B O R N

W A S H I N G T O N

Kennedy

U M N E R

B I S O N

NORTHERN OKLAHOMA  
HOSPITAL

PHILLIPS UNIVERSITY

ENID

ANDERSON FIELD

Pioneer

O S B O R N

B I S O N

JOHNS

RAILWAY

RAILWAY

RAILWAY

RAILWAY

RAILWAY

RAILWAY

RAILWAY

RAILWAY

RAILWAY

RAILWAY

RAILWAY

RAILWAY

RAILWAY

RAILWAY

RAILWAY

RAILWAY

RAILWAY

RAILWAY

RAILWAY

RAILWAY

RAILWAY

N 2875

N 2875

N 2875

N 2875

N 2875

N 2875

N 2875

N 2875

N 2875

N 2875

N 2875

N 2875

N 2875

N 2875

N 2875

N 2875

N 2875

N 2875

N 2875

N 2875

N 2875

N 2875

N 2875

N 2875

N 2875

N 2875

N 2875

N 2875

N 2875

N 2875

N 2875

N 2875

N 2875

N 2875

N 2875

N 2875

N 2875

N 2875

N 2875

N 2875

N 2875

N 2875

N 2875

N 2875

N 2875

N 2875

N 2875

N 2875

N 2875

N 2875

N 2875

N 2875

N 2875

N 2875

N 2875

N 2875

N 2875

N 2875

N 2875

N 2875

N 2875

N 2875

N 2875

N 2875

N 2875

N 2875

N 2875

N 2875

N 2875

N 2875

N 2875

N 2875

N 2875

N 2875

N 2875

N 2875

N 2875

N 2875

N 2875

N 2875

N 2875

N 2875

N 2875

N 2875

N 2875

N 2875

N 2875

N 2875

N 2875

N 2875

N 2875

N 2875

N 2875

N 2875

N 2875

N 2875

N 2875

N 2875

N 2875

N 2875

N 2875

N 2875

N 2875

N 2875

N 2875

N 2875

N 2875

N 2875

N 2875

N 2875

N 2875

N 2875

N 2875

N 2875

N 2875

N 2875

N 2875

N 2875

N 2875

N 2875

N 2875

N 2875

N 2875

N 2875

N 2875

N 2875

N 2875

N 2875

N 2875

N 2875

N 2875

N 2875

N 2875

N 2875

N 2875

N 2875

N 2875

N 2875

N 2875

N 2875

N 2875

N 2875

N 2875

N 2875

N 2875

N 2875

N 2875

N 2875

N 2875

N 2875

N 2875

N 2875

N 2875

N 2875

N 2875

N 2875

N 2875

N 2875

N 2875

N 2875

N 2875

N 2875

N 2875

N 2875

N 2875

N 2875

N 2875

N 2875

N 2875

N 2875

N 2875

N 2875

N 2875

N 2875

N 2875

N 2875

N 2875

N 2875

N 2875

N 2875

N 2875

N 2875

N 2875

N 2875

N 2875

N 2875

N 2875

N 2875

N 2875

N 2875

N 2875

N 2875

N 2875

N 2875

N 2875

N 2875

N 2875

N 2875

N 2875

N 2875

N 2875

N 2875

N 2875

N 2875

N 2875

N 2875

N 2875

N 2875

N 2875

N 2875

N 2875

N 2875

N 2875

N 2875

N 2875

N 2875

N 2875

N 2875

N 2875

N 2875

N 2875

N 2875

N 2875

N 2875

N 2875

N 2875

N 2875

N 2875

N 2875

N 2875

N 2875

N 2875

N 2875

N 2875

N 2875

N 2875

N 2875

N 2875

N 2875

N 2875

N 2875

N 2875

N 2875

N 2875

N 2875

N 2875

N 2875

N 2875

N 2875

N 2875

N 2875

N 2875

N 2875

N 2875

N 2875

N 2875

N 2875

N 2875

N 2875

N 2875

N 2875

N 2875

N 2875

N 2875

N 2875

N 2875

N 2875