

STATE OF OKLAHOMA
DEPARTMENT OF HIGHWAYS
SURVEY DIVISION

FLOOD INFORMATION FORM

To be used in obtaining and transmitting flood water elevations for Survey Division office record files. This information to be obtained by all Chiefs of Party or others in their vicinity in times of unusual high water, or at any time available from a reliable source. The elevations can be recorded by level reading, by measurement from bridge floor, in relation to a house, above roadbed or any other dependable, clear manner that fits the situation, the highest order possible to be used. Separate report to be made on each crossing or place obtained.

County DEWEY Date highwater occurred 5-16-82

Highway number S.H. 3 Name of stream DRAIN

Direction and distance from nearest town, village or store 6.4 MILES SOUTHEAST OF SEILING, OKLA. ON S.H. 3

Section, Township and Range SEC. 31, T-19-N, R-15-W

Description of Location STRUCTURE AT STA. 791+65 ON USWP PROJ. NO. W.P.H. 281 "A" PLANS.

Elevation 1898.8 Source of levels STATE HIGHWAY PLANS NO. W.P.H. 281 "A"

Method obtained LEVEL Date obtained 5-20-82

Did it appear to be normal medium extreme do not know

Was highwater mark obtained from actual water, drift, local resident, U. S. Engineers, etc.? DRIFT & LOCAL RESIDENT

Explanatory Remarks THIS H.W. MARK IS 0.1' ABOVE PAVT. AT STRUCTURE, BUT APPROX. 400' NORTHWEST OF STRUCTURE WATER RUNS 1.2' OVER PAVT.

THIS EXT. H.W. OCCURRED AFTER HEAVY RAINS ON MAY 15 & 16, 1982.

Location to be shown on back of this sheet as a check.

Field Note: To be sent to
Survey Engineer

Dewey Walden
Location Engineer

MAY 20, 1982

Date

Location No. 2

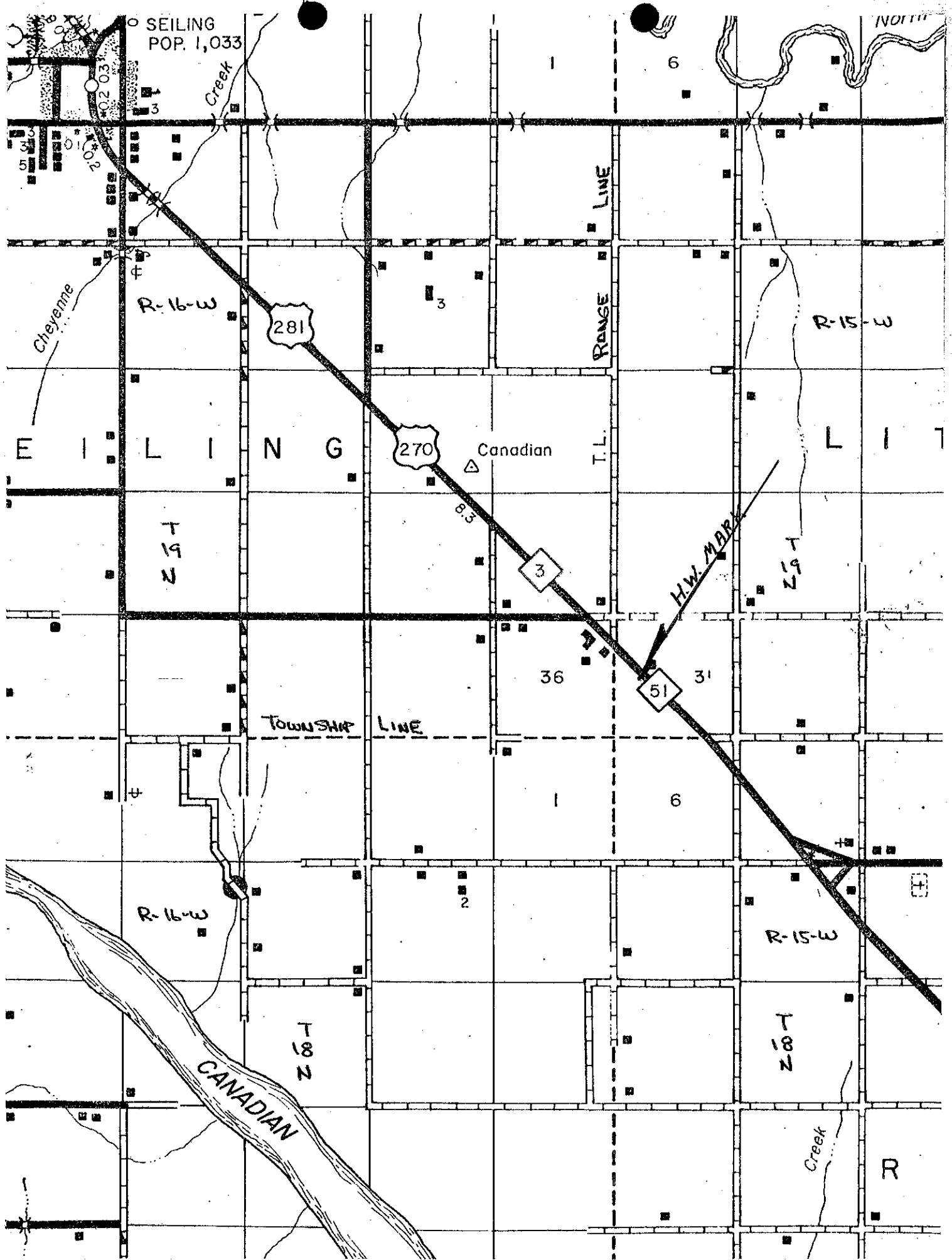

SEILING
POP. 1,033

NORTH

Creek

Cheyenne

R-16-W

281

RANGE
LINE

R-15-W

E I L I N G

270

Canadian

T.L.

L I T

T
19
N

8.3

3

HW. MARK

36

51

31

TOWNSHIP
LINE

R-16-W

2

1

6

R-15-W

CANADIAN

T
18
N

T
18
N

Creek

R