

STATE OF OKLAHOMA
DEPARTMENT OF HIGHWAYS
SURVEY DIVISION

FLOOD INFORMATION FORM

To be used in obtaining and transmitting flood water elevations for Survey Division office record files. This information to be obtained by all Chiefs of Party or others in their vicinity in times of unusual high water, or at any time available from a reliable source. The elevations can be recorded by level reading, by measurement from bridge floor, in relation to a house, above roadbed or any other dependable, clear manner that fits the situation, the highest order possible to be used. Separate report to be made on each crossing or place obtained.

County DEWEY Date highwater occurred MAY 9, 1993

Highway number U.S. 60 Name of stream DRAIN

Direction and distance from nearest town, village or store 1.2 MILES WEST OF SEILING, OKLAHOMA. ALONG U.S. 60

Section, Township and Range BETWEEN SECTIONS 6 & 7 T-19-N, R-16-W

Description of Location DRIFT & H.W. MARK 2.5' ABOVE HDWL.

Elevation 1473.1 Source of levels F.A.P. NO. 356 "C" (2) U.S. 60 1940 PLANS

Method obtained HAND GUN Date obtained MAY 11, 1993

Did it appear to be : normal medium extreme do not know

Was highwater mark obtained from actual water, drift, local resident, U. S. Engineers, etc.? DRIFT & COUNTY FOREMAN

Explanatory Remarks 3" RAIN FELL IN A 2 DAY PERIOD

Location to be shown on back of this sheet as a check.

Field Note: To be sent to
Survey Engineer

G.P. Strutton
PROFESSIONAL LAND SURVEYOR

Date
MAY 14 1993

COPY TO BRIDGE

Location No. 5

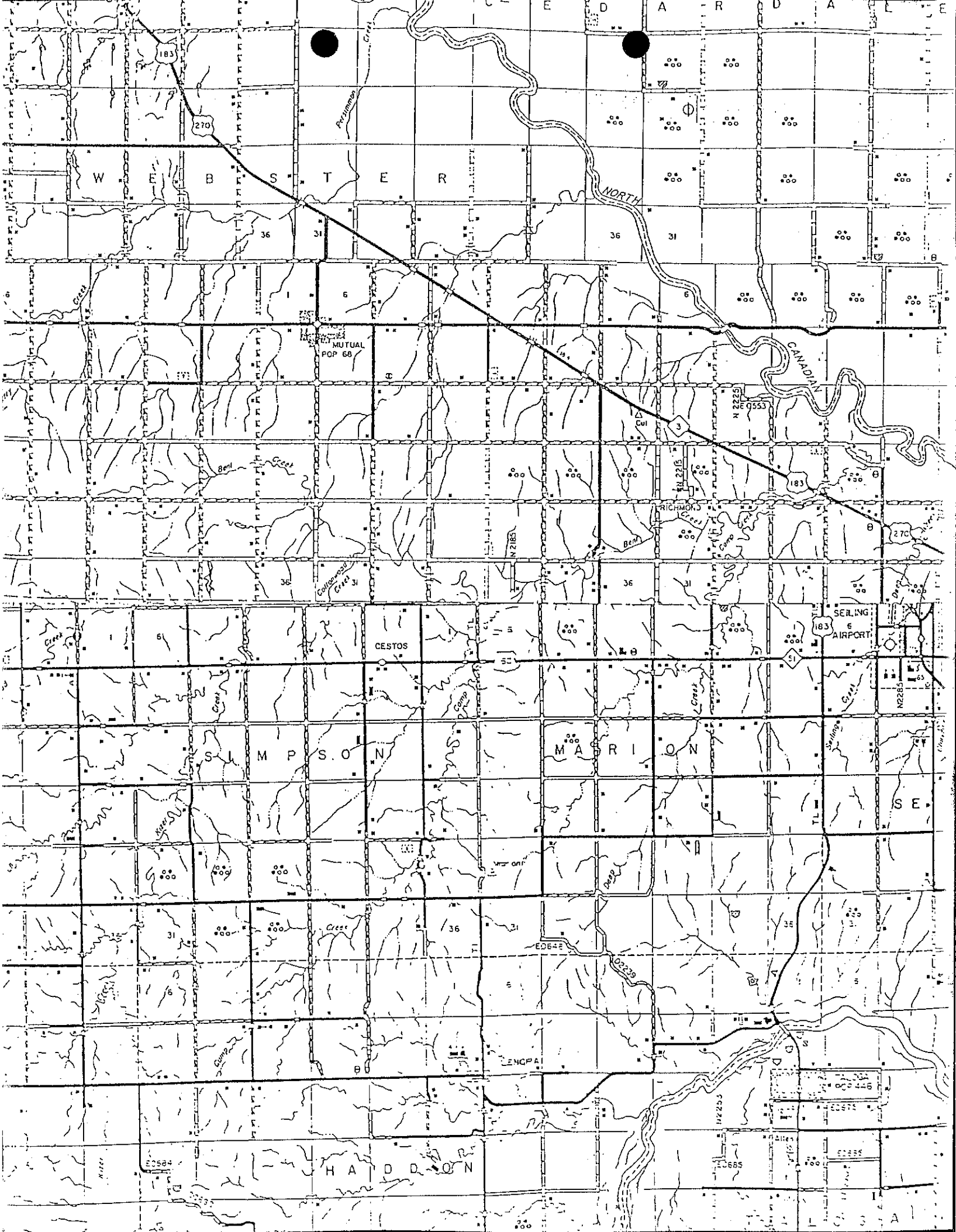

183
270

W E B S T E R

NORTH

MUTUAL
POP 68

RICHMOND

SERLING
AIRPORT

S I M P S O N

M A S O N

H A D D O N

S E

A