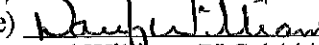

OKLAHOMA DEPARTMENT OF TRANSPORTATION  
SURVEY DIVISION

FLOOD INFORMATION FORM

Division #:	1 <input type="checkbox"/> 2 <input type="checkbox"/> 3 <input type="checkbox"/> 4 <input type="checkbox"/> 5 <input checked="" type="checkbox"/> 6 <input type="checkbox"/> 7 <input type="checkbox"/> 8 <input type="checkbox"/>
County:	Dewey
Date Highwater occurred:	6/ 14 / 07
Highway Number:	U.S. 270
Name of Stream:	None
Direction and distance from nearest town, or highway junction	1.5 Miles S.E. of Jct. U.S. 270 & U.S. 60
Section, Township, Range:	SECTION 16 T-19-N, R-16-W
Description of Location:	Approximately 2' above the N.E. Hdwl.
Highwater Elevation:	1759.4
Level Datum & Source:	F.A.P. No. FR-281(40) U.S. 270 plans 1976
Method used:	LEVEL
Date Elevation Obtained:	6 / 18 / 07
Apparent Magnitude:	Normal <input type="checkbox"/> Medium <input checked="" type="checkbox"/> Extreme <input type="checkbox"/> Don't Know <input type="checkbox"/>
Was Highwater Mark obtained from actual water, drift, local resident, or other source?	DRIFT AND WATER MARK
Explanatory Remarks:	Heavy rain over night.

Note: Show Vicinity Map on back of form

Name (signature)   
Name (Printed) Daryl Williams PLS 1444  
Date: 6/24/07, 2007

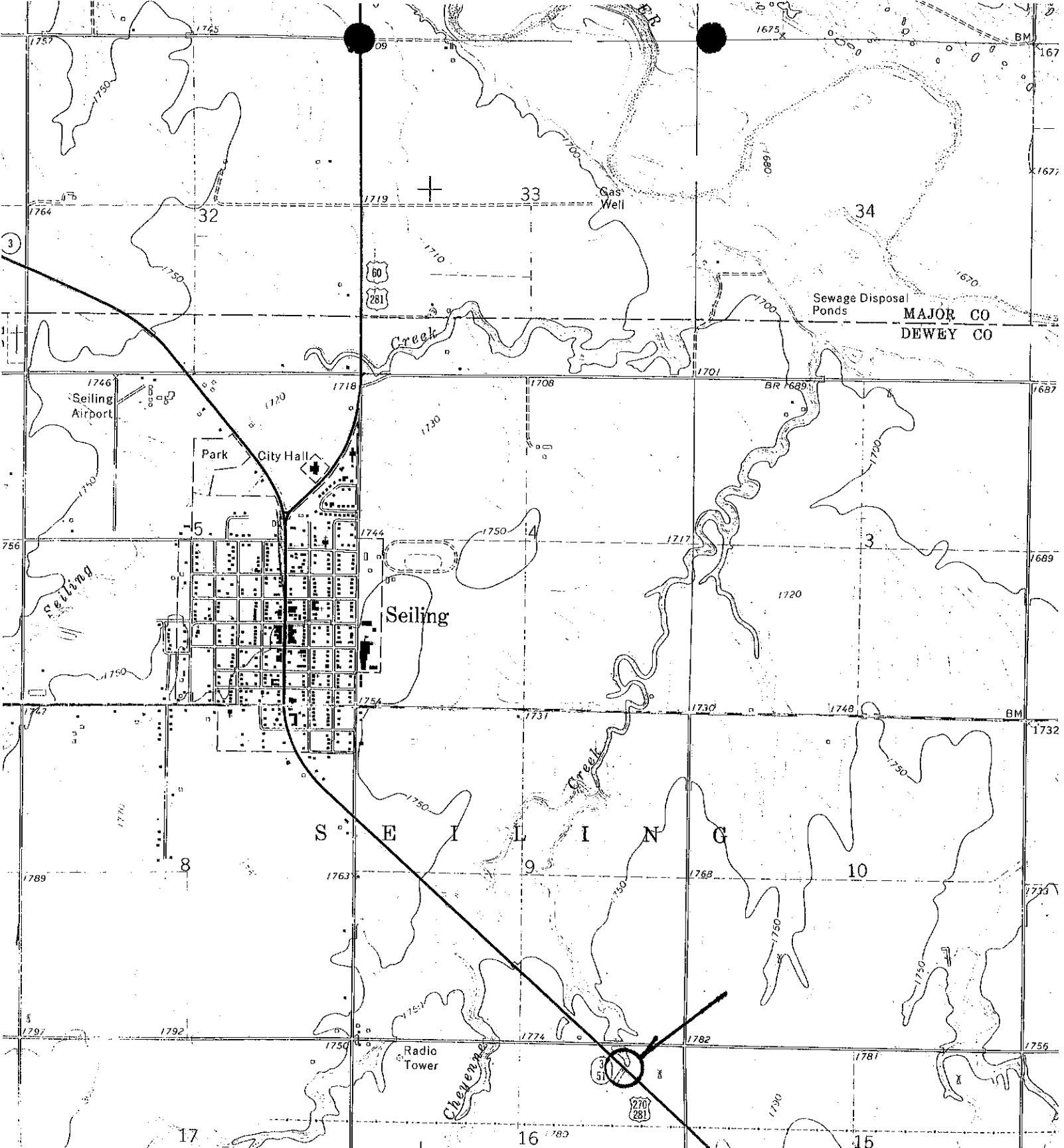

GALOGA  
256 III SW  
E 1:24 000

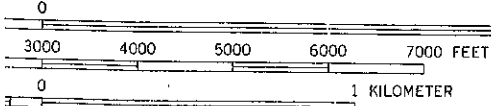

INTERVAL 10 FEET  
MEAN SEA LEVEL

OAKWOOD 18 MI.  
WATONGA 35 MI.

● INTERIOR—GEOLOGICAL SURVEY, WASHIN

ROAD CLASSIFICATIO

- Primary highway, hard surface
- Secondary highway, hard surface
- Light-duty improved
- Unimprov
- Interstate Route
- U. S. Route

