

RECEIVED

APR 17 1995

SURVEY
DIVISION

STATE OF OKLAHOMA
DEPARTMENT OF HIGHWAYS
SURVEY DIVISION

FLOOD INFORMATION FORM

Survey Division
Form No. 16
Rev. Dec. 2, 1974

To be used in obtaining and transmitting flood water elevations for Survey Division office record files. This information to be obtained by all Chiefs of Party or others in their vicinity in times of unusual high water, or at any time available from a reliable source. The elevations can be recorded by measurement from bridge floor, in relation to a house, above roadbed or any other dependable, clear manner that fits the situation, the highest order possible to be used. Separate report to be made on each crossing of place obtained.

County DELAWARE Date of highwater occurred 12-15-92

Highway number SH 127 Name of stream Drowning Creek

Direction and distance from nearest town, village or store. Approx. 2.5 miles west along SH 127 from the Federal Building in Jay.

Section, Township and Range Sec. 15 T-15-N, R-23-E

Description of Location At the crossing of US 127 & Drowning Creek.

Elevation _____ Source of levels _____

Method obtained Visual Observation Date obtained 12-15-92

Highwater appeared to be extreme

Was highwater mark obtained from actual water, drift, local resident, U.S. Engineers, etc.? Actual water marks and residue.

Explanatory Remarks Shot SW corner S. HDWL. read 6.03 on HDWL. & read 4.90 on highest visible water marks and residue.

Location to be shown on back of this sheet as a check.

Field Note: To be sent to Survey Engineer

5-1-95 Copy to Bridge Division

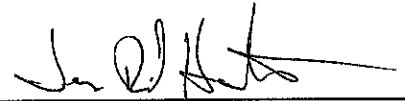

Location Engineer

4-13-95

Date

LOCATION No. 4

APR 17 1995

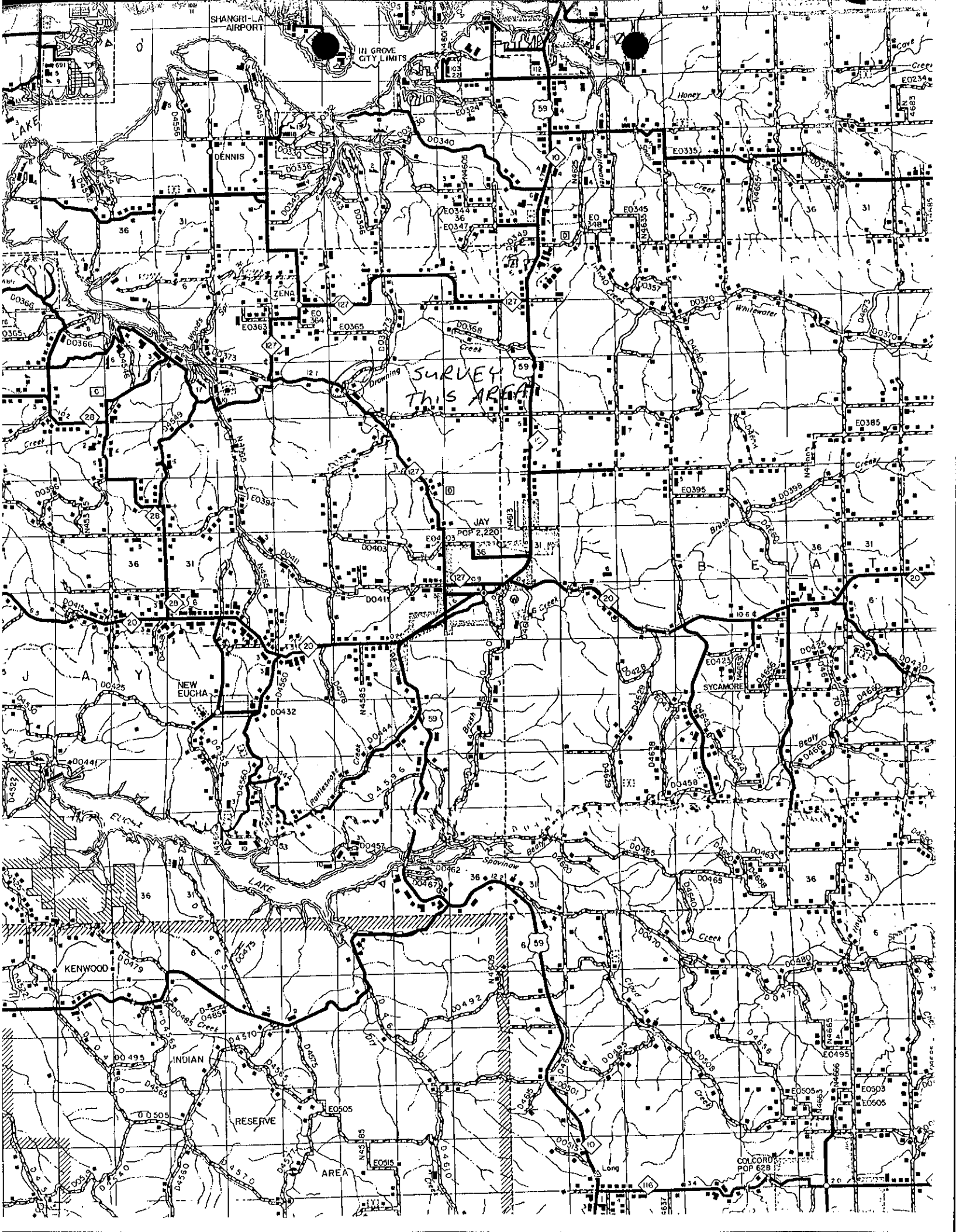

SHANGRI-LA AIRPORT

IN GROVE CITY LIMITS

LAKE

DENNIS

ZENA

SURVEY THIS AREA

JAY

NEW EUCHA

SYCAMORE

KENWOOD

INDIAN

RESERVE

AREA

COLCORD

681

112

E0234

00336

00366

00340

E0335

00366

00366

00340

E0335

00366

00366

00340

E0335

00366

00366

00340

E0335

00366

00366

00340

E0335

00366

00366

00340

E0335

00366

00366

00340

E0335

00366

00366

00340

E0335

00366

00366

00340

E0335

00366

00366

00340

E0335

00366

00366

00340

E0335

00366

00366

00340

E0335

00366

00366

00340

E0335

00366

00366

00340

E0335

00366

00366

00340

E0335

00366

00366

00340

E0335

00366

00366

00340

E0335

00366

00366

00340

E0335

00366

00366

00340

E0335

00366

00366

00340

E0335

00366

00366

00340

E0335

00366

00366

00340

E0335

00366

00366

00340

E0335

00366

00366

00340

E0335

00366

00366

00340

E0335

00366

00366

00340

E0335

00366

00366

00340

E0335

00366

00366

00340

E0335

00366

00366

00340

E0335

00366

00366

00340

E0335

00366

00366

00340

E0335

00366

00366

00340

E0335

00366

00366

00340

E0335

00366

00366

00340

E0335

00366

00366

00340

E0335

00366

00366

00340

E0335

00366

00366

00340

E0335

00366

00366

00340

E0335

00366

00366

00340

E0335

00366

00366

00340

E0335

00366

00366

00340

E0335

00366

00366

00340

E0335

00366

00366

00340

E0335

00366

00366

00340

E0335

00366

00366

00340

E0335

00366

00366

00340

E0335

00366

00366

00340

E0335

00366

00366

00340

E0335

00366

00366

00340

E0335

00366

00366

00340

E0335

00366

00366

00340

E0335

00366

00366

00340

E0335

00366

00366

00340

E0335

00366

00366

00340

E0335

00366

00366

00340

E0335

00366

00366

00340

E0335

00366

00366

00340

E0335

00366

00366

00340

E0335

00366

00366

00340

E0335

00366

00366

00340

E0335

00366

00366

00340

E0335

00366

00366

00340

E0335

00366

00366

00340

E0335

00366

00366

00340

E0335

00366

00366

00340

E0335

00366

00366

00340

E0335

00366

00366

00340

E0335

00366

00366

00340

E0335

00366

00366

00340

E0335

00366

00366

00340

E0335

00366

00366

00340

E0335

00366

00366

00340

E0335

00366

00366

00340

E0335

00366

00366

00340

E0335

00366

00366

00340

E0335

00366

00366

00340

E0335

00366

00366

00340

E0335