

STATE OF OKLAHOMA
DEPARTMENT OF HIGHWAYS
SURVEY DIVISION

FLOOD INFORMATION FORM

To be used in obtaining and transmitting flood water elevations for Survey Division office record files. This information to be obtained by all Chiefs of Party or others in their vicinity in times of unusual high water, or at any time available from a reliable source. The elevations can be recorded by level reading, by measurement from bridge floor, in relation to a house, above roadbed or any other dependable, clear manner that fits the situation, the highest order possible to be used. Separate report to be made on each crossing or place obtained.

County CUSTER Date highwater occurred JUNE 7, 1989

Highway number U.S. 183 Name of stream WASHITA RIVER

Direction and distance from nearest town, village or store NORTH EDGE OF CLINTON,
OKLAHOMA ON U.S. 183.

Section, Township and Range SECTION 11, T-12-N, R-17-W

Description of Location HIGHWATER ROSE TO 14.7 BELOW BRIDGE SEAT AT NORTH END
OF BRIDGE.

Elevation 1492.2 Source of levels F.A.P. NO. 333A PLANS

Method obtained HAND LEVEL Date obtained JUNE 12, 1989

Did it appear to be normal medium extreme do not know

Was highwater mark obtained from actual water, drift, local resident,
U. S. Engineers, etc.? WATER LINE ON PIER.

Explanatory Remarks _____

Location to be shown on back of this sheet as a check.

Field Note: To be sent to
Survey Engineer

David H. Leffingwell
Location Engineer

6-7-89
Date

LOCATION No. 1

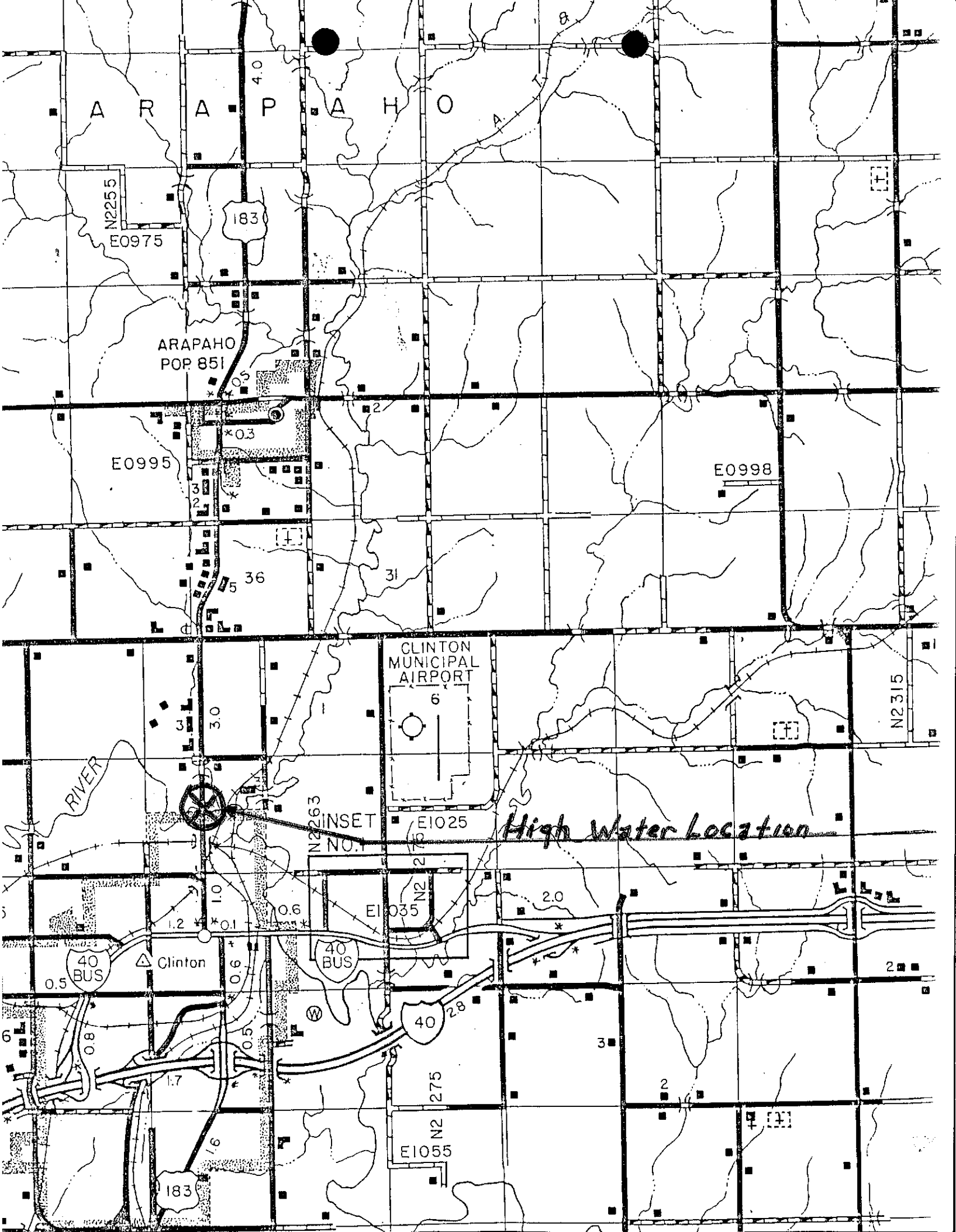

A R A P A H O

ARAPAHO
POP 851

CLINTON
MUNICIPAL
AIRPORT

RIVER

High Water Location

Clinton

40
BUS

40

183

E1055

E1025

E1035

N2255
E0975

E0995

E0998

N2315

N2263
INSET
NO. 1

N2275

[3]