

Plans & Survey Dept.
Form No. 16
Rev. July 10, 1947

STATE OF OKLAHOMA
DEPARTMENT OF HIGHWAYS
PLANS AND SURVEY DEPARTMENT

FLOOD INFORMATION FORM

To be used in obtaining and transmitting flood water elevations for Plans & Survey office record files. This information to be obtained by all Chiefs of Party in their vicinity in times of unusual high water, or at any time available from a reliable source. The elevations can be recorded by level reading, by measurement from bridge floor, in relation to a house, above roadbed or any other dependable, clear manner that fits the situation, the highest order possible to be used. Separate report to be made on each crossing or place obtained.

County CUSTER Date highwater occurred Oct 4, 1955

Highway number US 66 Name of stream _____

Direction and distance from nearest town, village or store 7.8 miles
East of Pass at just East of N/4 Sec. line

Section, Township and Range SEC. 30 T 12N R 17W

Description of Location spot taken at 3-26 I Beam span
Bridge across creek

Method obtained Hand LEVEL & Rod

Elevation _____ Source of levels 5.7' Below top of
HUB GUARD.

Was highwater mark obtained from actual water, drift, local resident, U. S. Engineers, etc? DRIFT

Explanatory Remarks obtained by C.D. SON & T.W. Klein
on Oct. 5, 1955 - From drift & silt.

Location to be shown on back of this sheet as a check.

Field Note: To be sent to Engr. of Plans & Survey (1 copy).
Office Note: To be filed in Flood Information by Counties.

W. M. Lang
Chief of Party
10-13-55
Date

LOCATION NO 4

R 17 W

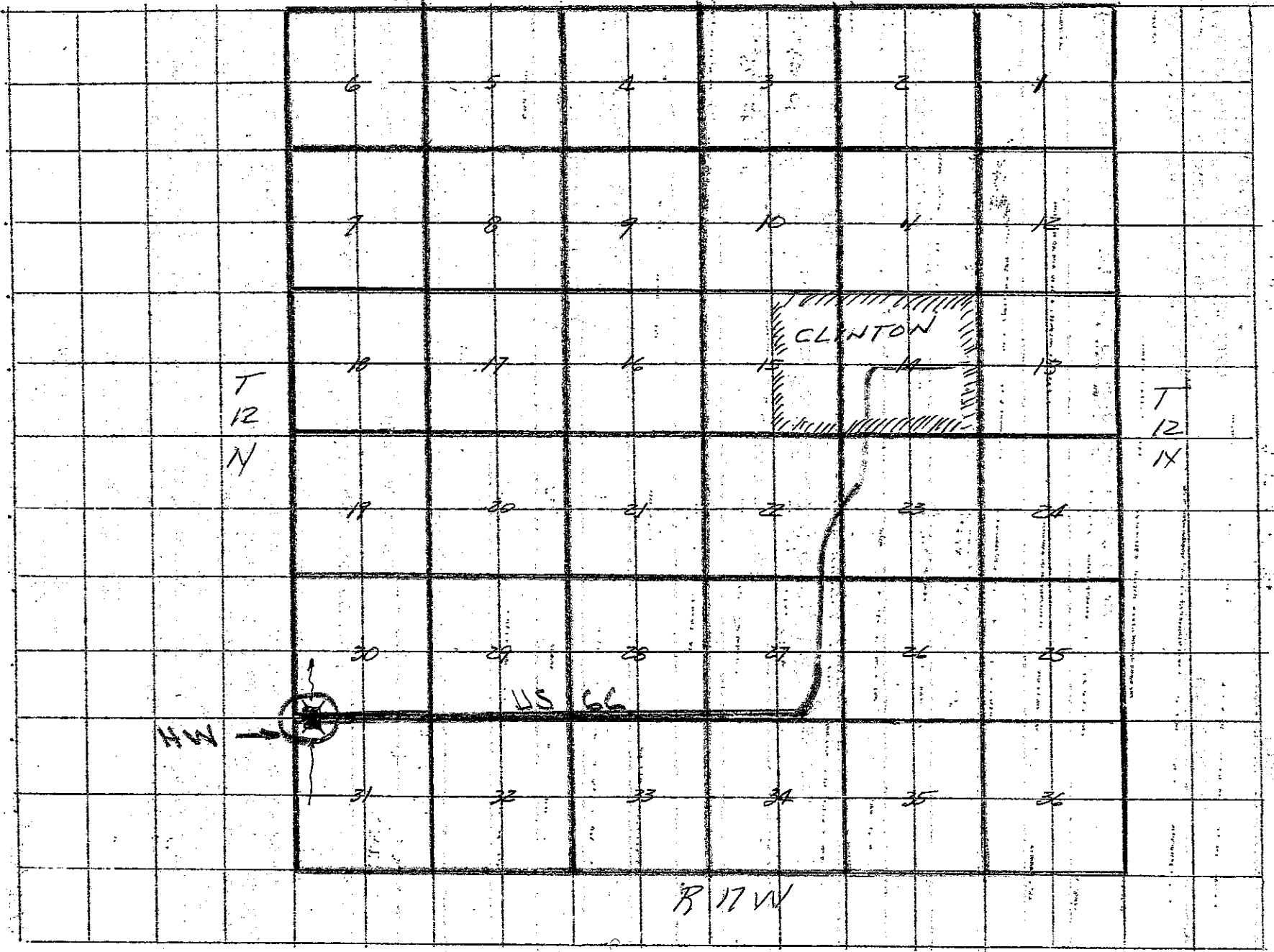

T
12
N

T
12
N

NW

US 66

R 17 W