

Plans & Survey Dept.
Form No. 16
Rev. July 10, 1947

STATE OF OKLAHOMA
DEPARTMENT OF HIGHWAYS
PLANS AND SURVEY DEPARTMENT

FLOOD INFORMATION FORM

To be used in obtaining and transmitting flood water elevations for Plans & Survey office record files. This information to be obtained by all Chiefs of Party in their vicinity in times of unusual high water, or at any time available from a reliable source. The elevations can be recorded by level reading, by measurement from bridge floor, in relation to a house, above roadbed or any other dependable, clear manner that fits the situation, the highest order possible to be used. Separate report to be made on each crossing or place obtained.

County Custer Date highwater occurred OCT 4 1955

Highway number US 66 Name of stream BEAR CREEK

Direction and distance from nearest town, village or store 6.3 miles
east of Clinton on US 66

Section, Township and Range SEC 13 T 12 N R 16 W

Description of Location shots taken at Bridge
across Bear Creek

Method obtained Hand Level

Elevation _____ Source of levels 5'8" Below top of
HUB GUARD

Was highwater mark obtained from actual water, drift, local resident, U. S. Engineers, etc? Drift

Explanatory Remarks Obtained by C.D. San & T.W. Klein
on Oct 5, 1955 - From drift & silt

Location to be shown on back of this sheet as a check.

Field Note: To be sent to Engr. of Plans & Survey (1 copy).
Office Note: To be filed in Flood Information by Counties.

W.A. McLaughlin
Chief of Party
10-13-55
Date

LOCATION NO. 7

T
12
N

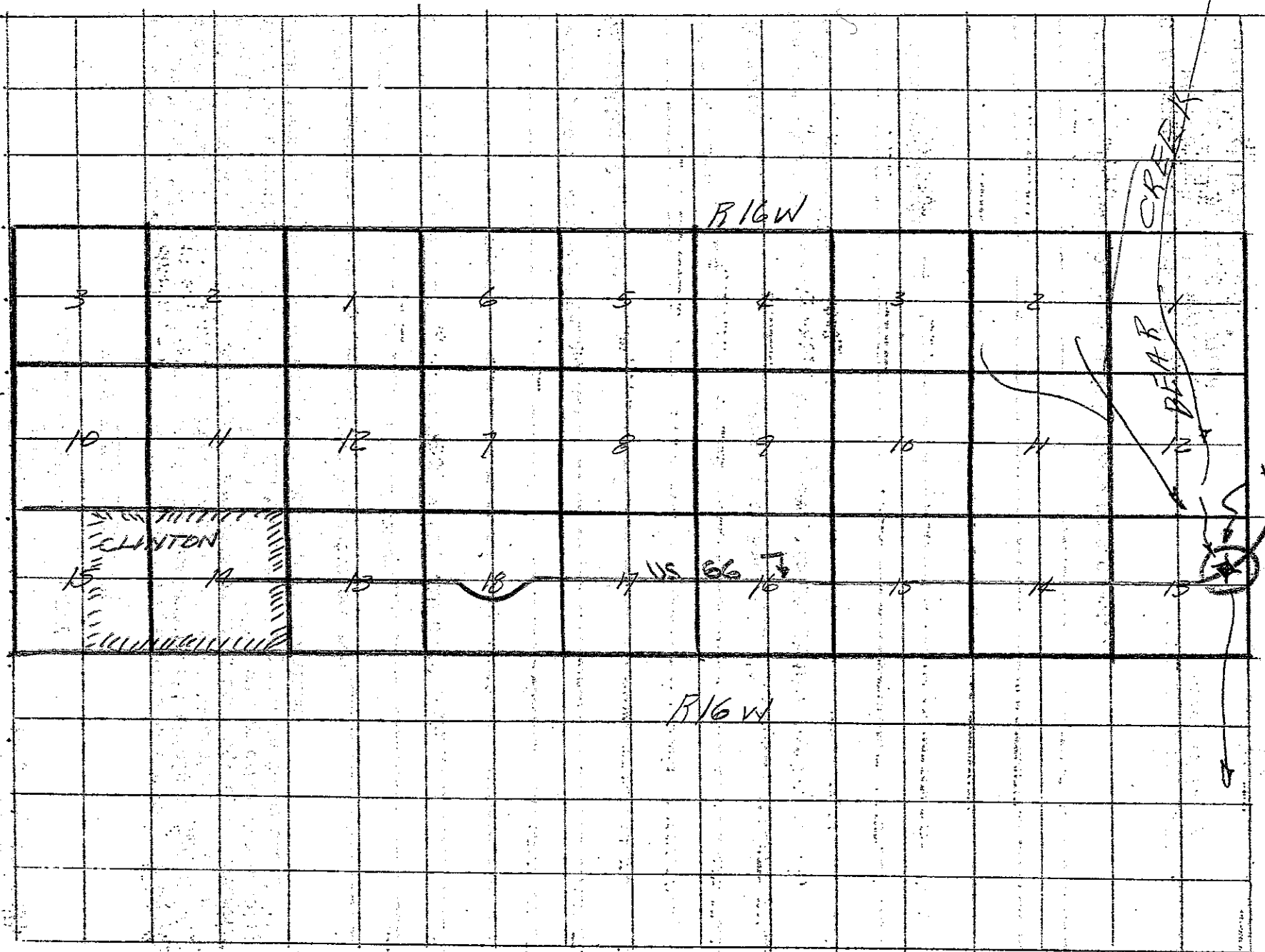

R16W

DEAR CREEK

T
12
N
H.W.

CLINTON

US 66

R16W

