

STATE OF OKLAHOMA
DEPARTMENT OF HIGHWAYS
SURVEY DIVISION

FLOOD INFORMATION FORM

To be used in obtaining and transmitting flood water elevations for Survey Division office record files. This information to be obtained by all Chiefs of Party or others in their vicinity in times of unusual high water, or at any time available from a reliable source. The elevations can be recorded by level reading, by measurement from bridge floor, in relation to a house, above roadbed or any other dependable, clear manner that fits the situation, the highest order possible to be used. Separate report to be made on each crossing or place obtained.

County CUSTER Date highwater occurred 6-7-89

Highway number I-40 Name of stream WASHITA RIVER

Direction and distance from nearest town, village or store _____

1.0 MILE EAST OF CLINTON, OKLA. ON I-40

Section, Township and Range SECTION 24, T-12-N. R-17-W

Description of Location _____

Elevation 1475.8 Source of levels BR. SEAT ELEV. = 1489.84
F.A.P. NO. I-40-2(60) 065 PLANS

Method obtained HAND LEVEL Date obtained 6-12-89

Did it appear to be normal medium extreme do not know

Was highwater mark obtained from actual water, drift, local resident, U. S. Engineers, etc.? WATER LINE ON PIER

Explanatory Remarks WATER LINE ON PIER WAS 14.0 BELOW BRIDGE SEAT.

Location to be shown on back of this sheet as a check.

Field Note: To be sent to
Survey Engineer

Bernard L. Hoffmann
Location Engineer

6-7-89
Date

LOCATION No. 17

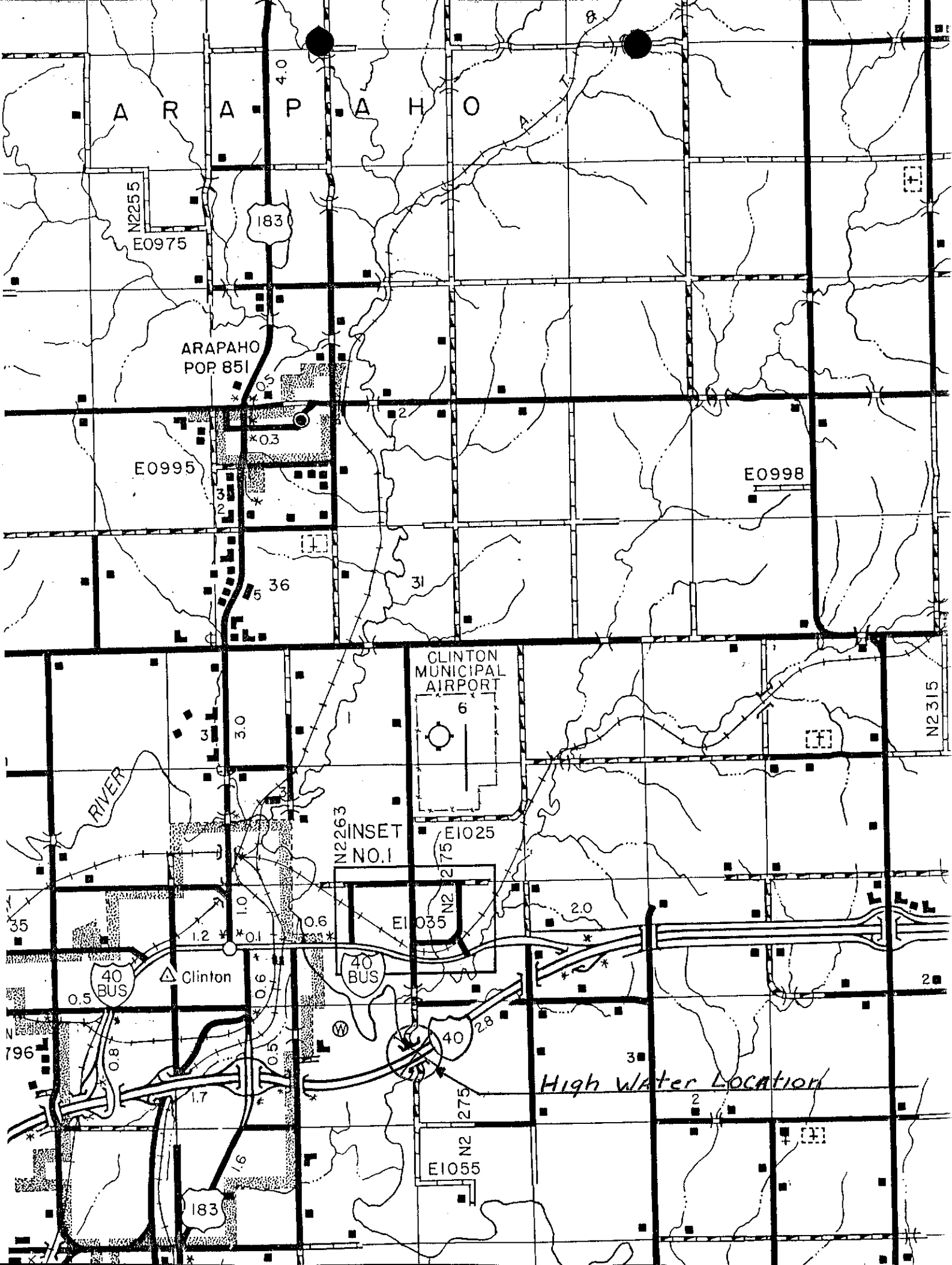

ARAPAHO

183

N2255

E0975

ARAPAHO
POP 851

E0995

E0998

CLINTON MUNICIPAL
AIRPORT

N2315

N2263
INSET
NO. 1

E1025

E1035

N2275

40
BUS

Clinton

40
BUS

40

High Water Location

N2275
E1055

183

N796