

STATE OF OKLAHOMA  
DEPARTMENT OF HIGHWAYS  
SURVEY DIVISION

Survey Division  
Form No. 16  
Rev. Sept. 10, 1961

FLOOD INFORMATION FORM

To be used in obtaining and transmitting flood water elevations for Survey Division office record files. This information to be obtained by all Chiefs of Party or others in their vicinity in times of unusual high water, or at any time available from a reliable source. The elevations can be recorded by level reading, by measurement from bridge floor, in relation to a house, above roadbed or any other dependable, clear manner that fits the situation, the highest order possible to be used. Separate report to be made on each crossing or place obtained.

County            Creek            Date highwater occurred Sept 5, 1971

Highway number Alt. US 75 Name of stream Unknown

Direction and distance from nearest town, village or store 0.50 mile south of  
Mounds Okla.

Section, Township and Range Sec. 17 T-16-N R-12-E

Description of Location 0.50 miles south of Mounds, Okla.

Elevation            Source of levels           

Method obtained Survey Party Y-Level Date obtained Sept 7, 1971

Did it appear to be  normal  medium  extreme  do not know

Was highwater mark obtained from actual water, drift, local resident, U. S. Engineers, etc.? Drift - Up 2.0' from south end of bridge.

Explanatory Remarks Water approximately 1.5' deep over road

Location to be shown on back of this sheet as a check.

Field Note: To be sent to  
Survey Engineer

*Lucy E. Enginbarham*  
Chief of Party

Sept. 7, 1971  
Date

*LOCATION NOT*

R-12-E

CREEK

COUNTY

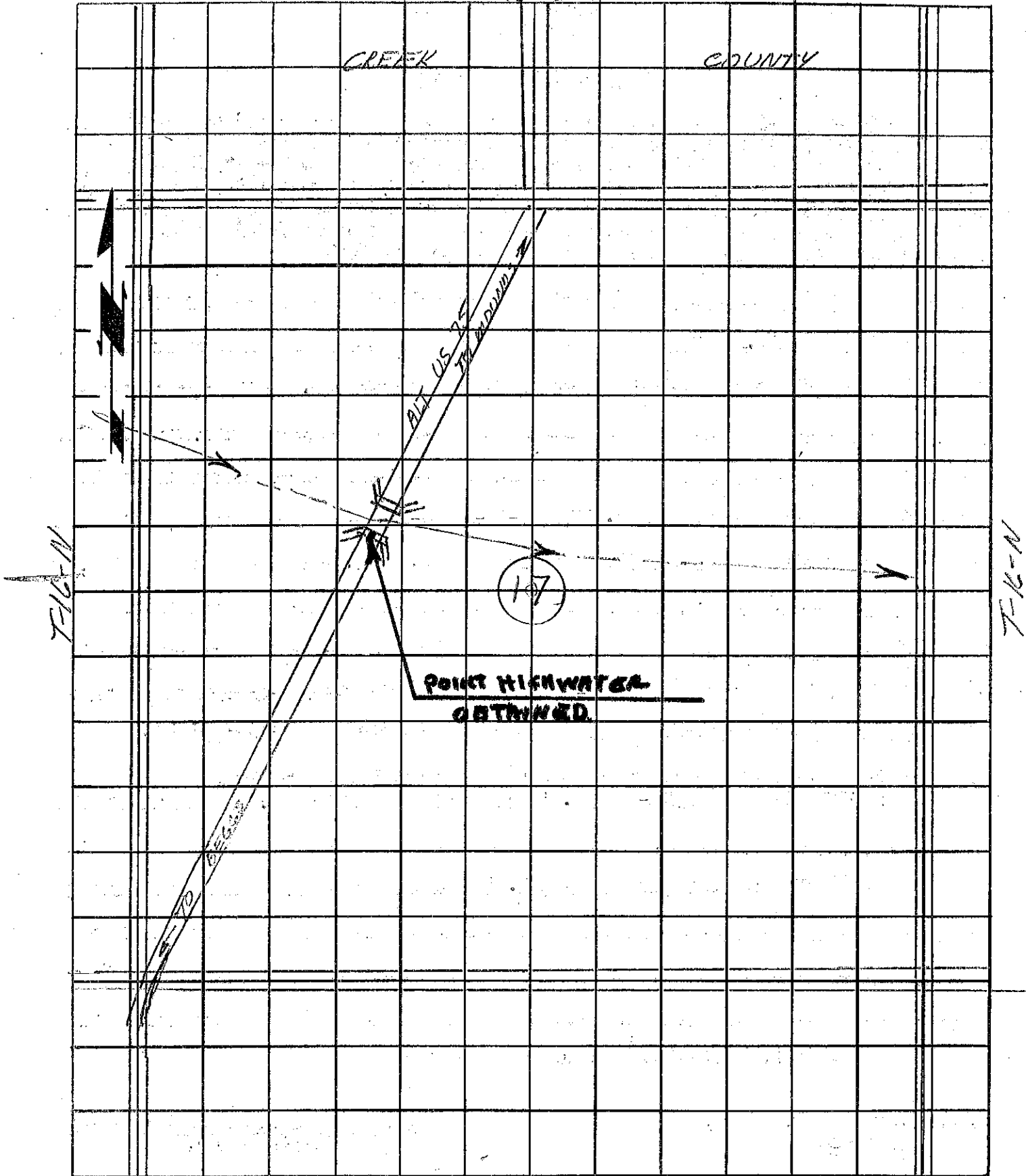

R-12-E