

RECEIVED

APR 17 1995

SURVEY
DIVISION

STATE OF OKLAHOMA
DEPARTMENT OF HIGHWAYS
SURVEY DIVISION

Survey Division
Form No. 16
Rev. Dec. 2, 1974

FLOOD INFORMATION FORM

To be used in obtaining and transmitting flood water elevations for Survey Division office record files. This information to be obtained by all Chiefs of Party or others in their vicinity in times of unusual high water, or at any time available from a reliable source. The elevations can be recorded by level reading, by measurement from bridge floor, in relation to a house, above roadbed or any other dependable, clear manner that fits the situation, the highest order possible to be used. Separate report to be made on each crossing or place obtained.

County Creek Date highwater occurred 12-15-92

Highway number US 75a Name of stream Duck Creek

Direction and distance from nearest town, village or store 1.7 miles south along US 75a. From the jct. of US 75a and 13th street at mounds.

Section, Township and Range

Description of Location At the crossing of US 75a and Duck Creek.

Elevation Source of levels

Method obtained Visual Observation Date obtained 12-15-92

Did it appear to be normal medium extreme do not know

Was highwater mark obtained from actual water, drift, local resident, U. S. Engineers, etc.? Actual water marks and residue.

Explanatory Remarks water was down 3.1 from the top of the S.W. bridge seat.

Location to be shown on back of this sheet as a check.

Field Note: To be sent to
Survey Engineer

Jim D. Hetta
Location Engineer

4/13/95
Date

5-1-95 Copy to Bridge Division

LOCATION No. 1 APR 17 1995

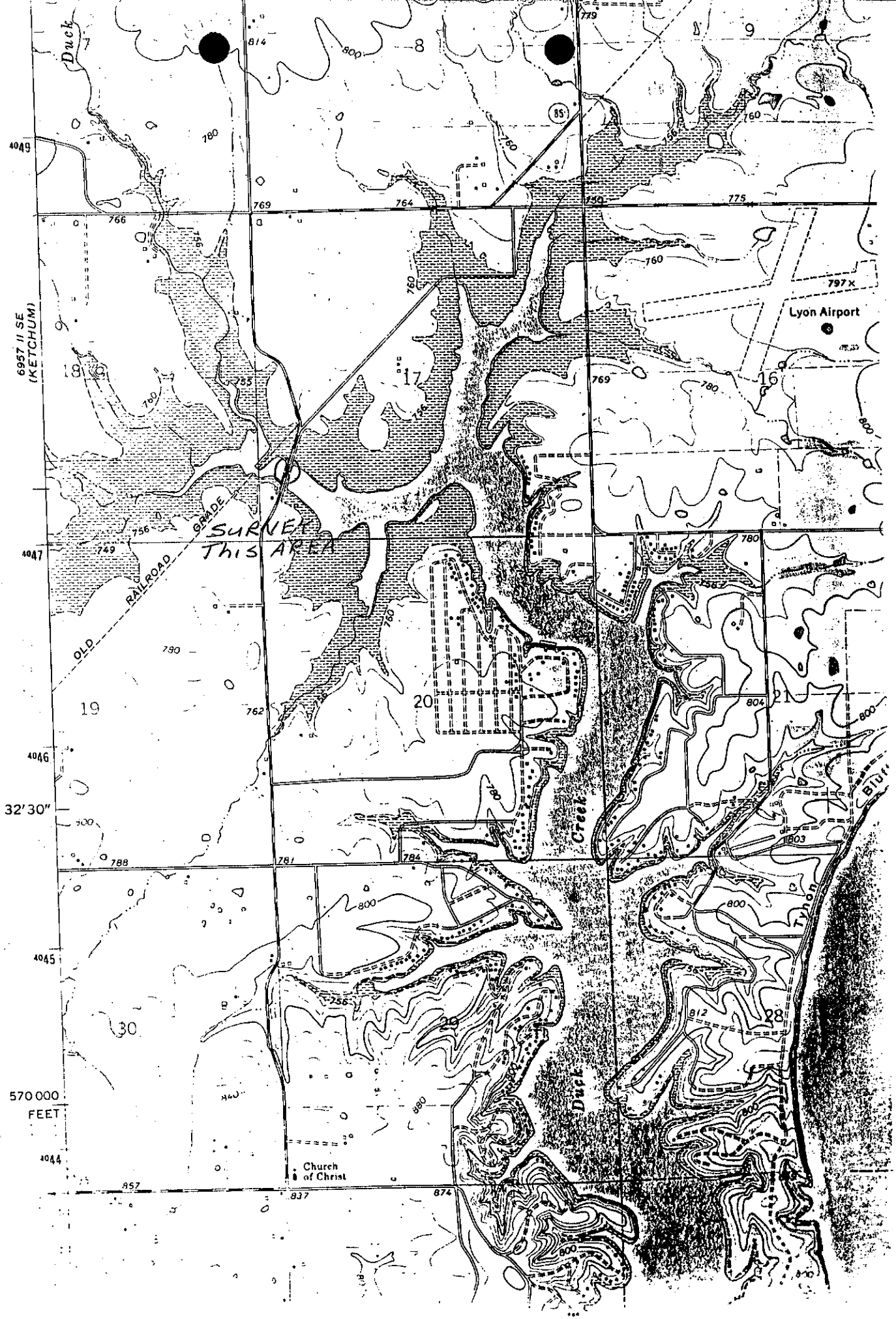

6957 II SE
(KETCHUM)

SURVEY
THIS AREA

OLD
RAILROAD
GRADE

Lyon Airport

Church
of Christ

32'30"

570 000
FEET