

STATE OF OKLAHOMA  
DEPARTMENT OF HIGHWAYS  
PLANS AND SURVEY DEPARTMENT



FLOOD INFORMATION FORM

To be used in obtaining and transmitting flood water elevations for Plans & Survey office record files. This information to be obtained by all Chiefs of Party in their vicinity in times of unusual high water, or at any time available from a reliable source. The elevations can be recorded by level reading, by measurement from bridge floor, in relation to a house, above roadbed or any other dependable, clear manner that fits the situation, the highest order possible to be used. Separate report to be made on each crossing or place obtained.

County Creek Date highwater occurred June 25th, 1958

Highway number US 66 Name of stream Sand Creek

Direction and distance from nearest town, village or store 1/2 Mile North East of Bristow on US 66 Creek County.

Section, Township and Range Section 19 T16N R0E

Description of Location Sand Creek in The S.E. 1/4 of S.E. 1/4 Section 19 T16N R0E at The North East Corner of Bristow Oklahoma.

Method obtained Highwater Obtained From Elevation of B.M. on SWO 2136 (1)

Elevation 795.98 Source of levels USC&GS Level Datum Takened From SWO 2136 (1)

Was highwater mark obtained from actual water, drift, local resident, U. S. Engineers, etc? Highwater Mark Obtained From The Actual Water.

Explanatory Remarks Highwater Elevation Obtained From H. W. Mark inside of The Deep Rock Service Station 215 Ft. Rt. Sta. 45 + 04 on SWO 2136 (1) Alignment. and Placed in Level Book # 1 on SWO 2136 (1).Alignment.

Location to be shown on back of this sheet as a check.

Field Note: To be sent to Engr. of Plans & Survey (1 copy).

Office Note: To be filed in Flood Information by Counties.

*Truett McCarty*  
Truett McCarty  
Chief of Party

June 27th, 1958  
Date

*Location No. 9*

SH # 27  
ORONRIGHT  
46 OKLA

SH # 48  
TO MANFOLD  
OKLA

TURNER  
TRAMPICE  
TO TURNER

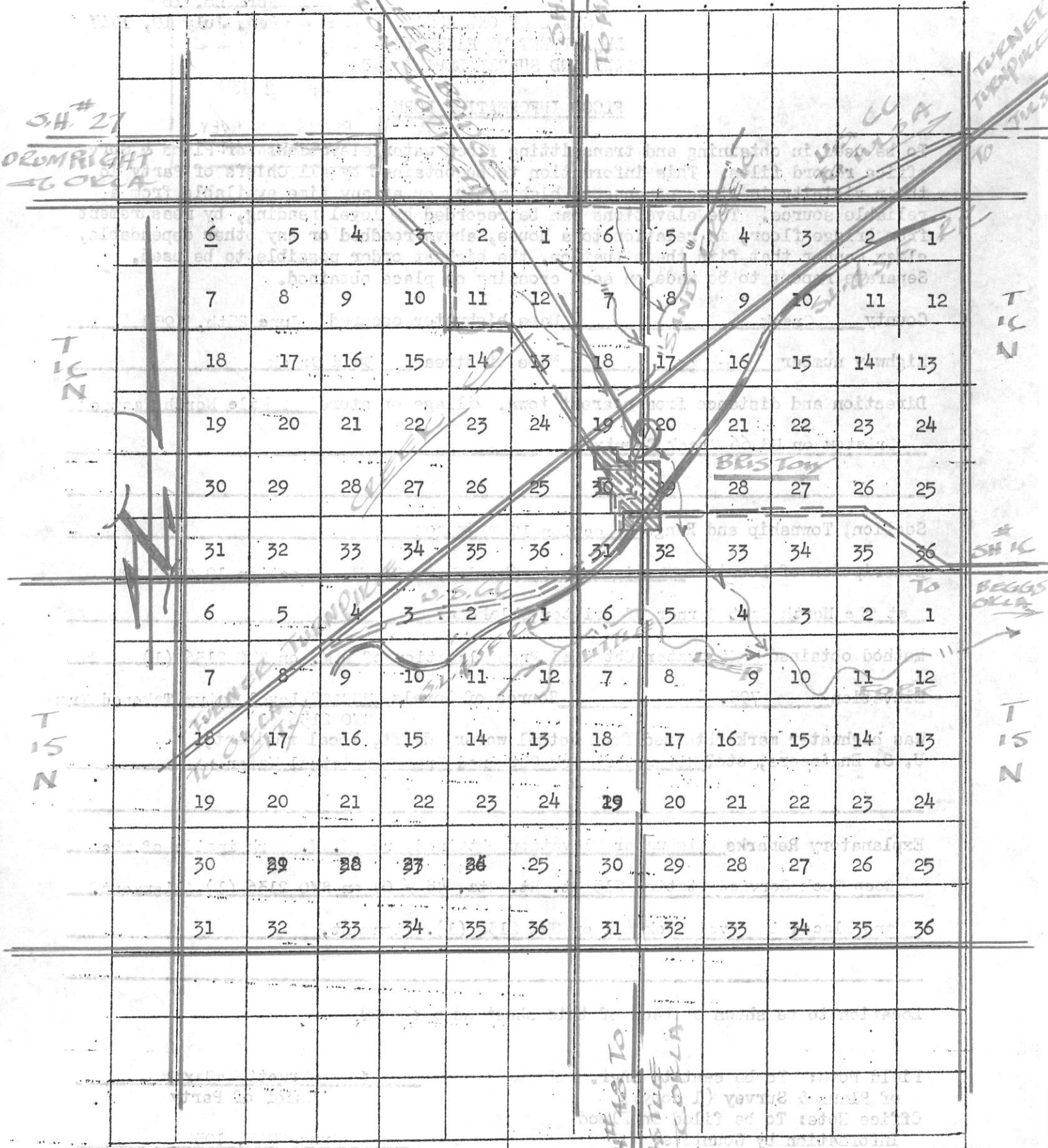

R 8 E

R 9 E

SH # 48 TO  
CASTICE  
OKLA