

STATE OF OKLAHOMA
DEPARTMENT OF HIGHWAYS
SURVEY DIVISION

Survey Division
Form No. 16
Rev. Sept. 10, 1961

FLOOD INFORMATION FORM

To be used in obtaining and transmitting flood water elevations for Survey Division office record files. This information to be obtained by all Chiefs of Party or others in their vicinity in times of unusual high water, or at any time available from a reliable source. The elevations can be recorded by level reading, by measurement from bridge floor, in relation to a house, above roadbed or any other dependable, clear manner that fits the situation, the highest order possible to be used. Separate report to be made on each crossing or place obtained.

County Creek Date highwater occurred May 9, 1993

Highway number E-W 86 Sec. line Name of stream Little Deep Fork

Direction and distance from nearest town, village or store 0.25 miles west of Slick
on EW 86 Sec. Line.

Section, Township and Range Sec. 17, T-15-N, R-10-E

Description of Location Little Deep Fork Creek Bridge 0.25 Miles W. of Slick on EW
86 Sec. line.

Elevation 4.6' below Bridge Floor Source of levels _____

Method obtained Hand Level and Rod Date obtained May 10, 1993

Did it appear to be normal medium extreme do not know

Was highwater mark obtained from actual water, drift, local resident,
U. S. Engineers, etc.? Drift

Explanatory Remarks See Creek County Map, Sheet 1 of 2 Sheets for location of this
point, Shown as Creek County #4.

Location to be shown on back of this sheet as a check.

Field Note: To be sent to
Survey Engineer

Leif H. Higginbotham
Chief of Party

May 11, 1993
Date

LOCATION No. 20

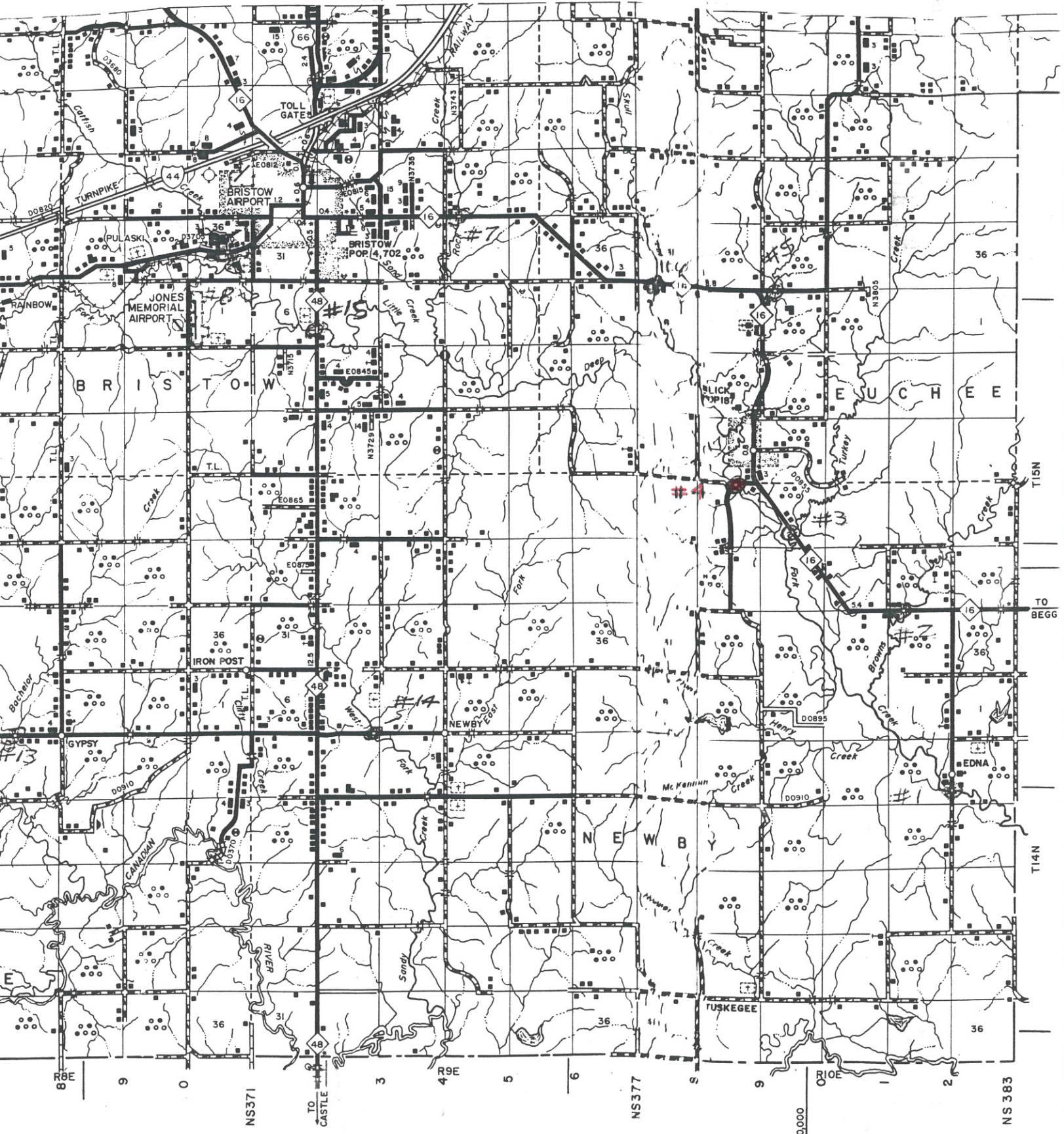

E F C O U N T Y