

STATE OF OKLAHOMA
DEPARTMENT OF HIGHWAYS
SURVEY DIVISION

FLOOD INFORMATION FORM

To be used in obtaining and transmitting flood water elevations for Survey Division office record files. This information to be obtained by all Chiefs of Party or others in their vicinity in times of unusual high water, or at any time available from a reliable source. The elevations can be recorded by level reading, by measurement from bridge floor, in relation to a house, above roadbed or any other dependable, clear manner that fits the situation, the highest order possible to be used. Separate report to be made on each crossing or place obtained.

County Creek Date highwater occurred May 9, 1993

Highway number E-W 66 County Road Name of stream Cimarron River 66 County Road

Direction and distance from nearest town, village or store Approx. 1 mile east of Markham on E-W 66.

Section, Township and Range Sec. 5, T-18-N, R-7-E Sec. 5,

Description of Location Bridge over Cimarron River 1 mile east of Markham on E-W 66.

(NEW BRIDGE)

Elevation 13.2' below W. end br. floor Source of levels 13.2' below W. end br. floor

Method obtained Hand level and rod Date obtained May 10, 1993

Did it appear to be normal medium extreme do not know

Was highwater mark obtained from actual water, drift, local resident, U. S. Engineers, etc.? actual water actual water

Explanatory Remarks See Creek County Map Sheet 2 of 2 sheets for location of this point. Shown as Creek Co. #39.

Location to be shown on back of this sheet as a check.

Field Note: To be sent to
Survey Engineer

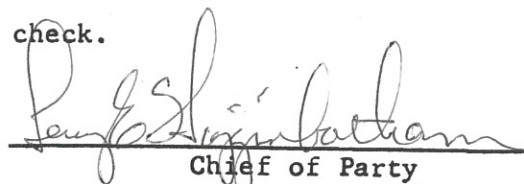
Chief of Party

May 11, 1993
Date

LOCATION No 65

P A W N E E C O U N

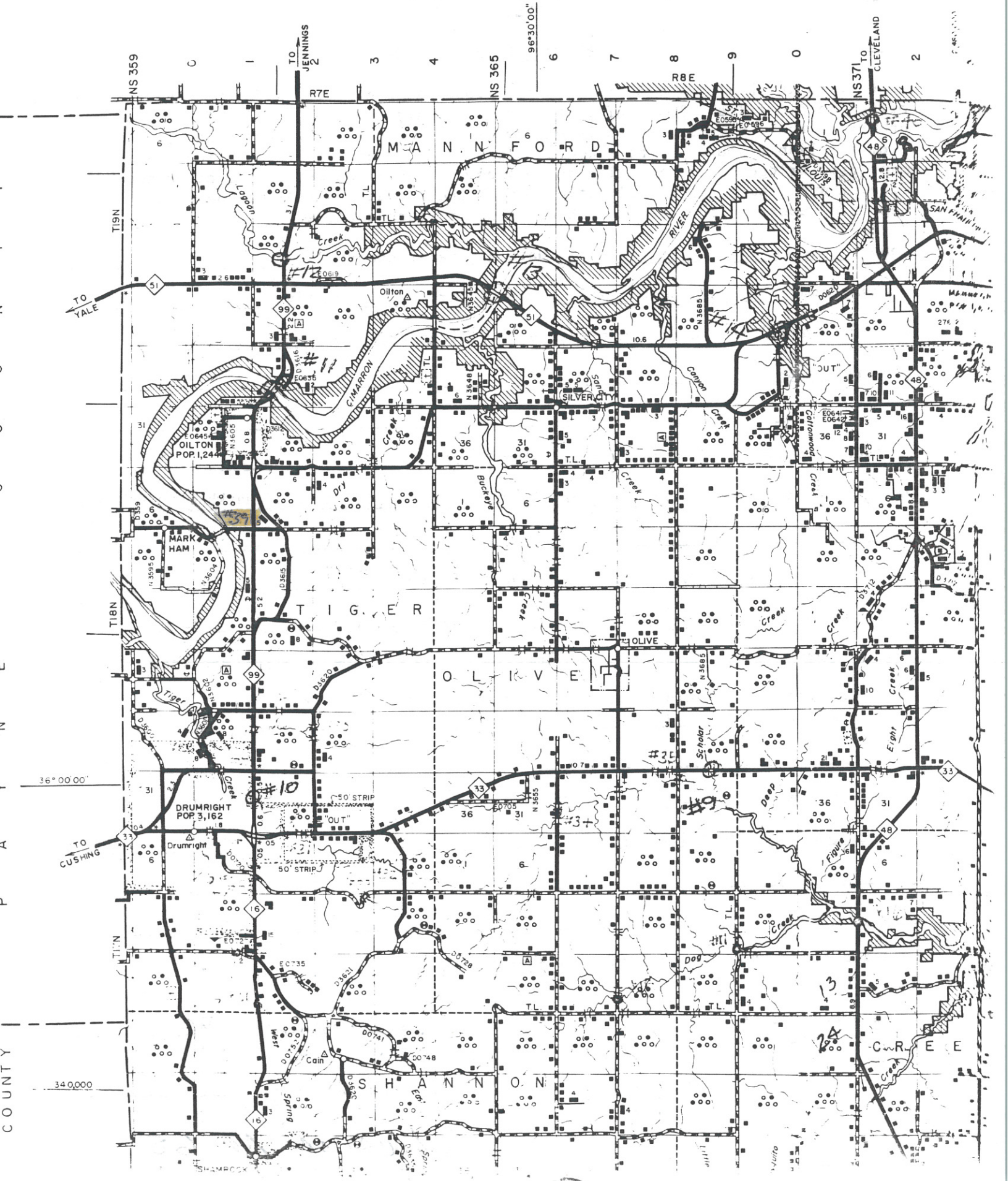

36°00'00"

340,000

COUNTY