

RECEIVED
JUN 14 1957
PLANS & SURVEY
DEPARTMENT

STATE OF OKLAHOMA
DEPARTMENT OF HIGHWAYS
PLANS AND SURVEY DEPARTMENT
FLOOD INFORMATION FORM

Plans & Survey Dept.
Form No. 16
Rev. July 10, 1947

To be used in obtaining and transmitting flood water elevations for Plans & Survey office record files. This information to be obtained by all Chiefs of Party in their vicinity in times of unusual high water, or at any time available from a reliable source. The elevations can be recorded by level reading, by measurement from bridge floor, in relation to a house, above roadbed or any other dependable, clear manner that fits the situation, the highest order possible to be used. Separate report to be made on each crossing or place obtained.

County Craig Date highwater occurred May 25, 1957

Highway number US 66 Name of stream Big Cabin Creek

Direction and distance from nearest town, village or store 1/2 Mile West of Vinita

Section, Township and Range sec. 21 & 28 T25N R20E

Description of Location AT Big Cabin Creek Bridge 1/2 mi. west of Vinita.

Method obtained "Y" Level

Elevation 4.5 Below BM Source of levels BM - Floor at center of Big Cabin Creek bridge on east end.

Was highwater mark obtained from actual water, drift, local resident, U. S. Engineers, etc? actual water --- obtained by J P Andrews Inst. & J. L. Restine Rod.

Explanatory Remarks

Location to be shown on back of this sheet as a check.

Field Note: To be sent to Engr. of Plans & Survey (1 copy).
Office Note: To be filed in Flood Information by Counties.

Red Day Moran
Chief of Party
6/14/57
Date

LOCATION NO VI

8-1-2000 8:00 AM

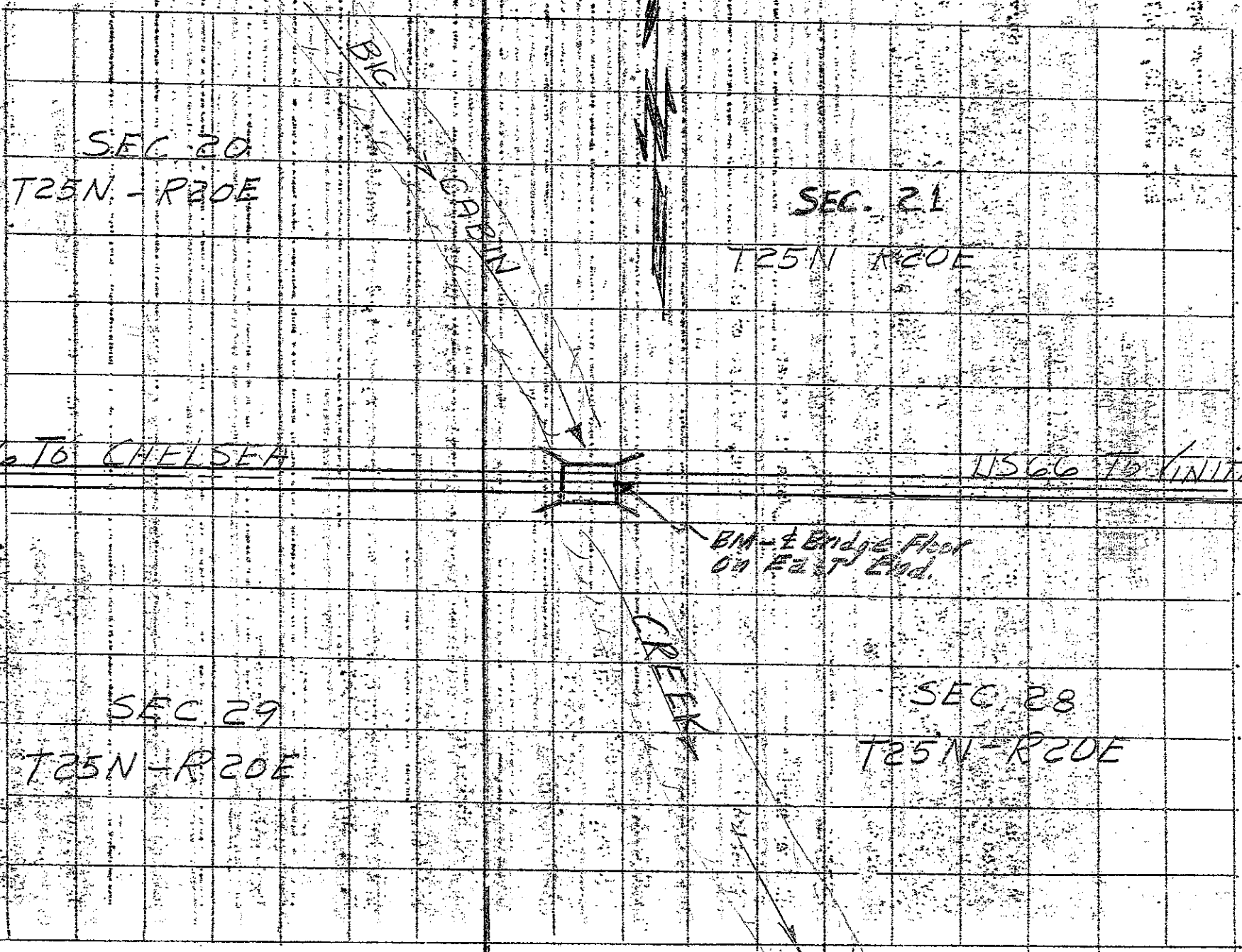

SEC 20

T25N - R20E

SEC 21

T25N - R20E

US 66 TO CHELSEA

US 66 TO KINTA

BM - Bridge Floor
ON EAST END.

SEC 29

T25N - R20E

SEC 28

T25N - R20E

CREEK

BIG