

RECEIVED
JUN 14 1957
PLANS & SURVEY
DEPARTMENT

Plans & Survey Dept.
Form No. 16
Rev. July 10, 1947

STATE OF OKLAHOMA
DEPARTMENT OF HIGHWAYS
PLANS AND SURVEY DEPARTMENT
FLOOD INFORMATION FORM

To be used in obtaining and transmitting flood water elevations for Plans & Survey office record files. This information to be obtained by all Chiefs of Party in their vicinity in times of unusual high water, or at any time available from a reliable source. The elevations can be recorded by level reading, by measurement from bridge floor, in relation to a house, above roadbed or any other dependable, clear manner that fits the situation, the highest order possible to be used. Separate report to be made on each crossing or place obtained.

County Craig Date highwater occurred May 25, 1957

Highway number 66 Name of stream Bull Creek

Direction and distance from nearest town, village or store At Vinita east City Limits

Section, Township and Range Sec. 22 T25N R20E

Description of Location At Bull Creek Bridge

Method obtained "Y" Level

Elevation 690 Below BM Source of levels BM 6 Floor at center of Bull Creek Bridge on east end.

Was highwater mark obtained from actual water, drift, local resident, U. S. Engineers, etc? actual water- obtained by J P Andrews Inst. & J L Restine Rod.

Explanatory Remarks

Location to be shown on back of this sheet as a check.

Field Note: To be sent to Engr. of Plans & Survey (1 copy).
Office Note: To be filed in Flood Information by Counties.

Russ Day Morano
Chief of Party
6/14/57
Date

Location No. 2

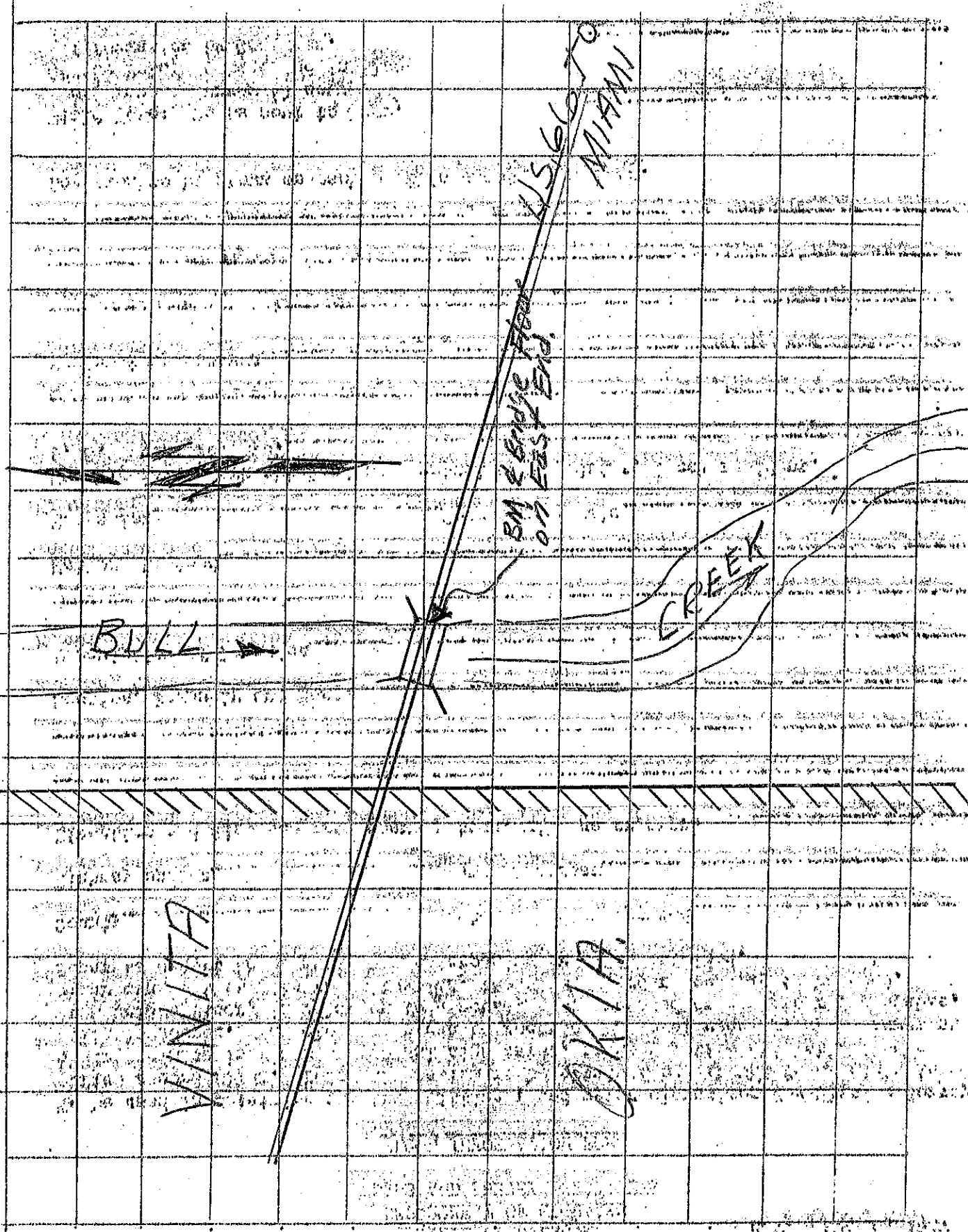

BULL

U.S. 60 TO
MIAMI

BM & BRIDGE FROM
0.7 EAST END

CREEK

VINITA

OKLA.