



OKLAHOMA DEPARTMENT OF TRANSPORTATION
SURVEY DIVISION

FLOOD INFORMATION FORM

Division #:	1 <input type="checkbox"/> 2 <input type="checkbox"/> 3 <input type="checkbox"/> 4 <input type="checkbox"/> 5 <input type="checkbox"/> 6 <input type="checkbox"/> 7 <input checked="" type="checkbox"/> 8 <input type="checkbox"/>
County:	Cotton
Date Highwater occurred:	5/20/2019
Highway Number:	S.H. 5B
Name of Stream:	West Cache Creek
Direction and distance from nearest town, or highway junction	Approx. 1.8 miles North of U.S. 70 and S.H. 5B.
Section, Township, Range:	Section 22 T 4 S , R 11 W
Description of Location:	Pasture and heavy timber. Water crossed over S.H. 5B South of the West Cache Creek Bridge.
Latitude	34°11'59" N
Longitude	98°19'48" W
Highwater Elevation:	913' or Approximately 0.5' over the road.
Level Datum & Source:	NAVD88 (Computed using GEOID12B)
Method used:	GPS-RTK
Date Elevation Obtained:	5/23/2019
Apparent Magnitude:	Normal <input type="checkbox"/> Medium <input checked="" type="checkbox"/> Extreme <input type="checkbox"/> Unknown <input type="checkbox"/>
Was Highwater Mark obtained from actual water, drift, local resident, or other source?	Highwater was obtained from actual drift line on road.
Explanatory Remarks:	Approx. 3" of rain occurred overnight in the upstream area of this location.

Name (Signature) _____

Name (Printed) Lawton Crew

Date 5/23/2019

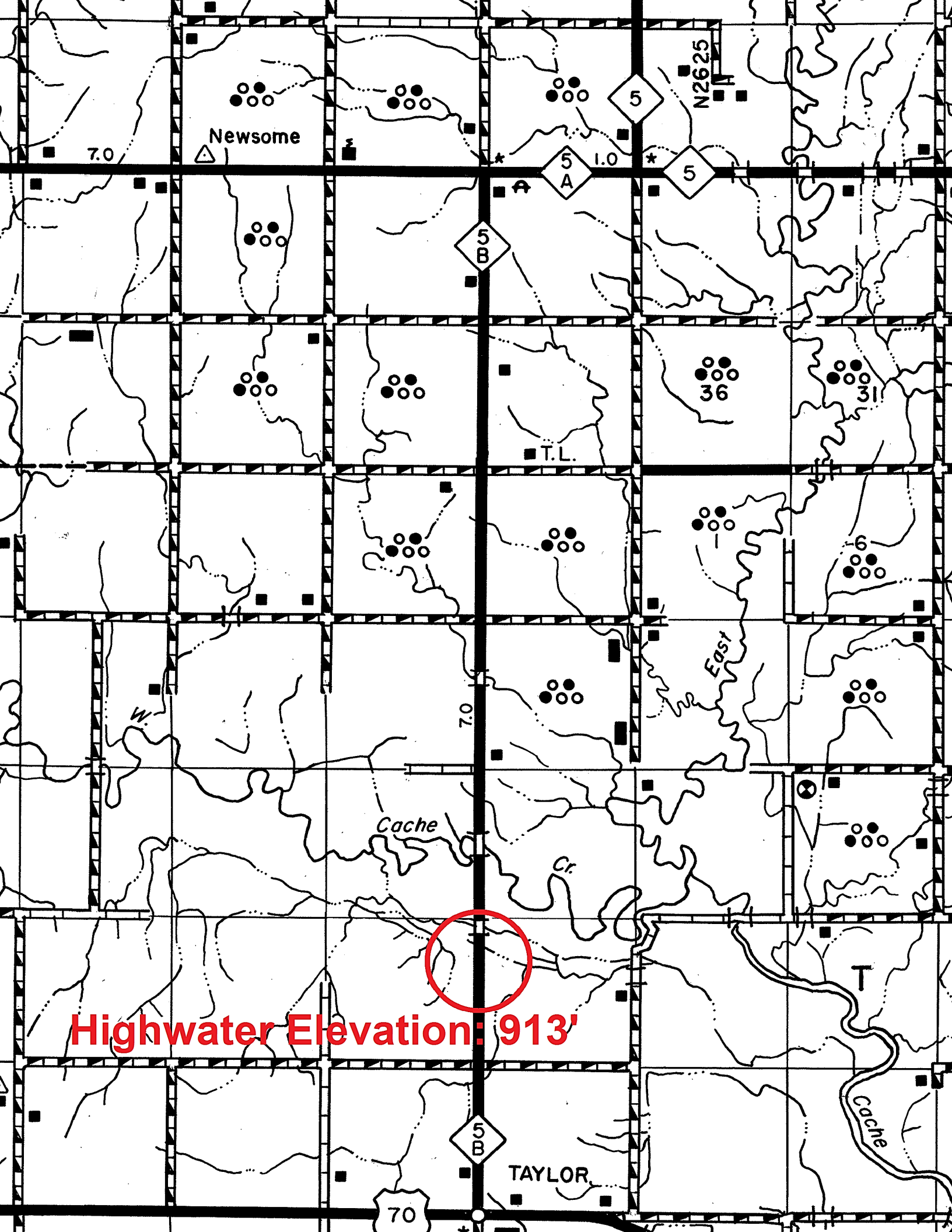

Highwater Elevation: 913'